



PM DC Planetary Gear Motor (Ring Gear Material: Metal and Powder Metal)

**22JXE3K/20ZY32**

Φ22 行星减速器, 允许转矩范围: 0.03N.m~0.3N.m  
22mm OD Planetary Gearbox,  
Permissible Load Range: 0.03N.m~0.3N.m

Ring gear can be selected within the two materials: Powder metal (Type:22JXF3K), Metal (Type:22JXE3K)

● 外形和安装尺寸 Dimensions

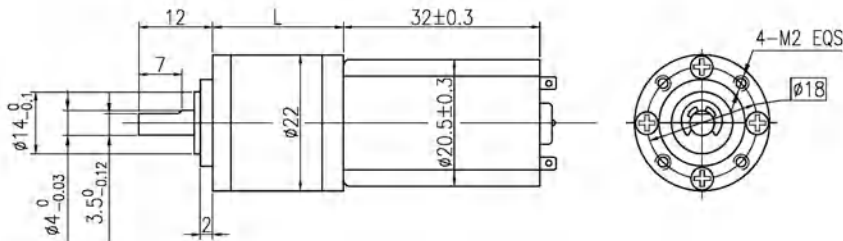

● 电动机主要技术参数 Motor Technical Data

电机型号 TYPE	额定电压 Rated voltage VDC	空载转速 No-load speed r/min	空载电流 No-load current mA	额定转速 Rated speed r/min	额定转矩 Rated torque mN.m	输出功率 Output power W	额定电流 Rated current mA	堵转力矩 Stall torque mN.m	堵转电流 Stall current A
20ZY32-1280	12	8000	70	6700	2.2	1.5	200	13.9	1.07
20ZY32-1295	12	9500	70	7800	2.3	1.9	240	17.5	1.51
20ZY32-2480	24	8000	40	6700	2.3	1.6	110	15.0	0.58

● 齿轮减速电机主要技术参数 Gear Motor Technical Data

配置 20ZY32-1280 直流电机 (20ZY32-1280 DC Motor)

减 速 比 Reduction ratio	4	4.75	16	19	22	64	76	90	107	256	304	364	429	509
减速级数 Number of gear trains	1	1	2	2	2	3	3	3	3	4	4	4	4	4
减速器长度(L) Length(L) mm	14.4	14.4	17.8	17.8	17.8	21.5	21.5	21.5	21.5	25.2	25.2	25.2	25.2	25.2
空载转速 No-load speed r/min	2000	1684	500	421	364	125	105	89	75	31	26	22	19	16
额定转速 Rated speed r/min	1675	1411	419	353	305	105	88	74	63	26	22	18	16	13
额定转矩 Rated torque N.m	0.008	0.009	0.029	0.034	0.039	0.10	0.12	0.14	0.17	0.3	0.3	0.3	0.3	0.3
最大瞬间允许负载 Max. permissible load in a short time N.m	0.09	0.09	0.45	0.45	0.45	0.75	0.75	0.75	0.75	0.75	0.9	0.9	0.9	0.9

配置 20ZY32-1295 直流电机 (20ZY32-1295 DC Motor)

减 速 比 Reduction ratio	4	4.75	16	19	22	64	76	90	107	256	304	364	429	509
减速级数 Number of gear trains	1	1	2	2	2	3	3	3	3	4	4	4	4	4
减速器长度(L) Length(L) mm	14.4	14.4	17.8	17.8	17.8	21.5	21.5	21.5	21.5	25.2	25.2	25.2	25.2	25.2
空载转速 No-load speed r/min	2375	2000	594	500	432	148	125	106	89	37	31	26	22	19
额定转速 Rated speed r/min	1950	1642	488	411	355	122	103	87	78	30	26	21	18	15
额定转矩 Rated torque N.m	0.008	0.010	0.030	0.035	0.041	0.11	0.13	0.15	0.18	0.3	0.3	0.3	0.3	0.3
最大瞬间允许负载 Max. permissible load in a short time N.m	0.09	0.09	0.45	0.45	0.45	0.75	0.75	0.75	0.75	0.75	0.9	0.9	0.9	0.9

配置 20ZY32-2480 直流电机 (20ZY32-2480DC Motor)

减 速 比 Reduction ratio	4	4.75	16	19	22	64	76	90	107	256	304	364	429	509
减速级数 Number of gear trains	1	1	2	2	2	3	3	3	3	4	4	4	4	4
减速器长度(L) Length(L) mm	14.4	14.4	17.8	17.8	17.8	21.5	21.5	21.5	21.5	25.2	25.2	25.2	25.2	25.2
空载转速 No-load speed r/min	2000	1684	500	421	364	125	105	89	75	31	26	22	19	16
额定转速 Rated speed r/min	1675	1411	419	353	305	105	88	74	63	26	22	18	16	13
额定转矩 Rated torque N.m	0.008	0.010	0.030	0.035	0.041	0.11	0.13	0.15	0.18	0.3	0.3	0.3	0.3	0.3
最大瞬间允许负载 Max. permissible load in a short time N.m	0.09	0.09	0.45	0.45	0.45	0.75	0.75	0.75	0.75	0.75	0.9	0.9	0.9	0.9



永磁直行星齿轮电机 (内齿圈材质: 金属和粉末金属)

PM DC Planetary Gear Motor (Ring Gear Material: Metal and Powder Metal)

## 22JXE3K/22ZY38B

Φ22 行星减速器, 允许转矩范围: 0.03N.m~0.3N.m  
22mm OD Planetary Gearbox,  
Permissible Load Range: 0.03N.m~0.3N.m

可在两种材质的内齿圈中进行选择: 粉末金属 (型号 22JXF3K), 金属 (型号 22JXE3K)  
Ring gear can be selected within the two materials: Powder metal (Type: 22JXF3K), Metal (Type: 22JXE3K)

### 外形和安装尺寸 Dimensions

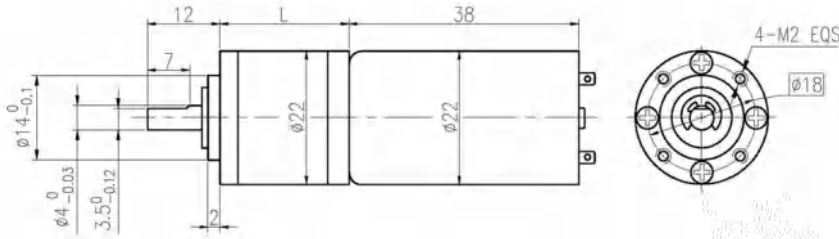

### 电动机主要技术参数 Motor Technical Data

电机型号 TYPE	额定电压 Rated voltage VDC	空载转速 No-load speed r/min	空载电流 No-load current mA	额定转速 Rated speed r/min	额定转矩 Rated torque mN.m	输出功率 Output power W	额定电流 Rated current mA	堵转转矩 Stall torque mN.m	堵转电流 Stall current A
22ZY38B-1230	12	3000	70	2200	3	0.7	135	9.3	0.26
22ZY38B-1260	12	6000	100	5000	3	1.56	250	17	0.87

### 齿轮减速电机主要技术参数 Gear Motor Technical Data

配置 22ZY38B-1230 直流电机 (22ZY38B-1230 DC Motor)

减速比 Reduction ratio	4	4.75	16	19	22	64	76	90	107	256	304
减速级数 Number of gear trains	1	1	2	2	2	3	3	3	3	4	4
减速器长度(L) Length(L) mm	14.4	14.4	17.8	17.8	17.8	21.5	21.5	21.5	21.5	25.2	25.2
空载转速 No-load speed r/min	750	632	188	158	136	47	39	33	28	12	10
额定转速 Rated speed r/min	550	463	138	116	100	34	29	24	21	8.6	7.2
额定转矩 Rated torque N.m	0.011	0.013	0.039	0.046	0.053	0.14	0.17	0.20	0.23	0.3	0.3
最大瞬间允许负载 Max. permissible load in a short time N.m	0.09	0.09	0.45	0.45	0.45	0.75	0.75	0.75	0.75	0.9	0.9

配置 22ZY38B-1260 直流电机 (22ZY38B-1260 DC Motor)

减速比 Reduction ratio	4	4.75	16	19	22	64	76	90	107	256	304
减速级数 Number of gear trains	1	1	2	2	2	3	3	3	3	4	4
减速器长度(L) Length(L) mm	14.4	14.4	17.8	17.8	17.8	21.5	21.5	21.5	21.5	25.2	25.2
空载转速 No-load speed r/min	1500	1263	375	316	273	94	79	67	56	23	20
额定转速 Rated speed r/min	1250	1035	313	263	227	78	66	56	47	20	16
额定转矩 Rated torque N.m	0.011	0.013	0.039	0.046	0.053	0.14	0.17	0.20	0.23	0.3	0.3
最大瞬间允许负载 Max. permissible load in a short time N.m	0.09	0.09	0.45	0.45	0.45	0.75	0.75	0.75	0.75	0.9	0.9

### 电动机特性图 Motor Characteristic Figure

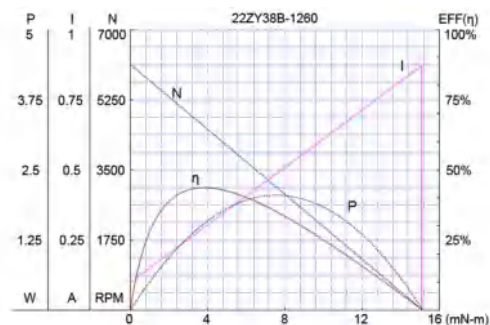
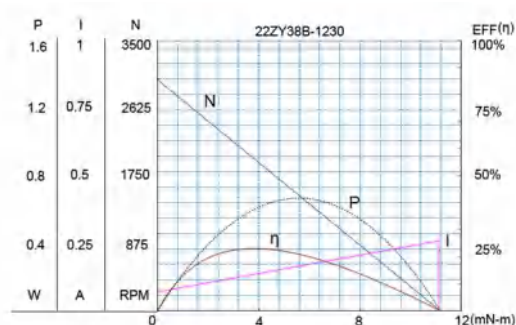



永磁直行星齿轮电机 (内齿圈材质: 金属)

PM DC Planetary Gear Motor (Ring Gear Material: Metal)

*Φ22 行星减速器, 允许转矩范围: 0.05N.m~0.5N.m*

**22JX5K/22ZY38B**

*22mm OD Planetary Gearbox,  
Permissible Load Range: 0.05N.m~0.5N.m*

● 外形和安装尺寸 Dimensions

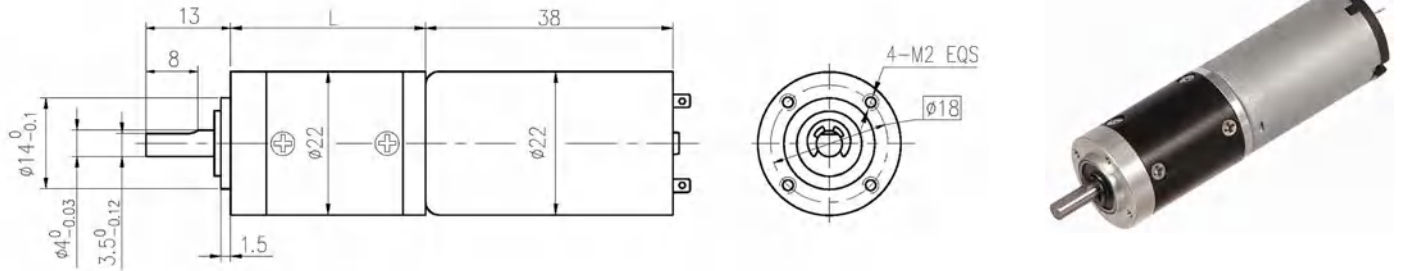

● 电动机主要技术参数 Motor Technical Data

电机型号 TYPE	额定电压 Rated voltage VDC	空载转速 No-load speed r/min	空载电流 No-load current mA	额定转速 Rated speed r/min	额定转矩 Rated torque mN.m	输出功率 Output power W	额定电流 Rated current mA	堵转力矩 Stall torque mN.m	堵转电流 Stall current A
22ZY38B-1245	12	4500	85	3340	3	1.0	180	13.2	0.48
22ZY38B-1260	12	6000	100	5000	3	1.56	250	17	0.87

● 齿轮减速电机主要技术参数 Gear Motor Technical Data

配置 22ZY38B-1245 直流电机 (22ZY38B-1245 DC Motor)

减速比 Reduction ratio	3.7	5.2	14	19	27	51	71	100	139	189	264	369	516
减速级数 Number of gear trains	1	1	2	2	2	3	3	3	3	4	4	4	4
减速器长度(L) Length(L) mm	24.4	24.4	26.8	26.8	26.8	31.7	31.7	31.7	31.7	36.6	36.6	36.6	36.6
空载转速 No-load speed r/min	1213	869	321	237	167	88	63	45	32	24	17	12	8.7
额定转速 Rated speed r/min	900	645	239	176	124	65	47	33	24	18	13	9.1	6.5
额定转矩 Rated torque N.m	0.010	0.014	0.034	0.046	0.066	0.11	0.16	0.22	0.30	0.37	0.5	0.5	0.5
最大瞬间允许负载 Max. permissible load in a short time N.m	0.15	0.15	0.6	0.6	0.6	1.2	1.2	1.2	1.2	1.5	1.5	1.5	1.5

配置 22ZY38B-1260 直流电机 (22ZY38B-1260 DC Motor)

减速比 Reduction ratio	3.7	5.2	14	19	27	51	71	100	139	189	264	369	516
减速级数 Number of gear trains	1	1	2	2	2	3	3	3	3	4	4	4	4
减速器长度(L) Length(L) mm	24.4	24.4	26.8	26.8	26.8	31.7	31.7	31.7	31.7	36.6	36.6	36.6	36.6
空载转速 No-load speed r/min	1617	1158	429	316	222	118	85	60	43	32	23	16	12
额定转速 Rated speed r/min	1348	965	357	263	185	98	70	50	36	26	19	14	9.7
额定转矩 Rated torque N.m	0.010	0.014	0.034	0.046	0.066	0.11	0.16	0.22	0.30	0.37	0.5	0.5	0.5
最大瞬间允许负载 Max. permissible load in a short time N.m	0.15	0.15	0.6	0.6	0.6	1.2	1.2	1.2	1.2	1.5	1.5	1.5	1.5

● 电动机特性图 Motor Characteristic Figure

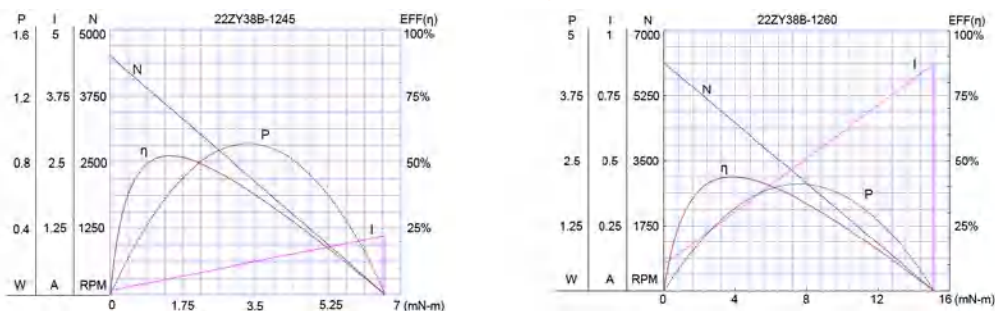

永磁直流行星齿轮电机 (内齿圈材质: 金属)  
PM DC Planetary Gear Motor (Ring Gear Material: Metal)

**22JX10K/22ZY38B** Φ22 行星减速器, 允许转矩范围: 0.1N.m~1.0N.m  
22mm OD Planetary Gearbox,  
Permissible Load Range: 0.1N.m~1.0N.m

● 外形和安装尺寸 Dimensions

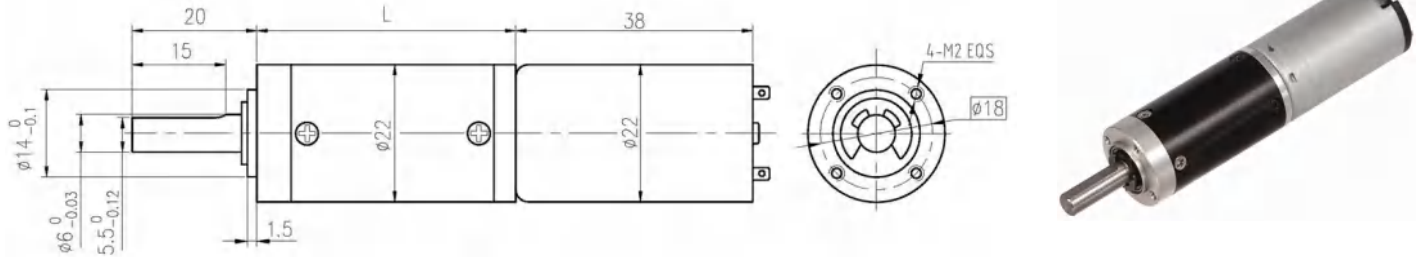

● 电动机主要技术参数 Motor Technical Data

电机型号 TYPE	额定电压 Rated voltage VDC	空载转速 No-load speed r/min	空载电流 No-load current mA	额定转速 Rated speed r/min	额定转矩 Rated torque mN.m	输出功率 Output power W	额定电流 Rated current mA	堵转力矩 Stall torque mN.m	堵转电流 Stall current A
22ZY38B-1260	12	6000	100	5000	3	1.56	250	17	0.87
22ZY38B-12100	12	10000	150	8700	3	2.7	500	28	2.3

● 齿轮减速电机主要技术参数 Gear Motor Technical Data

配置 22ZY38B-1260 直流电机 (22ZY38B-1260 DC Motor)

减速比 Reduction ratio	3.7	5.2	14	19	27	51	71	100	139	189	264	369	516
减速级数 Number of gear trains	1	1	2	2	2	3	3	3	3	4	4	4	4
减速器长度(L) Length(L) mm	24.4	24.4	33.0	33.0	33.0	41.5	41.5	41.5	41.5	49.8	49.8	49.8	49.8
空载转速 No-load speed r/min	1617	1158	429	316	222	118	85	60	43	32	23	16	12
额定转速 Rated speed r/min	1388	994	357	263	185	98	70	50	36	26	19	14	9.7
额定转矩 Rated torque N.m	0.010	0.014	0.034	0.046	0.066	0.11	0.16	0.22	0.30	0.37	0.51	0.72	1.0
最大瞬间允许负载 Max. permissible load in a short time N.m	0.3	0.3	1.2	1.2	1.2	2.5	2.5	2.5	2.5	3	3	3	3

配置 22ZY38B-12100 直流电机 (22ZY38B-12100 DC Motor)

减速比 Reduction ratio	3.7	5.2	14	19	27	51	71	100	139	189	264	369	516
减速级数 Number of gear trains	1	1	2	2	2	3	3	3	3	4	4	4	4
减速器长度(L) Length(L) mm	24.4	24.4	33.0	33.0	33.0	41.5	41.5	41.5	41.5	49.8	49.8	49.8	49.8
空载转速 No-load speed r/min	2695	1931	714	526	370	196	141	100	72	53	38	27	19
额定转速 Rated speed r/min	2480	1776	621	458	322	171	123	87	63	46	33	24	17
额定转矩 Rated torque N.m	0.010	0.014	0.034	0.046	0.066	0.11	0.16	0.22	0.30	0.37	0.51	0.72	1.0
最大瞬间允许负载 Max. permissible load in a short time N.m	0.3	0.3	1.2	1.2	1.2	2.5	2.5	2.5	2.5	3	3	3	3

● 电动机特性图 Motor Characteristic Figure

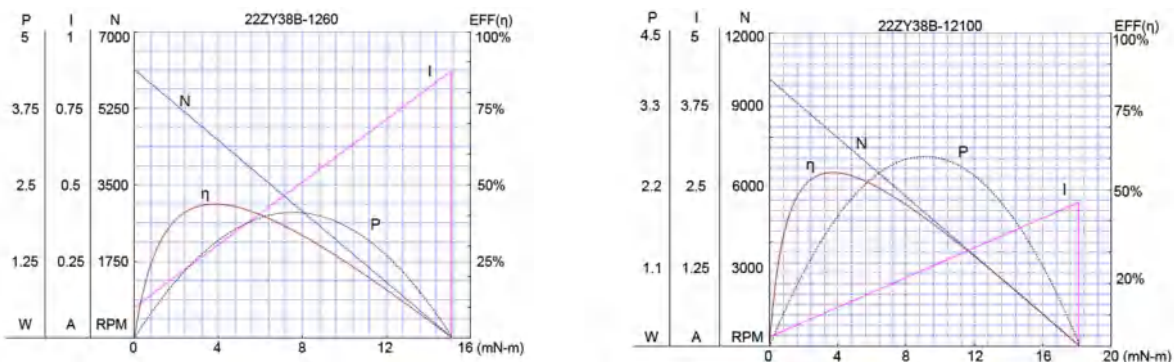





PM DC Planetary Gear Motor (Ring Gear Material: Metal)

## 22JN10K/22ZY38

Φ22 行星减速器, 允许转矩范围: 0.1N.m~1.0N.m  
22mm OD Planetary Gearbox,  
Permissible Load Range: 0.1N.m~1.0N.m

### ● 外形和安装尺寸 Dimensions

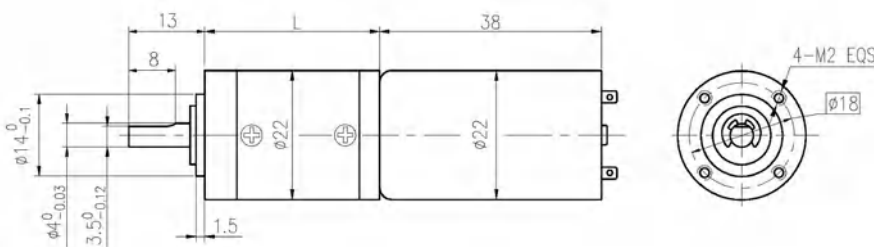

### ● 电动机主要技术参数 Motor Technical Data

电机型号 TYPE	额定电压 Rated voltage VDC	空载转速 No-load speed r/min	空载电流 No-load current mA	额定转速 Rated speed r/min	额定转矩 Rated torque mN.m	输出功率 Output power W	额定电流 Rated current mA	堵转力矩 Stall torque mN.m	堵转电流 Stall current A
22ZY38B-1245	12	4500	85	3340	3	1.0	180	13.2	0.48
22ZY38B-1260	12	6000	100	5000	3	1.56	250	17	0.87
22ZY38B-12100	12	10000	150	8700	3	2.7	500	28	2.3

### ● 齿轮减速电机主要技术参数 Gear Motor Technical Data

配置 22ZY38B-1245 直流电机 (22ZY38B-1245 DC Motor)

减 速 比 Reduction ratio	3.7	5.2	14	19	27	51	71	100	139	189	264	369	516	720
减 速 级 数 Number of gear trains	1	1	2	2	2	3	3	3	3	4	4	4	4	4
减 速 器 长 度 (L) Length(L) mm	24.4	24.4	31.0	31.0	31.0	37.4	37.4	37.4	37.4	43.8	43.8	43.8	43.8	43.8
空 载 转 速 No-load speed r/min	1213	869	321	237	167	88	63	45	32	24	17	12	8.7	6.2
额 定 转 速 Rated speed r/min	900	645	239	176	124	65	47	33	24	18	13	9.1	6.5	4.6
额 定 转 矩 Rated torque N.m	0.010	0.014	0.034	0.046	0.066	0.11	0.16	0.22	0.30	0.37	0.51	0.72	1	1
最 大 瞬 间 允 许 负 载 Max. permissible load in a short time N.m	0.3	0.3	1.2	1.2	1.2	2.5	2.5	2.5	2.5	3	3	3	3	3

配置 22ZY38B-1260 直流电机 (22ZY38B-1260 DC Motor)

减 速 比 Reduction ratio	3.7	5.2	14	19	27	51	71	100	139	189	264	369	516	720
减 速 级 数 Number of gear trains	1	1	2	2	2	3	3	3	3	4	4	4	4	4
减 速 器 长 度 (L) Length(L) mm	24.4	24.4	31.0	31.0	31.0	37.4	37.4	37.4	37.4	43.8	43.8	43.8	43.8	43.8
空 载 转 速 No-load speed r/min	1617	1158	429	316	222	118	85	60	43	32	23	16	12	8.3
额 定 转 速 Rated speed r/min	1348	965	357	263	185	98	70	50	36	26	19	14	9.7	6.9
额 定 转 矩 Rated torque N.m	0.010	0.014	0.034	0.046	0.066	0.11	0.16	0.22	0.30	0.37	0.51	0.72	1	1
最 大 瞬 间 允 许 负 载 Max. permissible load in a short time N.m	0.3	0.3	1.2	1.2	1.2	2.5	2.5	2.5	2.5	3	3	3	3	3

配置 22ZY38B-12100 直流电机 (22ZY38B-12100 DC Motor)

减 速 比 Reduction ratio	3.7	5.2	14	19	27	51	71	100	139	189	264	369	516	720
减 速 级 数 Number of gear trains	1	1	2	2	2	3	3	3	3	4	4	4	4	4
减 速 器 长 度 (L) Length(L) mm	24.4	24.4	31.0	31.0	31.0	37.4	37.4	37.4	37.4	43.8	43.8	43.8	43.8	43.8
空 载 转 速 No-load speed r/min	2695	1931	714	526	370	196	141	100	72	53	38	27	19	14
额 定 转 速 Rated speed r/min	2480	1776	621	458	322	171	123	87	63	46	33	24	17	12
额 定 转 矩 Rated torque N.m	0.010	0.014	0.034	0.046	0.066	0.11	0.16	0.22	0.30	0.37	0.51	0.72	1	1
最 大 瞬 间 允 许 负 载 Max. permissible load in a short time N.m	0.3	0.3	1.2	1.2	1.2	2.5	2.5	2.5	2.5	3	3	3	3	3



永磁直行星齿轮电机 (内齿圈材质: 金属和粉末金属)

PM DC Planetary Gear Motor (Ring Gear Material: Metal and Powder Metal)

28JXE5K/28ZY38

 $\Phi 28$  行星减速器, 允许转矩范围: 0.05N.m~0.5N.m  
 28mm OD Planetary Gearbox,  
 Permissible Load Range: 0.05N.m~0.5N.m

可在两种材质的内齿圈中进行选择: 粉末金属 (型号 28JXF5K), 金属 (型号 28JXE5K)  
 Ring gear can be selected within the two materials: Powder metal (Type: 28JXF5K), Metal (Type: 28JXE5K)

● 外形和安装尺寸 Dimensions

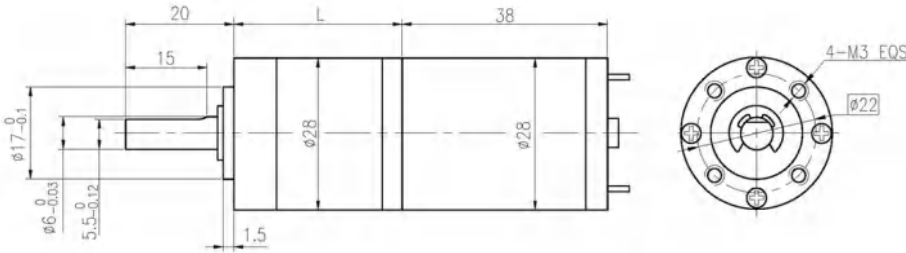

● 电动机主要技术参数 Motor Technical Data

电机型号 TYPE	额定电压 Rated voltage VDC	空载转速 No-load speed r/min	空载电流 No-load current mA	额定转速 Rated speed r/min	额定转矩 Rated torque mN.m	输出功率 Output power W	额定电流 Rated current mA	堵转力矩 Stall torque mN.m	堵转电流 Stall current A
28ZY38-1240	12	4000	80	2600	7	1.86	350	20	0.75
28ZY38-1250	12	5000	100	3450	7	2.48	370	21.5	0.9

● 齿轮减速电机主要技术参数 Gear Motor Technical Data

配置 28ZY38-1240 直流电机 (28ZY38-1240 DC Motor)

减速比	Reduction ratio	3.7	5.2	14	19	27	51	71	100	139	189
减速级数	Number of gear trains	1	1	2	2	2	3	3	3	3	4
减速器长度(L)	Length(L) mm	23.5	23.5	26.5	26.5	26.5	31.8	31.8	31.8	31.8	37.0
空载转速	No-load speed r/min	1078	772	286	211	148	78	56	40	29	21
额定转速	Rated speed r/min	701	502	186	137	96	51	37	26	19	14
额定转矩	Rated torque N.m	0.023	0.033	0.079	0.11	0.15	0.26	0.36	0.5	0.5	0.5
最大瞬间允许负载	Max. permissible load in a short time N.m	0.15	0.15	0.6	0.6	0.6	1.2	1.2	1.2	1.2	1.5

配置 28ZY38-1250 直流电机 (28ZY38-1250 DC Motor)

减速比	Reduction ratio	3.7	5.2	14	19	27	51	71	100	139	189
减速级数	Number of gear trains	1	1	2	2	2	3	3	3	3	4
减速器长度(L)	Length(L) mm	23.5	23.5	26.5	26.5	26.5	31.8	31.8	31.8	31.8	37.0
空载转速	No-load speed r/min	1348	965	357	263	185	98	70	50	36	26
额定转速	Rated speed r/min	930	666	246	182	128	68	49	35	25	18
额定转矩	Rated torque N.m	0.023	0.033	0.079	0.11	0.15	0.26	0.36	0.5	0.5	0.5
最大瞬间允许负载	Max. permissible load in a short time N.m	0.15	0.15	0.6	0.6	0.6	1.2	1.2	1.2	1.2	1.5

● 电动机特性图 Motor Characteristic Figure

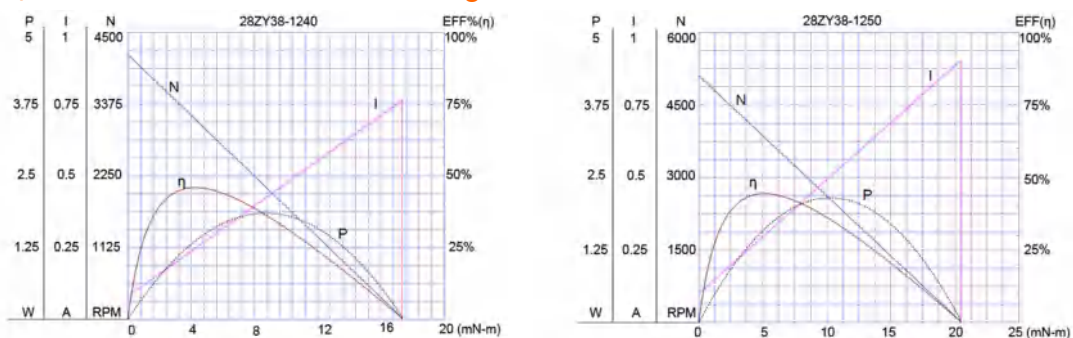

永磁直行星齿轮电机 (内齿圈材质: 金属和粉末金属)

PM DC Planetary Gear Motor (Ring Gear Material: Metal and Powder Metal)

**28JXE10K/28ZY47**

Φ28 行星减速器, 允许转矩范围: 0.1N.m~1.0N.m  
28mm OD Planetary Gearbox,  
Permissible Load Range: 0.1N.m~1.0N.m

可在两种材质的内齿圈中进行选择: 粉末金属 (型号 28JXF10K), 金属 (型号 28JXE10K)  
Ring gear can be selected within the two materials: Powder metal (Type: 28JXF10K), Metal (Type: 28JXE10K)

● 外形和安装尺寸 Dimensions

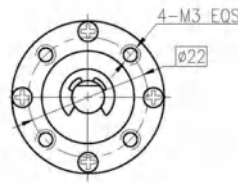
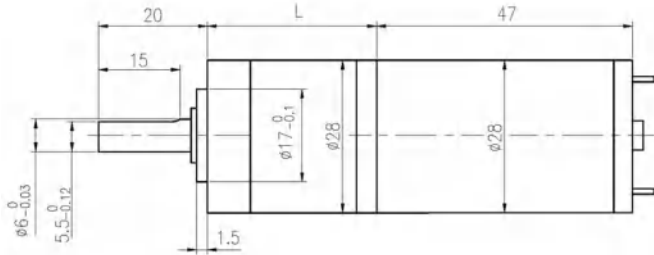

● 电动机主要技术参数 Motor Technical Data

电机型号 TYPE	额定电压 Rated voltage VDC	空载转速 No-load speed r/min	空载电流 No-load current mA	额定转速 Rated speed r/min	额定转矩 Rated torque mN.m	输出功率 Output power W	额定电流 Rated current mA	堵转力矩 Stall torque mN.m	堵转电流 Stall current A
28ZY47-2445	24	5000	80	3800	7	2.8	230	25	0.7
28ZY47-2467	24	6700	100	5100	15	8.0	460	55	1.8

● 齿轮减速电机主要技术参数 Gear Motor Technical Data

配置 28ZY47-2445 直流电机 (28ZY47-2445 DC Motor)

减速比 Reduction ratio	3.7	5.2	14	19	27	51	71	100	139
减速级数 Number of gear trains	1	1	2	2	2	3	3	3	3
减速器长度(L) Length(L) mm	23.5	23.5	32.0	32.0	32.0	40.3	40.3	40.3	40.3
空载转速 No-load speed r/min	1348	965	357	263	185	98	70	50	36
额定转速 Rated speed r/min	1024	734	271	200	141	75	54	38	27
额定转矩 Rated torque N.m	0.02	0.03	0.08	0.11	0.15	0.26	0.36	0.51	0.71
最大瞬间允许负载 Max. permissible load in a short time N.m	0.3	0.3	1.2	1.2	1.2	2.5	2.5	2.5	2.5

配置 28ZY47-2467 直流电机 (28ZY47-2467 DC Motor)

减速比 Reduction ratio	3.7	5.2	14	19	27	51	71	100	139
减速级数 Number of gear trains	1	1	2	2	2	3	3	3	3
减速器长度(L) Length(L) mm	23.5	23.5	32.0	32.0	32.0	40.3	40.3	40.3	40.3
空载转速 No-load speed r/min	1806	1293	479	353	248	131	94	67	48
额定转速 Rated speed r/min	1375	985	364	268	189	100	72	51	37
额定转矩 Rated torque N.m	0.05	0.07	0.17	0.23	0.33	0.56	0.78	1.1	1.5
最大瞬间允许负载 Max. permissible load in a short time N.m	0.3	0.3	1.2	1.2	1.2	2.5	2.5	2.5	2.5

● 电动机特性图 Motor Characteristic Figure

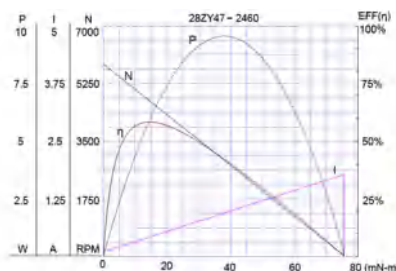
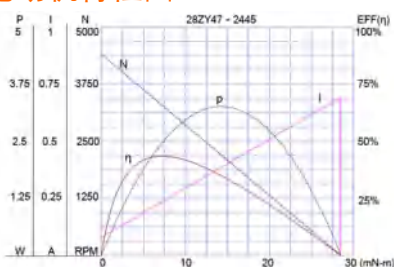





PM DC Planetary Gear Motor (Ring Gear Material: Metal and Powder Metal)

**28JN10K/28ZY38**  $\Phi 28$  行星减速器, 允许转矩范围: 0.1N.m~1.0N.m  
28mm OD Planetary Gearbox,  
Permissible Load Range: 0.1N.m~1.0N.m

Ring gear can be selected within the two materials: Powder metal (Type: 28JMF10K), Metal (Type: 28JM10K)

● 外形和安装尺寸 Dimensions

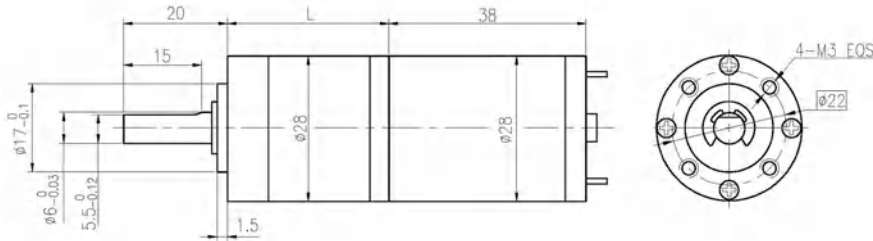

● 电动机主要技术参数 Motor Technical Data

电机型号 TYPE	额定电压 Rated voltage VDC	空载转速 No-load speed r/min	空载电流 No-load current mA	额定转速 Rated speed r/min	额定转矩 Rated torque mN.m	输出功率 Output power W	额定电流 Rated current mA	堵转力矩 Stall torque mN.m	堵转电流 Stall current A
28ZY38-1240	12	4000	80	2600	7.0	1.86	350	20	0.75
28ZY38-1250	12	5000	100	3450	7.0	2.48	370	21.5	0.90
28ZY38-2450	24	5000	60	4000	6.9	2.87	200	22	0.60

● 齿轮减速电机主要技术参数 Gear Motor Technical Data

配置 28ZY38-1240 直流电机 (28ZY38-1240 DC Motor)

减速比 Reduction ratio	3.7	5.2	14	19	27	51	71	100	139	189	264	369
减速级数 Number of gear trains	1	1	2	2	2	3	3	3	3	4	4	4
减速器长度(L) Length(L) mm	22.6	22.6	29.2	29.2	29.2	35.6	35.6	35.6	35.6	42.0	42.0	42.0
空载转速 No-load speed r/min	1078	772	286	211	148	78	56	40	29	21	15	11
额定转速 Rated speed r/min	701	502	186	137	96	51	37	26	19	14	10	7
额定转矩 Rated torque N.m	0.023	0.033	0.079	0.11	0.15	0.26	0.36	0.51	0.71	0.86	1	1
最大瞬间允许负载 Max. permissible load in a short time N.m	0.3	0.3	1.2	1.2	1.2	2.4	2.4	2.4	2.4	3	3	3

配置 28ZY38-1250 直流电机 (28ZY38-1250 DC Motor)

减速比 Reduction ratio	3.7	5.2	14	19	27	51	71	100	139	189	264	369
减速级数 Number of gear trains	1	1	2	2	2	3	3	3	3	4	4	4
减速器长度(L) Length(L) mm	22.6	22.6	29.2	29.2	29.2	35.6	35.6	35.6	35.6	42.0	42.0	42.0
空载转速 No-load speed r/min	1348	965	357	263	185	98	70	50	36	26	19	14
额定转速 Rated speed r/min	930	666	246	182	128	68	49	35	25	18	13	9.3
额定转矩 Rated torque N.m	0.023	0.033	0.079	0.11	0.15	0.26	0.36	0.51	0.71	0.86	1	1
最大瞬间允许负载 Max. permissible load in a short time N.m	0.3	0.3	1.2	1.2	1.2	2.4	2.4	2.4	2.4	3	3	3

配置 28ZY38-2450 直流电机 (28ZY38-2450 DC Motor)

减速比 Reduction ratio	3.7	5.2	14	19	27	51	71	100	139	189	264	369
减速级数 Number of gear trains	1	1	2	2	2	3	3	3	3	4	4	4
减速器长度(L) Length(L) mm	22.6	22.6	29.2	29.2	29.2	35.6	35.6	35.6	35.6	42.0	42.0	42.0
空载转速 No-load speed r/min	1348	965	357	263	185	98	70	50	36	26	19	14
额定转速 Rated speed r/min	1078	772	286	211	148	78	56	40	29	21	15	11
额定转矩 Rated torque N.m	0.023	0.032	0.078	0.11	0.15	0.26	0.36	0.50	0.70	0.85	1	1
最大瞬间允许负载 Max. permissible load in a short time N.m	0.3	0.3	1.2	1.2	1.2	2.4	2.4	2.4	2.4	3	3	3

永磁直流行星齿轮电机 (内齿圈材质: 金属)

PM DC Planetary Gear Motor (Ring Gear Material: Metal)

Φ28 行星减速器, 允许转矩范围: 0.3N.m~3.0N.m

28JXB30K/28ZY47

28mm OD Planetary Gearbox,  
Permissible Load Range: 0.3N.m~3.0N.m

● 外形和安装尺寸 Dimensions

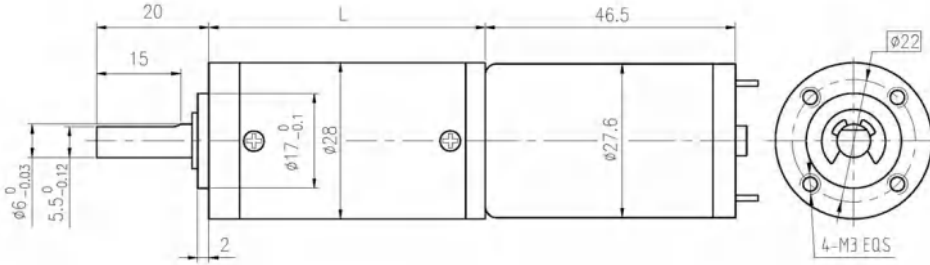

● 电动机主要技术参数 Motor Technical Data

电机型号 TYPE	额定电压 Rated voltage VDC	空载转速 No-load speed r/min	空载电流 No-load current mA	额定转速 Rated speed r/min	额定转矩 Rated torque mN.m	输出功率 Output power W	额定电流 Rated current mA	堵转力矩 Stall torque mN.m	堵转电流 Stall current A
28ZY47-2450	24	5000	80	3800	7	2.8	230	25	0.7
28ZY47-2467	24	6700	100	5100	15	8.0	460	55	1.8

● 齿轮减速电机主要技术参数 Gear Motor Technical Data

配置 28ZY47-2450 直流电机 (28ZY47-2450 DC Motor)

减速比 Reduction ratio	3.7	5.2	14	19	27	51	71	100	139	189	264	369	516	720
减速级数 Number of gear trains	1	1	2	2	2	3	3	3	3	4	4	4	4	4
减速器长度(L) Length(L) mm	31.0	31.0	40.1	40.1	40.1	49.0	49.0	49.0	49.0	57.9	57.9	57.9	57.9	57.9
空载转速 No-load speed r/min	1348	965	357	263	185	98	70	50	36	26	19	14	9.7	6.9
额定转速 Rated speed r/min	1024	734	271	200	141	75	54	38	27	20	14	10	7.4	5.3
额定转矩 Rated torque N.m	0.02	0.03	0.08	0.11	0.15	0.26	0.36	0.51	0.71	0.86	1.2	1.7	2.4	3
最大瞬间允许负载 Max. permissible load in a short time N.m	1.0	1.0	3.5	3.5	3.5	7.5	7.5	7.5	7.5	9	9	9	9	9

配置 28ZY47-2467 直流电机 (28ZY47-2467 DC Motor)

减速比 Reduction ratio	3.7	5.2	14	19	27	51	71	100	139	189	264	369	516
减速级数 Number of gear trains	1	1	2	2	2	3	3	3	3	4	4	4	4
减速器长度(L) Length(L) mm	31.0	31.0	40.1	40.1	40.1	49.0	49.0	49.0	49.0	57.9	57.9	57.9	57.9
空载转速 No-load speed r/min	1806	1293	479	353	248	131	94	67	48	35	25	18	13
额定转速 Rated speed r/min	1375	985	364	268	189	100	72	51	37	27	19	14	9.9
额定转矩 Rated torque N.m	0.05	0.07	0.17	0.23	0.33	0.56	0.78	1.1	1.5	1.8	2.6	3	3
最大瞬间允许负载 Max. permissible load in a short time N.m	1.0	1.0	3.5	3.5	3.5	7.5	7.5	7.5	7.5	9	9	9	9

● 电动机特性图 Motor Characteristic Figure

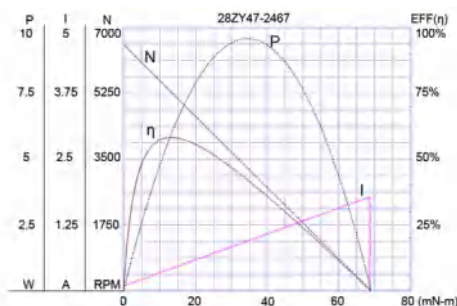
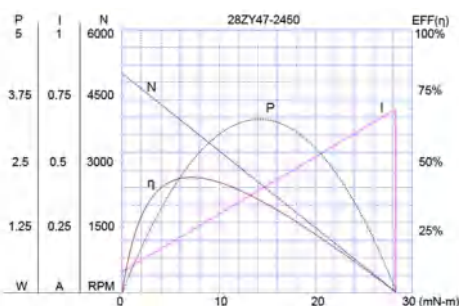



PM DC Planetary Gear Motor (Ring Gear Material: Metal)

**28JN30K/28ZY38**

Φ28 行星减速器, 允许转矩范围: 0.3N.m~3.0N.m  
28mm OD Planetary Gearbox,  
Permissible Load Range: 0.3N.m~3.0N.m

● 外形和安装尺寸 Dimensions

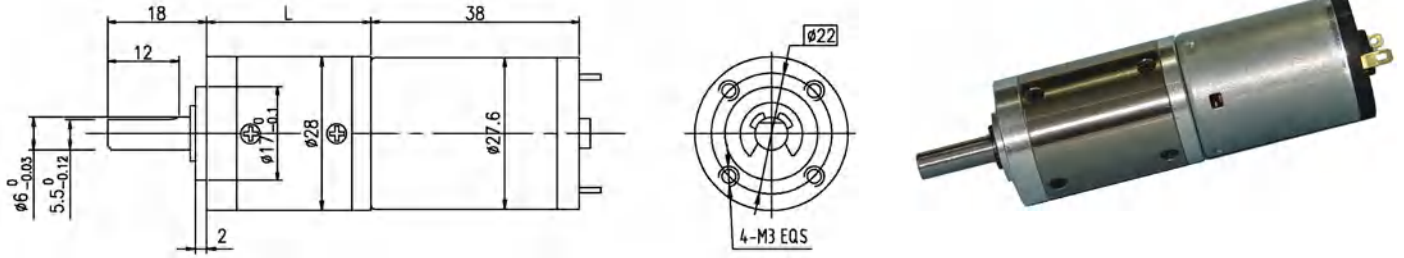

● 电动机主要技术参数 Motor Technical Data

电机型号 TYPE	额定电压 Rated voltage VDC	空载转速 No-load speed r/min	空载电流 No-load current mA	额定转速 Rated speed r/min	额定转矩 Rated torque mN.m	输出功率 Output power W	额定电流 Rated current mA	堵转力矩 Stall torque mN.m	堵转电流 Stall current A
28ZY38-1240	12	4000	80	2600	7	1.86	350	20	0.75
28ZY38-1250	12	5000	100	3450	7	2.48	370	21.5	0.90
28ZY38-2450	24	5000	70	3800	7	2.78	230	25	0.70

● 齿轮减速电机主要技术参数 Gear Motor Technical Data

配置 28ZY38-1240 直流电机 (28ZY38-1240 DC Motor)

减速比 Reduction ratio	3.7	5.2	14	19	27	51	71	100	139	189	264	369	516	720
减速级数 Number of gear trains	1	1	2	2	2	3	3	3	3	4	4	4	4	4
减速器长度(L) Length(L) mm	29.0	29.0	36.1	36.1	36.1	43.0	43.0	43.0	43.0	49.9	49.9	49.9	49.9	49.9
空载转速 No-load speed r/min	1078	772	286	211	148	78	56	40	29	21	15	11	7.8	5.6
额定转速 Rated speed r/min	701	502	186	137	96	51	37	26	19	14	9.8	7.0	5.0	3.6
额定转矩 Rated torque N.m	0.023	0.033	0.079	0.11	0.15	0.26	0.36	0.51	0.71	0.86	1.2	1.7	2.4	3.6
最大瞬间允许负载 Max. permissible load in a short time N.m	1.0	1.0	3.5	3.5	3.5	7.5	7.5	7.5	7.5	9	9	9	9	9

配置 28ZY38-1250 直流电机 (28ZY38-1250 DC Motor)

减速比 Reduction ratio	3.7	5.2	14	19	27	51	71	100	139	189	264	369	516	720
减速级数 Number of gear trains	1	1	2	2	2	3	3	3	3	4	4	4	4	4
减速器长度(L) Length(L) mm	29.0	29.0	36.1	36.1	36.1	43.0	43.0	43.0	43.0	49.9	49.9	49.9	49.9	49.9
空载转速 No-load speed r/min	1348	965	357	263	185	98	70	50	36	26	19	14	9.7	6.9
额定转速 Rated speed r/min	930	666	246	182	128	68	49	35	25	18	13	9.3	6.7	4.8
额定转矩 Rated torque N.m	0.023	0.033	0.079	0.11	0.15	0.26	0.36	0.51	0.71	0.86	1.2	1.7	2.3	3
最大瞬间允许负载 Max. permissible load in a short time N.m	1.0	1.0	3.5	3.5	3.5	7.5	7.5	7.5	7.5	9	9	9	9	9

配置 28ZY38-2450 直流电机 (28ZY38-2450 DC Motor)

减速比 Reduction ratio	3.7	5.2	14	19	27	51	71	100	139	189	264	369	516	720
减速级数 Number of gear trains	1	1	2	2	2	3	3	3	3	4	4	4	4	4
减速器长度(L) Length(L) mm	29.0	29.0	36.1	36.1	36.1	43.0	43.0	43.0	43.0	49.9	49.9	49.9	49.9	49.9
空载转速 No-load speed r/min	1348	965	357	263	185	98	70	50	36	26	19	14	9.7	6.9
额定转速 Rated speed r/min	1024	734	271	200	141	75	54	38	27	20	14	10	7.4	5.3
额定转矩 Rated torque N.m	0.023	0.033	0.079	0.11	0.15	0.26	0.36	0.51	0.71	0.86	1.2	1.7	2.3	3
最大瞬间允许负载 Max. permissible load in a short time N.m	1.0	1.0	3.5	3.5	3.5	7.5	7.5	7.5	7.5	9	9	9	9	9







PM DC Planetary Gear Motor (Ring Gear Material: Metal)

**30JN30K/28ZY47P** Φ30 行星减速器, 允许转矩范围: 0.3N.m~3.0N.m  
30mm OD Planetary Gearbox,  
Permissible Load Range: 0.3N.m~3.0N.m

Standard output shaft OD 6mm, OD 8mm optional.

● 外形和安装尺寸 Dimensions

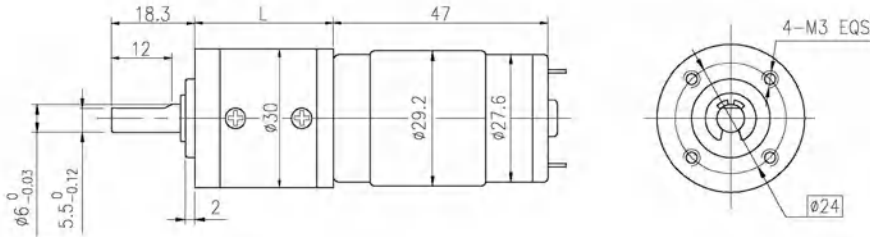

● 电动机主要技术参数 Motor Technical Data

电机型号 TYPE	额定电压 Rated voltage VDC	空载转速 No-load speed r/min	空载电流 No-load current mA	额定转速 Rated speed r/min	额定转矩 Rated torque mN.m	输出功率 Output power W	额定电流 Rated current mA	堵转力矩 Stall torque mN.m	堵转电流 Stall current A
28ZY47P-1273	12	7300	150	5950	10.8	6.7	900	32	2.7
28ZY47P-2473	24	7300	80	6160	12.7	8.2	500	38	1.5

● 齿轮减速电机主要技术参数 Gear Motor Technical Data

配置 28ZY47P-1273 直流电机 (28ZY47P-1273 DC Motor)

减速比 Reduction ratio	3.7	5.2	14	19	27	35	51	71	100	139	189	264	354	495	596
减速级数 Number of gear trains	1	1	2	2	2	2	3	3	3	3	4	4	4	4	4
减速器长度(L) Length(L) mm	29.0	29.0	36.1	36.1	36.1	36.1	43.0	43.0	43.0	43.0	49.9	49.9	49.9	49.9	49.9
空载转速 No-load speed r/min	1968	1409	521	384	270	209	143	103	73	53	39	28	21	15	12
额定转速 Rated speed r/min	1604	1149	425	313	220	170	117	84	60	43	31	23	17	12	10
额定转矩 Rated torque N.m	0.036	0.050	0.12	0.17	0.24	0.31	0.40	0.56	0.79	1.1	1.3	1.9	2.5	3	3
最大瞬间允许负载 Max. permissible load in a short time N.m	0.6	0.6	2.5	2.5	2.5	2.5	5	5	5	5	3	6	6	6	6

配置 28ZY47P-2473 直流电机 (28ZY47P-2473 DC Motor)

减速比 Reduction ratio	3.7	5.2	14	19	27	35	51	71	100	139	189	264	354	495	596
减速级数 Number of gear trains	1	1	2	2	2	2	3	3	3	3	4	4	4	4	4
减速器长度(L) Length(L) mm	29.0	29.0	36.1	36.1	36.1	36.1	43.0	43.0	43.0	43.0	49.9	49.9	49.9	49.9	49.9
空载转速 No-load speed r/min	1968	1409	521	384	270	209	143	103	73	53	39	28	21	15	12
额定转速 Rated speed r/min	1660	1189	440	324	228	176	121	87	62	44	33	23	17	12	10
额定转矩 Rated torque N.m	0.042	0.059	0.14	0.20	0.28	0.36	0.47	0.66	0.93	1.3	1.6	2.2	2.9	3	3
最大瞬间允许负载 Max. permissible load in a short time N.m	0.6	0.6	2.5	2.5	2.5	2.5	5	5	5	5	3	6	6	6	6



PM DC Planetary Gear Motor (Ring Gear Material: Metal)

**32JXE30K/28ZY47P(1)** Φ32 行星减速器, 允许转矩范围: 0.3N.m~3.0N.m  
32mm OD Planetary Gearbox,  
Permissible Load Range: 0.3N.m~3.0N.m

常规产品出轴直径Φ6, 也可以配置直径Φ8 的出轴。 Standard output shaft OD 6mm, OD 8mm optional.

● 外形和安装尺寸 Dimensions

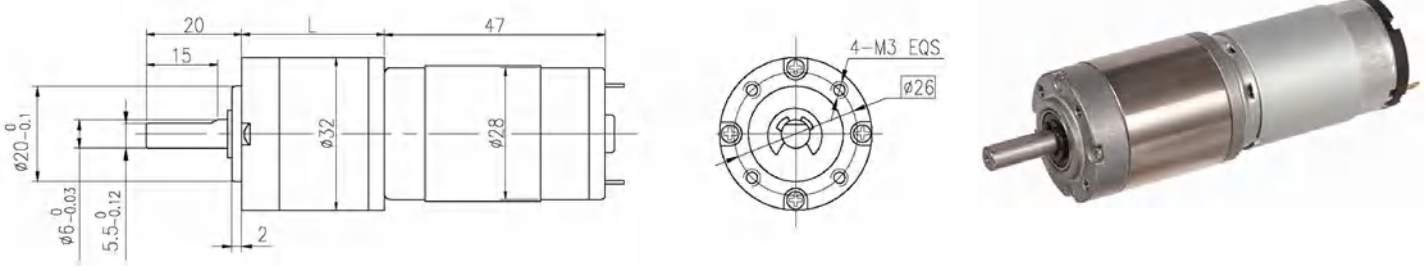

● 电动机主要技术参数 Motor Technical Data

电机型号 TYPE	额定电压 Rated voltage VDC	空载转速 No-load speed r/min	空载电流 No-load current mA	额定转速 Rated speed r/min	额定转矩 Rated torque mN.m	输出功率 Output power W	额定电流 Rated current mA	堵转力矩 Stall torque mN.m	堵转电流 Stall current A
28ZY47P-1265	12	6500	150	5290	7.6	4.2	530	23	1.6
28ZY47P-2465	24	6500	85	5250	7.3	4.0	250	23	0.8

● 齿轮减速电机主要技术参数 Gear Motor Technical Data

配置 28ZY47P-1265 直流电机 (28ZY47P-1265 DC Motor)

减速比 Reduction ratio	3.7	5.2	14	19	27	35	51	71	100	139	189	254	354	495	596
减速级数 Number of gear trains	1	1	2	2	2	2	3	3	3	3	4	4	4	4	4
减速器长度(L) Length(L) mm	25.7	25.7	32.8	32.8	32.8	32.8	39.7	39.7	39.7	39.7	46.6	46.6	46.6	46.6	46.6
空载转速 No-load speed r/min	1756	1255	464	342	241	186	127	92	65	47	34	26	18	13	11
额定转速 Rated speed r/min	1426	1021	378	278	196	151	104	75	53	38	28	21	15	11	8.9
额定转矩 Rated torque N.m	0.025	0.035	0.086	0.12	0.17	0.22	0.28	0.39	0.55	0.77	0.93	1.3	1.7	2.4	2.9
最大瞬间允许负载 Max. permissible load in a short time N.m	1.0	1.0	3.5	3.5	3.5	3.5	7.5	7.5	7.5	7.5	9	9	9	9	9

配置 28ZY47P-2465 直流电机 (28ZY47P-2465 DC Motor)

减速比 Reduction ratio	3.7	5.2	14	19	27	35	51	71	100	139	189	254	354	495	596
减速级数 Number of gear trains	1	1	2	2	2	2	3	3	3	3	4	4	4	4	4
减速器长度(L) Length(L) mm	25.7	25.7	32.8	32.8	32.8	32.8	39.7	39.7	39.7	39.7	46.6	46.6	46.6	46.6	46.6
空载转速 No-load speed r/min	1752	1255	464	342	241	186	127	92	65	47	34	26	18	13	11
额定转速 Rated speed r/min	1415	1014	375	276	194	150	103	74	53	38	28	21	15	11	8.8
额定转矩 Rated torque N.m	0.024	0.034	0.083	0.11	0.16	0.21	0.27	0.38	0.53	0.74	0.90	1.2	1.7	2.3	2.8
最大瞬间允许负载 Max. permissible load in a short time N.m	1.0	1.0	3.5	3.5	3.5	3.5	7.5	7.5	7.5	7.5	9	9	9	9	9



PM DC Planetary Gear Motor (Ring Gear Material: Metal)

**32JXE30K/28ZY47P(2)** Φ32 行星减速器, 允许转矩范围: 0.3N.m~3.0N.m  
32mm OD Planetary Gearbox,  
Permissible Load Range: 0.3N.m~3.0N.m

Standard output shaft OD 6mm, OD 8mm optional.

● 外形和安装尺寸 Dimensions

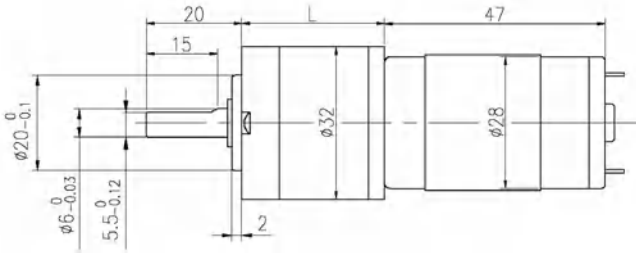

● 电动机主要技术参数 Motor Technical Data

电机型号 TYPE	额定电压 Rated voltage VDC	空载转速 No-load speed r/min	空载电流 No-load current mA	额定转速 Rated speed r/min	额定转矩 Rated torque mN.m	输出功率 Output power W	额定电流 Rated current mA	堵转力矩 Stall torque mN.m	堵转电流 Stall current A
28ZY47P-1273	12	7300	150	5950	10.8	6.7	900	32	2.7
28ZY47P-2473	24	7300	85	6160	12.7	8.2	500	38	1.5

● 齿轮减速电机主要技术参数 Gear Motor Technical Data

配置 28ZY47P-1273 直流电机 (28ZY47P-1273 DC Motor)

减速比 Reduction ratio	3.7	5.2	14	19	27	35	51	71	100	139	189	254	354	495	596
减速级数 Number of gear trains	1	1	2	2	2	2	3	3	3	3	4	4	4	4	4
减速器长度(L) Length(L) mm	25.7	25.7	32.8	32.8	32.8	32.8	39.7	39.7	39.7	39.7	46.6	46.6	46.6	46.6	46.6
空载转速 No-load speed r/min	1968	1409	521	384	270	209	143	103	73	53	39	29	21	15	12
额定转速 Rated speed r/min	1604	1149	425	313	220	170	117	84	60	43	31	23	17	12	10
额定转矩 Rated torque N.m	0.036	0.050	0.12	0.17	0.24	0.31	0.40	0.56	0.79	1.1	1.3	1.8	2.5	3	3
最大瞬间允许负载 Max. permissible load in a short time N.m	1.0	1.0	3.5	3.5	3.5	3.5	7.5	7.5	7.5	7.5	9	9	9	9	9

配置 28ZY47P-2473 直流电机 (28ZY47P-2473 DC Motor)

减速比 Reduction ratio	3.7	5.2	14	19	27	35	51	71	100	139	189	254	354	495	596
减速级数 Number of gear trains	1	1	2	2	2	2	3	3	3	3	4	4	4	4	4
减速器长度(L) Length(L) mm	25.7	25.7	32.8	32.8	32.8	32.8	39.7	39.7	39.7	39.7	46.6	46.6	46.6	46.6	46.6
空载转速 No-load speed r/min	1968	1409	521	384	270	209	143	103	73	53	39	29	21	15	12
额定转速 Rated speed r/min	1660	1189	440	324	228	176	121	87	62	44	33	24	17	12	10
额定转矩 Rated torque N.m	0.042	0.059	0.14	0.20	0.28	0.36	0.47	0.66	0.93	1.3	1.6	2.1	2.9	3	3
最大瞬间允许负载 Max. permissible load in a short time N.m	1.0	1.0	3.5	3.5	3.5	3.5	7.5	7.5	7.5	7.5	9	9	9	9	9







永磁直流行星齿轮电机 (内齿圈材质: 金属)

PM DC Planetary Gear Motor (Ring Gear Material: Metal)

**32JXE30K/31ZY46** Φ32 行星减速器, 允许转矩范围: 0.3N.m~3.0N.m  
32mm OD Planetary Gearbox,  
Permissible Load Range: 0.3N.m~3.0N.m

常规产品出轴直径Φ6, 也可以配置直径Φ8 的出轴。 Standard output shaft OD 6mm, OD 8mm optional.

● 外形和安装尺寸 Dimensions

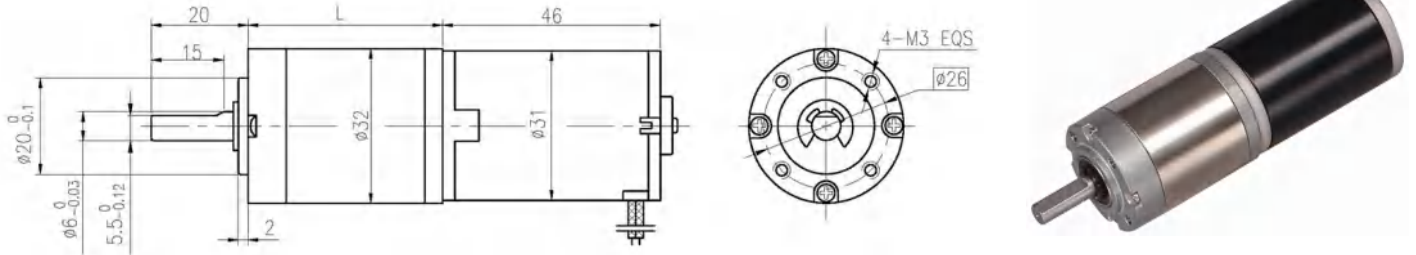

● 电动机主要技术参数 Motor Technical Data

电机型号 TYPE	额定电压 Rated voltage VDC	空载转速 No-load speed r/min	空载电流 No-load current mA	额定转速 Rated speed r/min	额定转矩 Rated torque mN.m	输出功率 Output power W	额定电流 Rated current mA	堵转力矩 Stall torque mN.m	堵转电流 Stall current A
31ZY46-2450	24	5000	120	3500	15	5.5	660	50	1.8
31ZY46-2460	24	6000	150	3600	22	8.3	800	57	1.9

● 齿轮减速电机主要技术参数 Gear Motor Technical Data

配置 31ZY46-2450 直流电机 (31ZY46-2450 DC Motor)

减速比 Reduction ratio	3.7	5.2	14	19	27	51	71	100	139	181	219	254	306	354
减速级数 Number of gear trains	1	1	2	2	2	3	3	3	3	4	4	4	4	4
减速器长度(L) Length(L) mm	25.7	25.7	32.8	32.8	32.8	39.7	39.7	39.7	39.7	46.6	46.6	46.6	46.6	46.6
空载转速 No-load speed r/min	1348	965	357	263	185	98	70	50	36	26	20	16	14	12
额定转速 Rated speed r/min	943	676	250	184	130	69	49	35	25	19	14	11	9.9	8.2
额定转矩 Rated torque N.m	0.05	0.07	0.17	0.23	0.33	0.56	0.78	1.1	1.5	1.8	2.5	3	3	3
最大瞬间允许负载 Max. permissible load in a short time N.m	1.0	1.0	3.5	3.5	3.5	7.5	7.5	7.5	7.5	7.5	9	9	9	9

配置 31ZY46-2460 直流电机 (31ZY46-2460 DC Motor)

减速比 Reduction ratio	3.7	5.2	14	19	27	51	71	100	139	181	219	254	306
减速级数 Number of gear trains	1	1	2	2	2	3	3	3	3	4	4	4	4
减速器长度(L) Length(L) mm	25.7	25.7	32.8	32.8	32.8	39.7	39.7	39.7	39.7	46.6	46.6	46.6	46.6
空载转速 No-load speed r/min	1617	1158	429	316	222	118	85	60	43	33	27	24	20
额定转速 Rated speed r/min	970	695	257	189	133	71	51	36	26	20	16	14	12
额定转矩 Rated torque N.m	0.07	0.10	0.25	0.34	0.48	0.82	1.1	1.6	2.2	2.6	3	3	3
最大瞬间允许负载 Max. permissible load in a short time N.m	1.0	1.0	3.5	3.5	3.5	7.5	7.5	7.5	7.5	7.5	9	9	9

● 电动机特性图 Motor Characteristic Figure

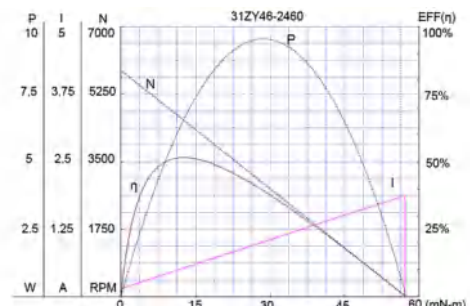
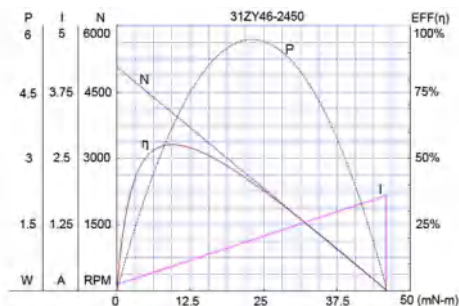

## 永磁直流行星齿轮电机 (内齿圈材质: 金属)

PM DC Planetary Gear Motor (Ring Gear Material: Metal)

*Φ32 行星减速器, 允许转矩范围: 0.3N.m~3.0N.m*

**32JXE30K/31ZY51G** *32mm OD Planetary Gearbox,*  
*Permissible Load Range: 0.3N.m~3.0N.m*

31ZY51G 直流电机是高级配置, 采用滚动轴承、长寿命电刷, 还配置了电感-电容防干扰元件, 适合在仪器、自动化装置中使用  
 31ZY51G DC motor is an advanced configuration, besides ball bearing and long lived brushes, equipping with inductance - capacitance anti jamming elements, It is suitable for instrumentation and automation devices.

### ● 外形和安装尺寸 Dimensions

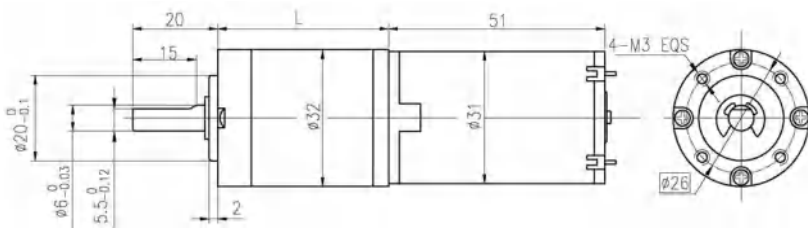

电机后端盖  
Motor Back Cover



### ● 电动机主要技术参数 Motor Technical Data

电机型号 TYPE	额定电压 Rated voltage VDC	空载转速 No-load speed r/min	空载电流 No-load current mA	额定转速 Rated speed r/min	额定转矩 Rated torque m. Nm	输出功率 Output power W	额定电流 Rated current mA	堵转力矩 Stall torque m. Nm	堵转电流 Stall current A
31ZY51G-2440	24	4000	70	3130	22	7.1	430	101.1	1.6
31ZY51G-2450	24	5000	75	3830	25	9.8	570	106.8	2.3

### ● 齿轮减速电机主要技术参数 Gear Motor Technical Data

配置 31ZY51G-2440 直流电机 (31ZY51G-2440 DC Motor)

减速比	Reduction ratio	3.7	5.2	14	19	27	51	71	100	139	181	219	306	354
减速级数	Number of gear trains	1	1	2	2	2	3	3	3	3	4	4	4	4
减速器长度(L)	Length(L) mm	25.7	25.7	32.8	32.8	32.8	39.7	39.7	39.7	39.7	46.6	46.6	46.6	46.6
空载转速	No-load speed r/min	1081	769	286	211	148	78	56	40	29	22	18	13	11
额定转速	Rated speed r/min	846	602	224	165	116	61	44	31	23	17	14	10	9
额定转矩	Rated torque N.m	0.073	0.103	0.249	0.339	0.481	0.818	1.139	1.604	2.229	2.613	3.161	4.417	5.110
最大瞬间允许负载 Max. permissible load in a short time	N.m	1.0	1.0	3.5	3.5	3.5	7.5	7.5	7.5	7.5	9	9	9	9

配置 31ZY51G-2450 直流电机 (31ZY51G-2450 DC Motor)

减速比	Reduction ratio	3.7	5.2	14	19	27	51	71	100	139	181	219	254
减速级数	Number of gear trains	1	1	2	2	2	3	3	3	3	4	4	4
减速器长度(L)	Length(L) mm	25.7	25.7	32.8	32.8	32.8	39.7	39.7	39.7	39.7	46.6	46.6	46.6
空载转速	No-load speed r/min	1351	962	357	263	185	98	70	50	36	28	23	20
额定转速	Rated speed r/min	1035	737	274	202	142	75	54	38	28	21	17	15
额定转矩	Rated torque N.m	0.083	0.117	0.284	0.385	0.547	0.929	1.294	1.823	2.533	2.969	3.592	4.166
最大瞬间允许负载 Max. permissible load in a short time	N.m	1.0	1.0	3.5	3.5	3.5	7.5	7.5	7.5	7.5	9	9	9

### ● 电动机特性图 Motor Characteristic Figure

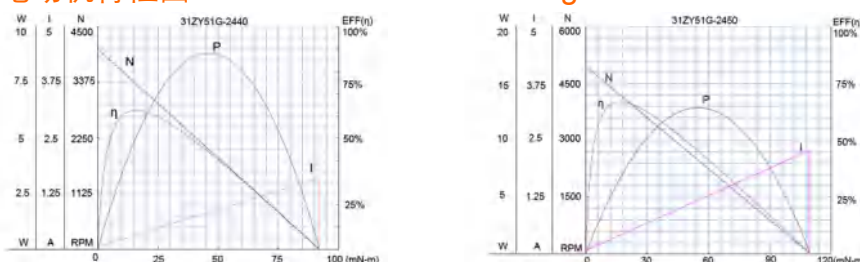

永磁直流行星齿轮电机 (内齿圈材质: 金属)

PM DC Planetary Gear Motor (Ring Gear Material: Metal)

**32JXE30K/31ZY57**       $\Phi 32$  行星减速器, 允许转矩范围: 0.3N.m~3.0N.m  
 32mm OD Planetary Gearbox,  
 Permissible Load Range: 0.3N.m~3.0N.m

常规产品出轴直径 $\Phi 6$ , 也可以配置直径 $\Phi 8$  的出轴。 Standard output shaft OD 6mm, OD 8mm optional.

● 外形和安装尺寸 Dimensions

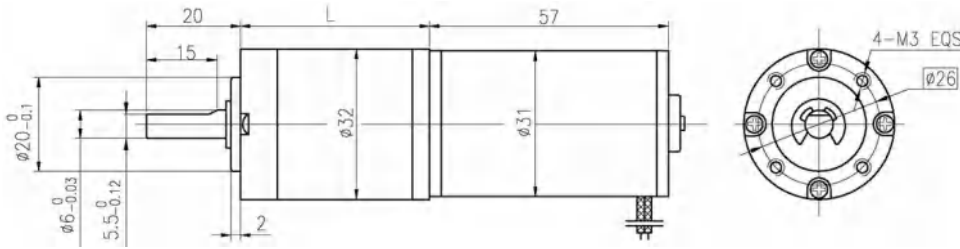

● 电动机主要技术参数 Motor Technical Data

电机型号 TYPE	额定电压 Rated voltage VDC	空载转速 No-load speed r/min	空载电流 No-load current mA	额定转速 Rated speed r/min	额定转矩 Rated torque mN.m	输出功率 Output power W	额定电流 Rated current mA	堵转力矩 Stall torque mN.m	堵转电流 Stall current A
31ZY57-2450	24	5000	100	3780	20	7.8	600	82	2.0
31ZY57-2470	24	7000	130	5500	22	12.4	750	103	3.3

● 齿轮减速电机主要技术参数 Gear Motor Technical Data

配置 31ZY57-2450 直流电机 (31ZY57-2450 DC Motor)

减速比	Reduction ratio	3.7	5.2	14	19	27	51	71	100	139	182	219	254
减速级数	Number of gear trains	1	1	2	2	2	3	3	3	3	4	4	4
减速器长度(L)	Length(L) mm	25.7	25.7	32.8	32.8	32.8	39.7	39.7	39.7	39.7	46.6	46.6	46.6
空载转速	No-load speed r/min	1351	962	357	263	185	98	70	50	36	27	23	20
额定转速	Rated speed r/min	1022	727	270	199	140	74	53	38	27	21	17	15
额定转矩	Rated torque N.m	0.07	0.10	0.25	0.34	0.48	0.82	1.1	1.6	2.2	2.6	3	3
最大瞬间允许负载	Max. permissible load in a short time N.m	1.0	1.0	3.5	3.5	3.5	7.5	7.5	7.5	7.5	9	9	9

配置 31ZY57-2470 直流电机 (31ZY57-2470 DC Motor)

减速比	Reduction ratio	3.7	5.2	14	19	27	51	71	100	139	182	219	254
减速级数	Number of gear trains	1	1	2	2	2	3	3	3	3	4	4	4
减速器长度(L)	Length(L) mm	25.7	25.7	32.8	32.8	32.8	39.7	39.7	39.7	39.7	46.6	46.6	46.6
空载转速	No-load speed r/min	1892	1346	500	368	259	137	99	70	50	38	32	28
额定转速	Rated speed r/min	1486	1058	393	289	204	108	77	55	40	30	25	22
额定转矩	Rated torque N.m	0.073	0.10	0.25	0.34	0.48	0.82	1.1	1.6	2.2	2.6	3	3
最大瞬间允许负载	Max. permissible load in a short time N.m	1.0	1.0	3.5	3.5	3.5	7.5	7.5	7.5	7.5	9	9	9

● 电动机特性图 Motor Characteristic Figure

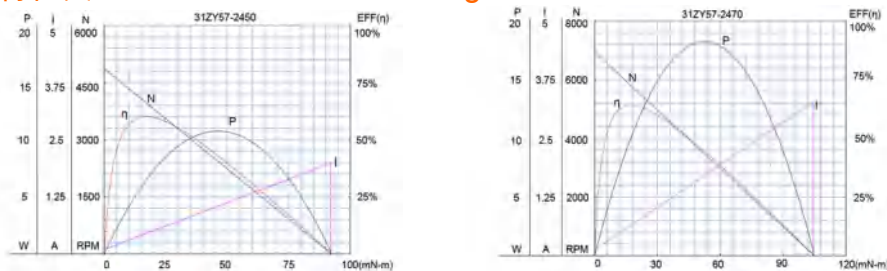



PM DC Planetary Gear Motor (Ring Gear Material: Metal)

## 32JXE30K/31ZY70

Φ32 行星减速器, 允许转矩范围: 0.3N.m~3.0N.m  
32mm OD Planetary Gearbox,  
Permissible Load Range: 0.3N.m~3.0N.m

常规产品出轴直径Φ6, 也可以配置直径Φ8 的出轴。 Standard output shaft OD 6mm, OD 8mm optional.

### ● 外形和安装尺寸 Dimensions

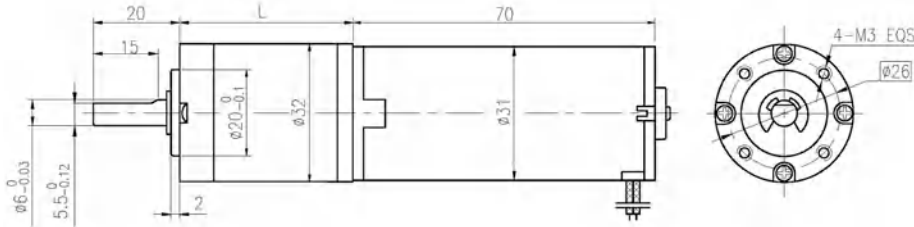

### ● 电动机主要技术参数 Motor Technical Data

电机型号 TYPE	额定电压 Rated voltage VDC	空载转速 No-load speed r/min	空载电流 No-load current mA	额定转速 Rated speed r/min	额定转矩 Rated torque mN.m	输出功率 Output power W	额定电流 Rated current mA	堵转力矩 Stall torque mN.m	堵转电流 Stall current A
31ZY70-1230	12	3000	260	2100	33	7.2	1200	85	3.0
31ZY70-2430	24	3000	100	2100	26	5.6	620	86	1.3
31ZY70-2440	24	4000	150	2800	31	9.1	1000	105	3.0

### ● 齿轮减速电机主要技术参数 Gear Motor Technical Data

配置 31ZY70-1230 直流电机 (31ZY70-1230 DC Motor)

减速比 Reduction ratio	3.7	5.2	14	19	27	51	71	100	139	181	219	254
减速级数 Number of gear trains	1	1	2	2	2	3	3	3	3	4	4	4
减速器长度(L) Length(L) mm	25.7	25.7	32.8	32.8	32.8	39.7	39.7	39.7	39.7	46.6	46.6	46.6
空载转速 No-load speed r/min	809	579	214	158	111	59	42	30	22	17	14	12
额定转速 Rated speed r/min	566	405	150	111	78	41	30	21	15	12	10	8.3
额定转矩 Rated torque N.m	0.11	0.15	0.37	0.51	0.72	1.2	1.7	2.4	3	3	3	3
最大瞬间允许负载 Max. permissible load in a short time N.m	1.0	1.0	3.5	3.5	3.5	7.5	7.5	7.5	7.5	9	9	9

配置 31ZY70-2430 直流电机 (31ZY70-2430 DC Motor)

减速比 Reduction ratio	3.7	5.2	14	19	27	51	71	100	139	181	219	254
减速级数 Number of gear trains	1	1	2	2	2	3	3	3	3	4	4	4
减速器长度(L) Length(L) mm	25.7	25.7	32.8	32.8	32.8	39.7	39.7	39.7	39.7	46.6	46.6	46.6
空载转速 No-load speed r/min	809	579	214	158	111	59	42	30	22	17	14	12
额定转速 Rated speed r/min	566	405	150	111	78	41	30	21	15	12	10	8.3
额定转矩 Rated torque N.m	0.087	0.12	0.29	0.40	0.57	0.97	1.4	1.9	2.6	3	3	3
最大瞬间允许负载 Max. permissible load in a short time N.m	1.0	1.0	3.5	3.5	3.5	7.5	7.5	7.5	7.5	9	9	9

配置 31ZY70-2440 直流电机 (31ZY70-2440 DC Motor)

减速比 Reduction ratio	3.7	5.2	14	19	27	51	71	100	115	181	219	254
减速级数 Number of gear trains	1	1	2	2	2	3	3	3	3	4	4	4
减速器长度(L) Length(L) mm	25.7	25.7	32.8	32.8	32.8	39.7	39.7	39.7	39.7	46.6	46.6	46.6
空载转速 No-load speed r/min	1078	772	286	211	148	78	56	40	35	22	18	16
额定转速 Rated speed r/min	755	541	200	147	104	55	39	28	24	15	13	11
额定转矩 Rated torque N.m	0.10	0.15	0.35	0.48	0.68	1.2	1.6	2.3	2.6	3	3	3
最大瞬间允许负载 Max. permissible load in a short time N.m	1.0	1.0	3.5	3.5	3.5	7.5	7.5	7.5	7.5	9	9	9







PM DC Planetary Gear Motor (Ring Gear Material: Metal)

**36JX30K/36ZY85P** Φ36 行星减速器, 允许转矩范围: 0.3N.m~3.0N.m  
36mm Planetary Gearbox  
Permissible Load Range: 0.3N.m~3.0N.m

● 外形和安装尺寸 Dimensions

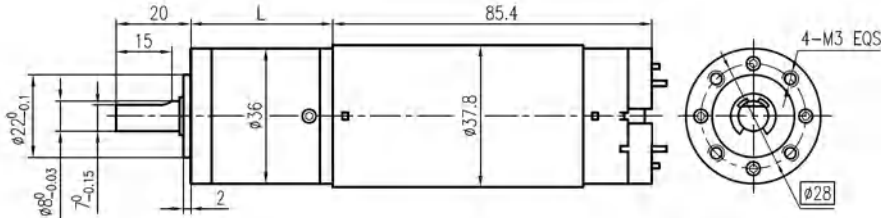

● 电动机主要技术参数 Motor Technical Data

电机型号 TYPE	额定电压 Rated voltage VDC	空载转速 No-load speed r/min	空载电流 No-load current mA	额定转速 Rated speed r/min	额定转矩 Rated torque m.Nm	输出功率 Output power W	额定电流 Rated current A	堵转转矩 Stall torque m.Nm	堵转电流 Stall current A
36ZY85P-1230	12	3000	250	2400	40	10	1.60	206	6.7
36ZY85P-2430	24	3000	150	2500	40	10	0.85	250	4.2
36ZY85P-2464	24	6400	350	5200	49	26	4.75	295	5.0

● 齿轮减速电机主要技术参数 Gear Motor Technical Data

配置 36ZY85P-1230 直流电机 (36ZY85P-1230 DC Motor)

减速比 Reduction ratio	3.7	5.2	14	19	27	51	71	100	139
减速级数 Number of gear trains	1	1	2	2	2	3	3	3	3
减速器长度(L) Length(L) mm	31.0	31.0	38.5	38.5	38.5	48.4	48.4	48.4	48.4
空载转速 No-load speed r/min	809	579	214	157	111	59	42	30	21
额定转速 Rated speed r/min	649	462	171	126	89	47	34	24	18
额定转矩 Rated torque N.m	0.13	0.19	0.45	0.62	0.87	1.5	2.1	2.9	3
最大瞬间允许负载 Max. permissible load in a short time N.m	1.0	1.0	3.5	3.5	3.5	7.5	9	9	9

配置 36ZY85P-2430 直流电机 (36ZY85P-2430 DC Motor)

减速比 Reduction ratio	3.7	5.2	14	19	27	51	71	100	139
减速级数 Number of gear trains	1	1	2	2	2	3	3	3	3
减速器长度(L) Length(L) mm	31.0	31.0	38.5	38.5	38.5	48.4	48.4	48.4	48.4
空载转速 No-load speed r/min	809	579	214	157	111	59	42	30	21
额定转速 Rated speed r/min	674	483	179	132	93	49	35	25	19
额定转矩 Rated torque N.m	0.13	0.19	0.45	0.62	0.87	1.5	2.1	2.9	3
最大瞬间允许负载 Max. permissible load in a short time N.m	1.0	1.0	3.5	3.5	3.5	7.5	9	9	9

配置 36ZY85P-2464 直流电机 (36ZY85P-2464 DC Motor)

减速比 Reduction ratio	3.7	5.2	14	19	27	51	71	82	96	115
减速级数 Number of gear trains	1	1	2	2	2	3	3	3	3	3
减速器长度(L) Length(L) mm	31.0	31.0	38.5	38.5	38.5	48.4	48.4	48.4	48.4	48.4
空载转速 No-load speed r/min	1725	1236	457	337	237	125	90	78	67	56
额定转速 Rated speed r/min	1402	1004	371	274	193	102	73	63	54	45
额定转矩 Rated torque N.m	0.16	0.23	0.56	0.75	1.0	1.8	2.5	2.9	3	3
最大瞬间允许负载 Max. permissible load in a short time N.m	1.0	1.0	3.5	3.5	3.5	7.5	9	9	9	9

永磁直流行星齿轮电机 (内齿圈材质: 金属)

PM DC Planetary Gear Motor (Ring Gear Material: Metal)

36JX30K/36ZY85P

Φ36 行星减速器, 允许转矩范围: 0.3N.m~3.0N.m  
36mm Planetary Gearbox  
Permissible Load Range: 0.3N.m~3.0N.m

● 外形和安装尺寸 Dimensions

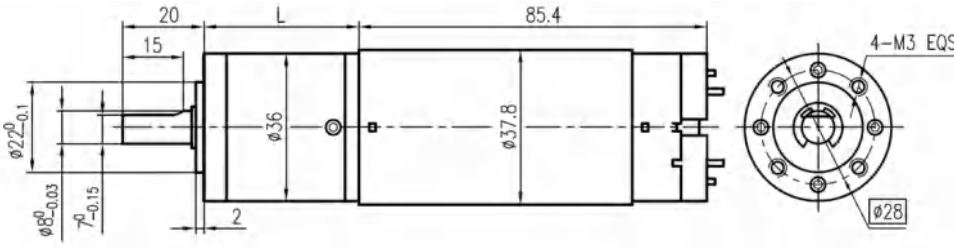

● 电动机主要技术参数 Motor Technical Data

电机型号 TYPE	额定电压 Rated voltage VDC	空载转速 No-load speed r/min	空载电流 No-load current mA	额定转速 Rated speed r/min	额定转矩 Rated torque m.Nm	输出功率 Output power W	额定电流 Rated current A	堵转转矩 Stall torque m.Nm	堵转电流 Stall current A
36ZY85P-1230	12	3000	250	2400	40	10	1.60	206	6.7
36ZY85P-2430	24	3000	150	2500	40	10	0.85	250	4.2

● 齿轮减速电机主要技术参数 Gear Motor Technical Data

配置 36ZY85P-1230 直流电机 (36ZY85P-1230 DC Motor)

减速比 Reduction ratio	3.7	5.2	14	19	27	51	71	100	139
减速级数 Number of gear trains	1	1	2	2	2	3	3	3	3
减速器长度(L) Length(L) mm	31.0	31.0	38.5	38.5	38.5	48.4	48.4	48.4	48.4
空载转速 No-load speed r/min	809	579	214	157	111	59	42	30	21
额定转速 Rated speed r/min	649	462	171	126	89	47	34	24	18
额定转矩 Rated torque N.m	0.13	0.19	0.45	0.62	0.87	1.5	2.1	2.9	3
最大瞬间允许负载 Max. permissible load in a short time N.m	1.0	1.0	3.5	3.5	3.5	7.5	9	9	9

配置 36ZY85P-2430 直流电机 (36ZY85P-2430 DC Motor)

减速比 Reduction ratio	3.7	5.2	14	19	27	51	71	100	139
减速级数 Number of gear trains	1	1	2	2	2	3	3	3	3
减速器长度(L) Length(L) mm	31.0	31.0	38.5	38.5	38.5	48.4	48.4	48.4	48.4
空载转速 No-load speed r/min	809	579	214	157	111	59	42	30	21
额定转速 Rated speed r/min	674	483	179	132	93	49	35	25	19
额定转矩 Rated torque N.m	0.13	0.19	0.45	0.62	0.87	1.5	2.1	2.9	3
最大瞬间允许负载 Max. permissible load in a short time N.m	1.0	1.0	3.5	3.5	3.5	7.5	9	9	9

● 电动机特性图 Motor Characteristic Figure

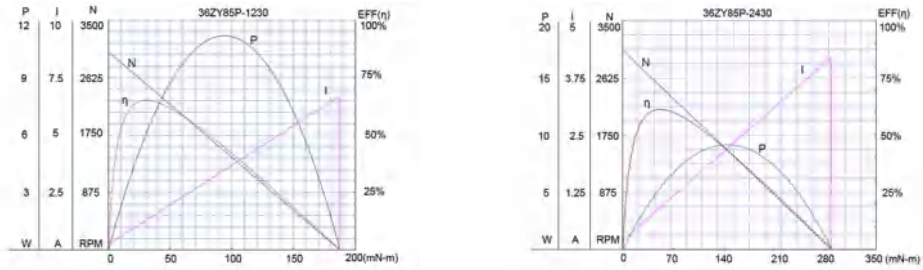

## 永磁直行星齿轮电机 (内齿圈材质: 金属和粉末金属)

PM DC Planetary Gear Motor (Ring Gear Material: Metal and Powder Metal)

36JXE30K/36ZY50

Φ36 行星减速器, 允许转矩范围: 0.3N.m~3.0N.m  
36mm Planetary Gearbox  
Permissible Load Range: 0.3N.m~3.0N.m

可在两种材料的内齿圈中进行选择: 粉末金属 (型号 36JXF30K), 金属 (型号 36JXE30K)  
Ring gear can be selected within the two materials: Powder metal (Type:36JXF30K), Metal (Type:36JXE30K)

### ● 外形和安装尺寸 Dimensions

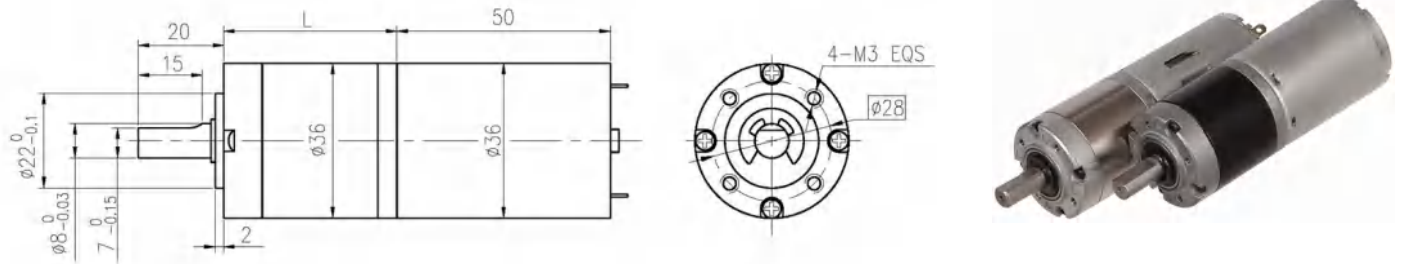

### ● 电动机主要技术参数 Motor Technical Data

电机型号 TYPE	额定电压 Rated voltage VDC	空载转速 No-load speed r/min	空载电流 No-load current mA	额定转速 Rated speed r/min	额定转矩 Rated torque mN.m	输出功率 Output power W	额定电流 Rated current A	堵转转矩 Stall torque mN.m	堵转电流 Stall current A
36ZY50-2436	24	3600	100	3000	11	3.4	0.40	58	1.7
36ZY50-2442	24	4200	120	3450	12	4.2	0.43	52	1.6

### ● 齿轮减速电机主要技术参数 Gear Motor Technical Data

配置 36ZY50-2436 直流电机 (36ZY50-2436 DC Motor)

减速比 Reduction ratio	3.7	5.2	14	19	27	51	71	100	139	189	264	369	516
减速级数 Number of gear trains	1	1	2	2	2	3	3	3	3	4	4	4	4
减速器长度(L) Length(L) mm	26.5	26.5	33.6	33.6	33.6	40.5	40.5	40.5	40.5	47.4	47.4	47.4	47.4
空载转速 No-load speed r/min	970	695	257	189	133	71	51	36	26	19	14	9.8	7.0
额定转速 Rated speed r/min	809	579	214	158	111	59	42	30	22	16	11	8.1	5.8
额定转矩 Rated torque N.m	0.037	0.051	0.12	0.17	0.24	0.41	0.57	0.80	1.1	1.4	1.9	2.6	3
最大瞬间允许负载 Max. permissible load in a short time N.m	1.0	1.0	3.5	3.5	3.5	7.5	7.5	7.5	7.5	9	9	9	9

配置 36ZY50-2442 直流电机 (36ZY50-2442 DC Motor)

减速比 Reduction ratio	3.7	5.2	14	19	27	51	71	100	139	189	264	369	516
减速级数 Number of gear trains	1	1	2	2	2	3	3	3	3	4	4	4	4
减速器长度(L) Length(L) mm	26.5	26.5	33.6	33.6	33.6	40.5	40.5	40.5	40.5	47.4	47.4	47.4	47.4
空载转速 No-load speed r/min	1132	811	300	221	156	82	59	42	30	22	16	11	8.1
额定转速 Rated speed r/min	930	666	246	182	128	68	49	35	25	18	13	9.3	6.7
额定转矩 Rated torque N.m	0.040	0.056	0.14	0.18	0.26	0.45	0.62	0.88	1.2	1.5	2.1	2.9	3
最大瞬间允许负载 Max. permissible load in a short time N.m	1.0	1.0	3.5	3.5	3.5	7.5	7.5	7.5	7.5	9	9	9	9

### ● 电动机特性图 Motor Characteristic Figure

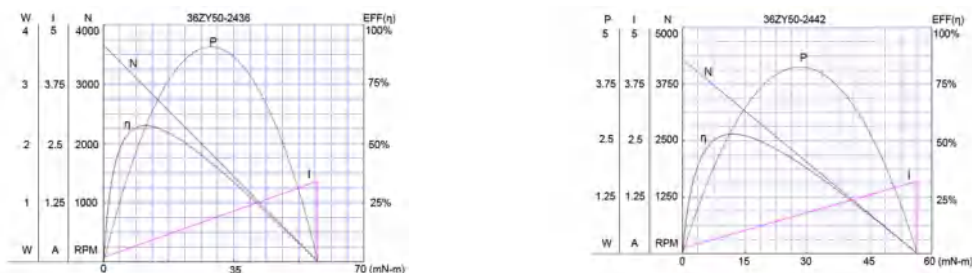



PM DC Planetary Gear Motor (Ring Gear Material: Metal and Powder Metal)

**36JXE30K/36ZY57P**

Φ36 行星减速器, 允许转矩范围: 0.3N.m~3.0N.m  
36mm Planetary Gearbox  
Permissible Load Range: 0.3N.m~3.0N.m

Ring gear can be selected within the two materials: Powder metal (Type:36JXF30K), Metal (Type:36JXE30K)

● 外形和安装尺寸 Dimensions

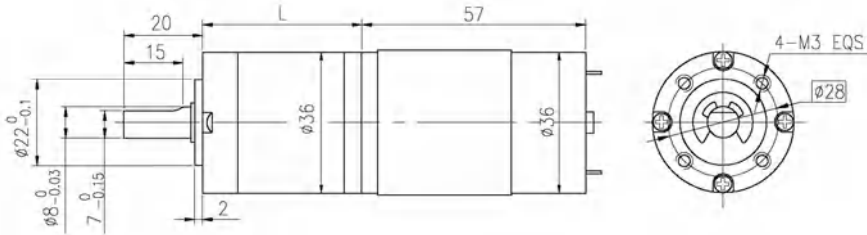

● 电动机主要技术参数 Motor Technical Data

电机型号 TYPE	额定电压 Rated voltage VDC	空载转速 No-load speed r/min	空载电流 No-load current mA	额定转速 Rated speed r/min	额定转矩 Rated torque mN.m	输出功率 Output power W	额定电流 Rated current A	堵转转矩 Stall torque mN.m	堵转电流 Stall current A
36ZY57P-1260	12	6000	260	5000	25	13.1	1.6	75	4.8
36ZY57P-2460	24	6000	130	5000	26	13.5	0.8	78	2.4

● 齿轮减速电机主要技术参数 Gear Motor Technical Data

配置 36ZY57P-1260 直流电机 (36ZY57P-1260 DC Motor)

减速比 Reduction ratio	3.7	5.2	14	19	27	51	71	100	115	139	181	219	254	306	354
减速级数 Number of gear trains	1	1	2	2	2	3	3	3	3	3	4	4	4	4	4
减速器长度(L) Length(L) mm	26.5	26.5	33.6	33.6	33.6	40.5	40.5	40.5	40.5	40.5	47.4	47.4	47.4	47.4	47.4
空载转速 No-load speed r/min	1617	1158	429	316	222	118	85	60	52	43	33	27	24	20	17
额定转速 Rated speed r/min	1346	965	357	263	185	98	70	50	43	36	28	23	20	16	14
额定转矩 Rated torque N.m	0.081	0.12	0.28	0.38	0.49	0.93	1.3	1.8	2.1	2.5	2.9	3	3	3	3
最大瞬间允许负载 Max. permissible load in a short time N.m	1.0	1.0	3.5	3.5	3.5	7.5	7.5	7.5	7.5	7.5	9	9	9	9	9

配置 36ZY57P-2460 直流电机 (36ZY57P-2460DC Motor)

减速比 Reduction ratio	3.7	5.2	14	19	27	51	71	100	115	139	181	219	254	306	354
减速级数 Number of gear trains	1	1	2	2	2	3	3	3	3	3	4	4	4	4	4
减速器长度(L) Length(L) mm	26.5	26.5	33.6	33.6	33.6	40.5	40.5	40.5	40.5	40.5	47.4	47.4	47.4	47.4	47.4
空载转速 No-load speed r/min	1617	1158	429	316	222	118	85	60	52	43	33	27	24	20	17
额定转速 Rated speed r/min	1346	965	357	263	185	98	70	50	43	36	28	23	20	16	14
额定转矩 Rated torque N.m	0.087	0.12	0.29	0.40	0.51	1.0	1.3	1.9	2.2	2.6	3	3	3	3	3
最大瞬间允许负载 Max. permissible load in a short time N.m	1.0	1.0	3.5	3.5	3.5	7.5	7.5	7.5	7.5	7.5	9	9	9	9	9



永磁直行星齿轮电机 (内齿圈材质: 金属和粉末金属)

PM DC Planetary Gear Motor (Ring Gear Material: Metal and Powder Metal)

**36JXE30K/36ZY57**       $\Phi 36$  行星减速器, 允许转矩范围: 0.3N.m~3.0N.m  
 36mm Planetary Gearbox  
 Permissible Load Range: 0.3N.m~3.0N.m

可在两种材料的内齿圈中进行选择: 粉末金属 (型号 36JXF30K), 金属 (型号 36JXE30K)

Ring gear can be selected within the two materials: Powder metal (Type:36JXF30K), Metal (Type:36JXE30K)

● 外形和安装尺寸 Dimensions

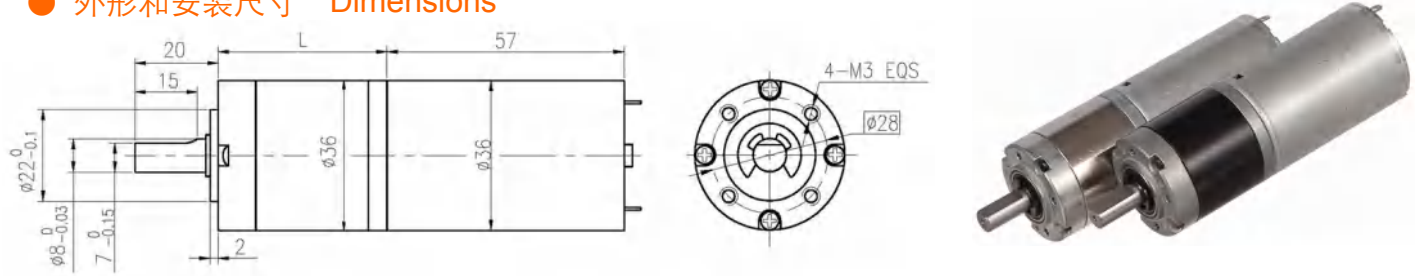

● 电动机主要技术参数 Motor Technical Data

电机型号 TYPE	额定电压 Rated voltage VDC	空载转速 No-load speed r/min	空载电流 No-load current mA	额定转速 Rated speed r/min	额定转矩 Rated torque mN.m	输出功率 Output power W	额定电流 Rated current A	堵转转矩 Stall torque mN.m	堵转电流 Stall current A
36ZY57-2430	24	3000	100	2500	15	4.5	0.52	92	2.2
36ZY57-2442	24	4200	120	3600	19	7	0.52	97	2.8

可以制造 12VDC 的产品, 转速、转矩指标与 24VDC 基本一致。 12V DC Optional, speed and torque is the same as 24V DC's.

● 齿轮减速电机主要技术参数 Gear Motor Technical Data

配置 36ZY57-2430 直流电机 (36ZY57-2430 DC Motor)

减速比 Reduction ratio	3.7	5.2	14	19	27	51	71	100	139	181	219	254	306	354	427
减速级数 Number of gear trains	1	1	2	2	2	3	3	3	3	4	4	4	4	4	4
减速器长度(L) Length(L) mm	26.5	26.5	33.6	33.6	33.6	40.5	40.5	40.5	40.5	47.4	47.4	47.4	47.4	47.4	47.4
空载转速 No-load speed r/min	809	579	214	158	111	59	42	30	22	16	14	12	9.8	8.5	7.0
额定转速 Rated speed r/min	674	483	179	132	93	49	35	25	18	13	11	9.8	8.2	7.1	5.9
额定转矩 Rated torque N.m	0.050	0.070	0.17	0.23	0.33	0.56	0.78	1.1	1.5	1.8	2.1	2.4	3	3	3
最大瞬间允许负载 Max. permissible load in a short time N.m	1.0	1.0	3.5	3.5	3.5	7.5	7.5	7.5	7.5	9	9	9	9	9	9

配置 36ZY57-2442 直流电机 (36ZY57-2442 DC Motor)

减速比 Reduction ratio	3.7	5.2	14	19	27	51	71	100	139	181	219	254	306	354
减速级数 Number of gear trains	1	1	2	2	2	3	3	3	3	4	4	4	4	4
减速器长度(L) Length(L) mm	26.5	26.5	33.6	33.6	33.6	40.5	40.5	40.5	40.5	47.4	47.4	47.4	47.4	47.4
空载转速 No-load speed r/min	1132	811	300	221	156	82	59	42	30	22	19	17	14	12
额定转速 Rated speed r/min	970	695	257	189	133	71	51	36	26	19	16	14	12	10
额定转矩 Rated torque N.m	0.063	0.089	0.22	0.29	0.42	0.71	0.98	1.4	1.9	2.3	2.7	3	3	3
最大瞬间允许负载 Max. permissible load in a short time N.m	1.0	1.0	3.5	3.5	3.5	7.5	7.5	7.5	7.5	9	9	9	9	9

● 电动机特性图 Motor Characteristic Figure

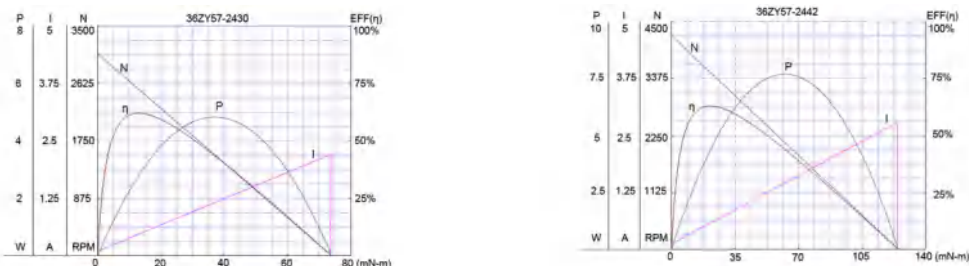



PM DC Planetary Gear Motor (Ring Gear Material: Metal and Powder)

**36JXF50K/36ZY65** Φ36 行星减速器, 允许转矩范围: 0.5N.m~5.0N.m  
36mm Planetary Gearbox  
Permissible Load Range: 0.5N.m~5.0N.m

● 外形和安装尺寸 Dimensions

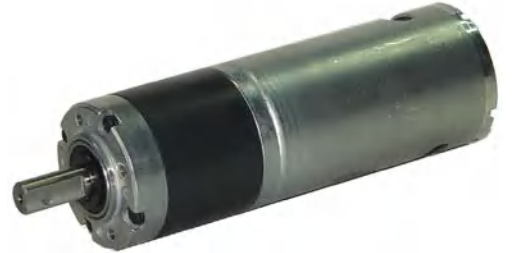
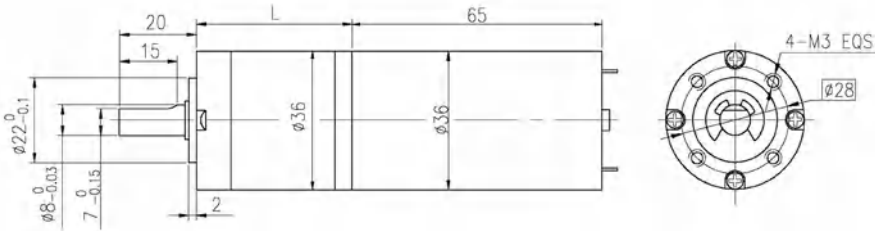

● 电动机主要技术参数 Motor Technical Data

电机型号 TYPE	额定电压 Rated voltage VDC	空载转速 No-load speed r/min	空载电流 No-load current mA	额定转速 Rated speed r/min	额定转矩 Rated torque mN.m	输出功率 Output power W	额定电流 Rated current A	堵转转矩 Stall torque mN.m	堵转电流 Stall current A
36ZY65-1272	12	7200	800	5750	36	22	4.2	115	12
36ZY65-2472	24	7200	400	5750	38	23	2.1	115	6

● 齿轮减速电机主要技术参数 Gear Motor Technical Data

配置 36ZY65-1272 直流电机 (36ZY65-1272 DC Motor)

减速比 Reduction ratio	3.7	5.2	14	19	22	27	35	49	59	71	82	95	100	115	139	181	218
减速级数 Number of gear trains	1	1	2	2	2	2	2	3	3	3	3	3	3	3	3	4	4
减速器长度(L) Length(L) mm	29.0	29.0	38.4	38.4	38.4	38.4	38.4	47.7	47.7	47.7	47.7	47.7	47.7	47.7	47.7	53.0	53.0
空载转速 No-load speed r/min	1941	1390	514	379	327	267	206	147	122	101	88	76	72	63	52	40	33
额定转速 Rated speed r/min	1550	1110	411	303	261	213	164	117	97	81	70	61	58	50	41	32	26
额定转矩 Rated torque N.m	0.12	0.17	0.41	0.55	0.64	0.79	1.0	1.3	1.6	1.9	2.2	2.5	2.6	3.0	3.7	4.2	5
最大瞬间允许负载 Max. permissible load in a short time N.m	1.5	1.5	6	6	6	6	6	10	10	10	10	10	10	10	10	12	12

配置 36ZY65-2472 直流电机 (36ZY65-2472 DC Motor)

减速比 Reduction ratio	3.7	5.2	14	19	22	27	35	49	59	71	82	95	100	115	139	181	218
减速级数 Number of gear trains	1	1	2	2	2	2	2	3	3	3	3	3	3	3	3	4	4
减速器长度(L) Length(L) mm	29.0	29.0	38.4	38.4	38.4	38.4	38.4	47.7	47.7	47.7	47.7	47.7	47.7	47.7	47.7	53.0	53.0
空载转速 No-load speed r/min	1941	1390	514	379	327	267	206	147	122	101	88	76	72	63	52	40	33
额定转速 Rated speed r/min	1550	1110	411	303	261	213	164	117	97	81	70	61	58	50	41	32	26
额定转矩 Rated torque N.m	0.13	0.18	0.43	0.58	0.68	0.83	1.1	1.4	1.6	2.0	2.3	2.6	2.8	3.2	3.9	4.5	5
最大瞬间允许负载 Max. permissible load in a short time N.m	1.5	1.5	6	6	6	6	6	10	10	10	10	10	10	10	10	12	12



PM DC Planetary Gear Motor (Ring Gear Material: Metal and Powder)

## 36JXF50K/36ZY65P

Φ36 行星减速器, 允许转矩范围: 0.5N.m~5.0N.m  
36mm Planetary Gearbox  
Permissible Load Range: 0.5N.m~5.0N.m

### ● 外形和安装尺寸 Dimensions

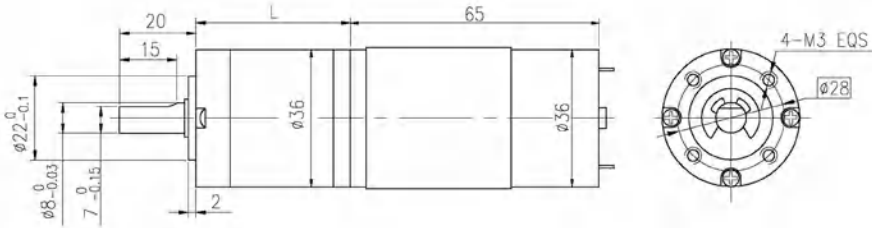

### ● 电动机主要技术参数 Motor Technical Data

电机型号 TYPE	额定电压 Rated voltage VDC	空载转速 No-load speed r/min	空载电流 No-load current mA	额定转速 Rated speed r/min	额定转矩 Rated torque mN.m	输出功率 Output power W	额定电流 Rated current A	堵转转矩 Stall torque mN.m	堵转电流 Stall current A
36ZY65P-1262	12	6200	600	5000	44	23	3.0	132	9
36ZY65P-2462	24	6200	300	5000	46	24	1.5	138	4.5

### ● 齿轮减速电机主要技术参数 Gear Motor Technical Data

#### 配置 36ZY65P-1262 直流电机 (36ZY65P-1262 DC Motor)

减速比 Reduction ratio	3.7	5.2	14	19	22	27	35	49	59	71	82	95	100	115	139	181	218
减速级数 Number of gear trains	1	1	2	2	2	2	2	3	3	3	3	3	3	3	3	4	4
减速器长度(L) Length(L) mm	29.0	29.0	38.4	38.4	38.4	38.4	38.4	47.7	47.7	47.7	47.7	47.7	47.7	47.7	47.7	53.0	53.0
空载转速 No-load speed r/min	1671	1197	443	326	282	230	177	127	105	87	76	65	62	54	45	34	28
额定转速 Rated speed r/min	1347	965	357	263	227	185	143	102	85	70	61	53	50	43	36	28	23
额定转矩 Rated torque N.m	0.15	0.21	0.50	0.68	0.78	0.96	1.2	1.6	1.9	2.3	2.6	3.1	3.2	3.7	4.5	5	5
最大瞬间允许负载 Max. permissible load in a short time N.m	1.5	1.5	6	6	6	6	6	10	10	10	10	10	10	10	10	12	12

#### 配置 36ZY65P-2462 直流电机 (36ZY65P-2462 DC Motor)

减速比 Reduction ratio	3.7	5.2	14	19	22	27	35	49	59	71	82	95	100	115	139	181	218
减速级数 Number of gear trains	1	1	2	2	2	2	2	3	3	3	3	3	3	3	3	4	4
减速器长度(L) Length(L) mm	29.0	29.0	38.4	38.4	38.4	38.4	38.4	47.7	47.7	47.7	47.7	47.7	47.7	47.7	47.7	53.0	53.0
空载转速 No-load speed r/min	1671	1197	443	326	282	230	177	127	105	87	76	65	62	54	45	34	28
额定转速 Rated speed r/min	1347	965	357	263	227	185	143	102	85	70	61	53	50	43	36	28	23
额定转矩 Rated torque N.m	0.15	0.21	0.52	0.71	0.82	1.0	1.3	1.6	2.0	2.4	2.8	3.2	3.4	3.9	4.7	5	5
最大瞬间允许负载 Max. permissible load in a short time N.m	1.5	1.5	6	6	6	6	6	10	10	10	10	10	10	10	10	12	12



永磁直行星齿轮电机 (内齿圈材质: 金属)

PM DC Planetary Gear Motor (Ring Gear Material: Metal)

42JX50K/42ZY75

Φ42 行星减速器, 允许转矩范围: 0.5N.m~5N.m  
42mm Planetary Gearbox  
Permissible Load Range: 0.5N.m~5N.m

● 外形和安装尺寸 Dimensions

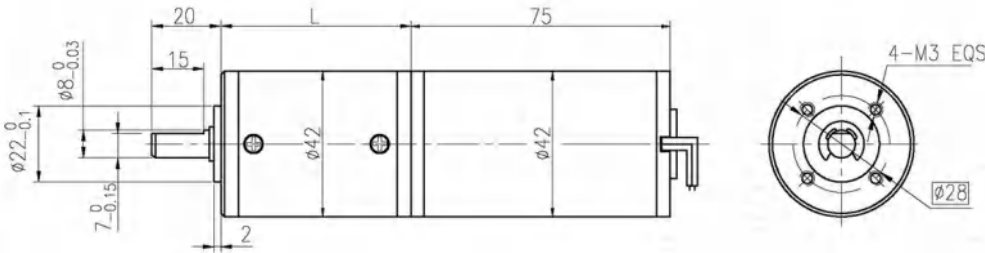

● 电动机主要技术参数 Motor Technical Data

电机型号 TYPE	额定电压 Rated voltage VDC	空载转速 No-load speed r/min	空载电流 No-load current A	额定转速 Rated speed r/min	额定转矩 Rated torque mN.m	输出功率 Output power W	额定电流 Rated current A	堵转力矩 Stall torque mN.m	堵转电流 Stall current A
42ZY75-2430	24	3000	0.15	2500	44	11.5	0.75	259	3.55
42ZY75-2440	24	4000	0.20	3500	55	20	1.2	360	6.3

● 齿轮减速电机主要技术参数 Gear Motor Technical Data

配置 42ZY75-2430 直流电机 (42ZY75-2430 DC Motor)

减速比 Reduction ratio	3.82	4.88	15	19	24	56	71	91	116	212
减速级数 Number of gear trains	1	1	2	2	2	3	3	3	3	4
减速器长度(L) Length(L) mm	37.5	37.5	48.1	48.1	48.1	58.5	58.5	58.5	58.5	68.9
空载转速 No-load speed r/min	785	615	200	158	125	54	42	33	26	14
额定转速 Rated speed r/min	654	512	167	132	104	45	35	27	22	12
额定转矩 Rated torque N.m	0.15	0.19	0.53	0.68	0.86	1.8	2.3	2.9	3.7	5
最大瞬间允许负载 Max. permissible load in a short time N.m	1.5	1.5	6	6	6	15	15	15	15	15

配置 42ZY75-2440 直流电机 (42ZY75-2440 DC Motor)

减速比 Reduction ratio	3.82	4.88	15	19	24	56	71	91	116	212
减速级数 Number of gear trains	1	1	2	2	2	3	3	3	3	4
减速器长度(L) Length(L) mm	37.5	37.5	48.1	48.1	48.1	58.5	58.5	58.5	58.5	68.9
空载转速 No-load speed r/min	1047	820	267	211	167	71	56	44	34	19
额定转速 Rated speed r/min	916	717	233	184	146	63	49	37	30	17
额定转矩 Rated torque N.m	0.19	0.24	0.67	0.85	1.1	2.2	2.9	3.7	4.7	5
最大瞬间允许负载 Max. permissible load in a short time N.m	1.5	1.5	6	6	6	12	12	12	12	15

● 电动机特性图 Motor Characteristic Figure

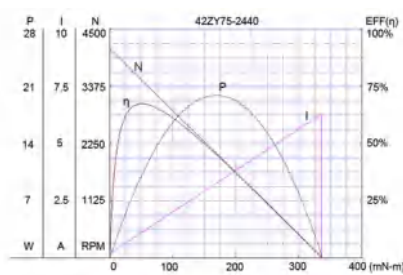
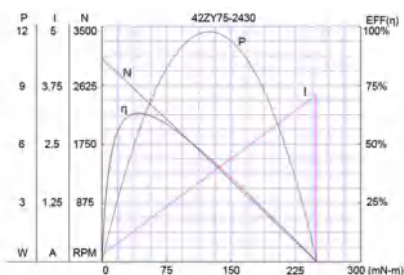



PM DC Planetary Gear Motor (Ring Gear Material: Metal and Powder Metal)

**42JXE100K/42ZY68** Φ42 行星减速器, 允许转矩范围: 1N.m~10N.m  
42mm Planetary Gearbox  
Permissible Load Range: 1N.m~10N.m

Ring gear can be selected within the two materials: Powder metal (Type:42JXF100K), Metal (Type:42JXE100K)

● 外形和安装尺寸 Dimensions

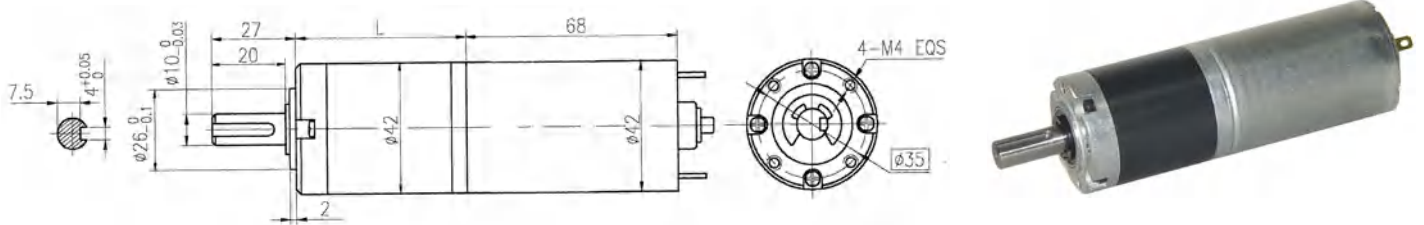

● 电动机主要技术参数 Motor Technical Data

电机型号 TYPE	额定电压 Rated voltage VDC	空载转速 No-load speed r/min	空载电流 No-load current A	额定转速 Rated speed r/min	额定转矩 Rated torque mN.m	输出功率 Output power W	额定电流 Rated current A	堵转力矩 Stall torque mN.m	堵转电流 Stall current A
42ZY68-2430	24	3000	0.35	2250	56	13	1.0	175	2.6
42ZY68-2440	24	4000	0.38	3000	75	24	1.6	215	4.2
42ZY68-2450	24	5000	0.45	3750	80	31	2.2	230	6.0

● 齿轮减速电机主要技术参数 Gear Motor Technical Data

配置 42ZY68-2430 直流电机 (42ZY68P-2430 DC Motor)

减速比 Reduction ratio	3.71	5.18	14	19	27	51	71	100	115	139	181	219	254	306	354
减速级数 Number of gear trains	1	1	2	2	2	3	3	3	3	3	4	4	4	4	4
减速器长度(L) Length(L) mm	31.5	31.5	42.1	42.1	42.1	52.5	52.5	52.5	52.5	52.5	62.9	62.9	62.9	62.9	62.9
空载转速 No-load speed r/min	809	579	214	158	111	59	42	30	26	22	17	14	11	9.8	8.5
额定转速 Rated speed r/min	606	434	161	118	83	44	32	23	20	16	12	10	8.9	7.4	6.4
额定转矩 Rated torque N.m	0.19	0.26	0.64	0.86	1.1	2.1	2.9	4.1	4.7	5.7	6.6	8.0	9.2	10	10
最大瞬间允许负载 Max. permissible load in a short time N.m	3	3	12	12	12	25	25	25	25	25	30	30	30	30	30

配置 42ZY68-2440 直流电机 (42ZY68-2440 DC Motor)

减速比 Reduction ratio	3.7	5.2	14	19	27	51	71	100	115	139	181	219	254
减速级数 Number of gear trains	1	1	2	2	2	3	3	3	3	3	4	4	4
减速器长度(L) Length(L) mm	31.5	31.5	42.1	42.1	42.1	52.5	52.5	52.5	52.5	52.5	62.9	62.9	62.9
空载转速 No-load speed r/min	1078	772	286	211	148	78	56	40	35	29	22	18	16
额定转速 Rated speed r/min	809	579	214	158	111	59	42	30	26	22	17	14	12
额定转矩 Rated torque N.m	0.25	0.35	0.85	1.2	1.5	2.8	3.9	5.5	6.3	7.6	8.8	10	10
最大瞬间允许负载 Max. permissible load in a short time N.m	3	3	12	12	12	25	25	25	25	25	30	30	30

配置 42ZY68-2450 直流电机 (42ZY68-2450 DC Motor)

减速比 Reduction ratio	3.7	5.2	14	19	27	51	71	100	115	139	181	219	254
减速级数 Number of gear trains	1	1	2	2	2	3	3	3	3	3	3	4	4
减速器长度(L) Length(L) mm	31.5	31.5	42.1	42.1	42.1	52.5	52.5	52.5	52.5	52.5	52.5	62.9	62.9
空载转速 No-load speed r/min	1348	965	357	263	185	98	70	50	43	36	28	23	20
额定转速 Rated speed r/min	1011	724	268	197	139	74	53	38	33	27	21	17	15
额定转矩 Rated torque N.m	0.27	0.37	0.91	1.2	1.8	3.0	4.2	5.8	7.1	8.6	10	10	10
最大瞬间允许负载 Max. permissible load in a short time N.m	3	3	12	12	12	25	25	25	25	25	30	30	30





## PM DC Planetary Gear Motor (Ring Gear Material: Metal and Powder Metal)

**42JXE100K/42ZY68P(1)**  $\Phi 42$  行星减速器, 允许转矩范围: 1N.m~10N.m  
42mm Planetary Gearbox  
Permissible Load Range: 1N.m~10N.m

Ring gear can be selected within the two materials: Powder metal (Type:42JXF100K), Metal (Type:42JXE100K)

### ● 外形和安装尺寸 Dimensions

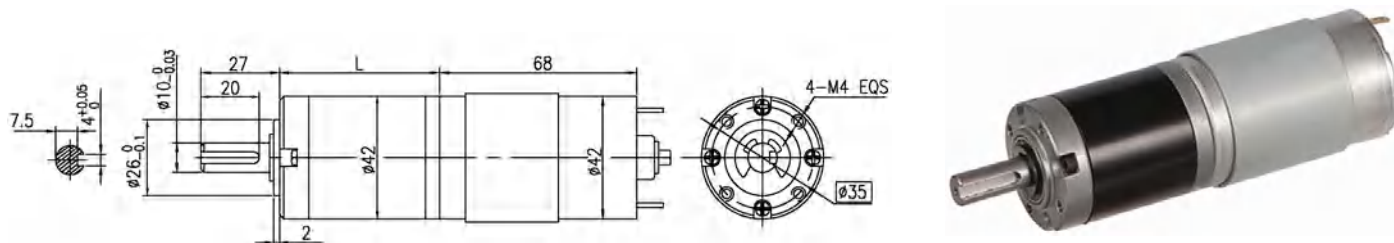

### ● 电动机主要技术参数 Motor Technical Data

电机型号 TYPE	额定电压 Rated voltage VDC	空载转速 No-load speed r/min	空载电流 No-load current A	额定转速 Rated speed r/min	额定转矩 Rated torque mN.m	输出功率 Output power W	额定电流 Rated current A	堵转力矩 Stall torque mN.m	堵转电流 Stall current A
42ZY68P-2430	24	3000	0.35	2250	66	16	1.2	200	3.1
42ZY68P-2440	24	4000	0.45	3000	85	27	2.1	250	5.0
42ZY68P-2450	24	5000	0.50	3750	115	45	3.1	305	8.0

### ● 齿轮减速电机主要技术参数 Gear Motor Technical Data

配置 42ZY68P-2430 直流电机 (42ZY68P-2430 DC Motor)

减速比 Reduction ratio	3.71	5.18	14	19	27	51	71	100	115	139	181	219	254	306	354
减速级数 Number of gear trains	1	1	2	2	2	3	3	3	3	3	4	4	4	4	4
减速器长度(L) Length(L) mm	31.5	31.5	42.1	42.1	42.1	52.5	52.5	52.5	52.5	52.5	62.9	62.9	62.9	62.9	62.9
空载转速 No-load speed r/min	809	579	214	158	111	59	42	30	26	22	17	14	11	9.8	8.5
额定转速 Rated speed r/min	606	434	161	118	83	44	32	23	20	16	12	10	8.9	7.4	6.4
额定转矩 Rated torque N.m	0.17	0.24	0.59	0.80	1.1	1.9	2.7	3.8	4.4	5.3	6.1	7.4	8.6	10	10
最大瞬间允许负载 Max. permissible load in a short time N.m	3	3	12	12	12	25	25	25	25	25	30	30	30	30	30

配置 42ZY68P-2440 直流电机 (42ZY68P-2440 DC Motor)

减速比 Reduction ratio	3.7	5.2	14	19	27	51	71	100	115	139	181	219	254
减速级数 Number of gear trains	1	1	2	2	2	3	3	3	3	3	4	4	4
减速器长度(L) Length(L) mm	31.5	31.5	42.1	42.1	42.1	52.5	52.5	52.5	52.5	52.5	62.9	62.9	62.9
空载转速 No-load speed r/min	1078	772	286	211	148	78	56	40	35	29	22	18	16
额定转速 Rated speed r/min	809	579	214	158	111	59	42	30	26	22	17	14	11
额定转矩 Rated torque N.m	0.31	0.43	1.0	1.4	2.0	3.4	4.8	6.7	7.7	9.3	10	10	10
最大瞬间允许负载 Max. permissible load in a short time N.m	3	3	12	12	12	25	25	25	25	25	30	30	30

配置 42ZY68P-2450 直流电机 (42ZY68P-2450 DC Motor)

减速比 Reduction ratio	3.7	5.2	14	19	27	51	71	100	115	139	181	219	254
减速级数 Number of gear trains	1	1	2	2	2	3	3	3	3	3	4	4	4
减速器长度(L) Length(L) mm	31.5	31.5	42.1	42.1	42.1	52.5	52.5	52.5	52.5	52.5	62.9	62.9	62.9
空载转速 No-load speed r/min	1348	965	357	263	185	98	70	50	43	36	28	23	20
额定转速 Rated speed r/min	1011	724	268	197	139	74	53	38	33	27	21	17	15
额定转矩 Rated torque N.m	0.38	0.54	1.3	1.8	2.5	4.3	6.0	8.4	9.7	10	10	10	10
最大瞬间允许负载 Max. permissible load in a short time N.m	3	3	12	12	12	25	25	25	25	30	30	30	30



PM DC Planetary Gear Motor (Ring Gear Material: Metal and Powder Metal)

**42JXE100K/42ZY68P(2)**

Φ42 行星减速器, 允许转矩范围: 1N.m~10N.m  
42mm Planetary Gearbox  
Permissible Load Range: 1N.m~10N.m

Ring gear can be selected within the two materials: Powder metal (Type:42JXF100K), Metal (Type:42JXE100K)

● 外形和安装尺寸 Dimensions

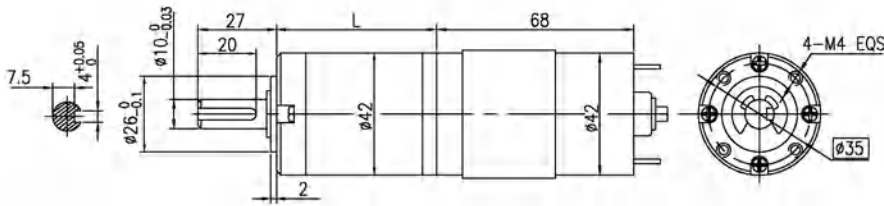

● 电动机主要技术参数 Motor Technical Data

电机型号 TYPE	额定电压 Rated voltage VDC	空载转速 No-load speed r/min	空载电流 No-load current A	额定转速 Rated speed r/min	额定转矩 Rated torque mN.m	输出功率 Output power W	额定电流 Rated current A	堵转力矩 Stall torque mN.m	堵转电流 Stall current A
42ZY68P-1270	12	7000	1.20	5200	88	47.9	6.7	310	20.5
42ZY68P-2470	24	7000	0.60	5200	120	65.3	4.2	320	10.8

● 齿轮减速电机主要技术参数 Gear Motor Technical Data

配置 42ZY68P-1270 直流电机 (42ZY68P-1270 DC Motor)

减速比 Reduction ratio	3.71	5.18	14	19	27	51	71	100	115	139	181	218	253	305
减速级数 Number of gear trains	1	1	2	2	2	3	3	3	3	3	4	4	4	4
减速器长度(L) Length(L) mm	31.5	31.5	42.1	42.1	42.1	52.5	52.5	52.5	52.5	52.5	62.9	62.9	62.9	62.9
空载转速 No-load speed r/min	1887	1351	500	368	259	137	99	70	61	50	39	32	28	23
额定转速 Rated speed r/min	1402	1004	371	274	193	102	73	52	45	37	29	24	21	17
额定转矩 Rated torque N.m	0.29	0.41	1.0	1.6	1.9	3.3	4.6	6.4	7.4	8.9	10	10	10	10
最大瞬间允许负载 Max. permissible load in a short time N.m	3	3	12	12	12	25	25	25	25	30	30	30	30	30

配置 42ZY68P-2470 直流电机 (42ZY68P-2470 DC Motor)

减速比 Reduction ratio	3.7	5.2	14	19	27	51	71	100	115	139	181	218	253	305
减速级数 Number of gear trains	1	1	2	2	2	3	3	3	3	3	4	4	4	4
减速器长度(L) Length(L) mm	31.5	31.5	42.1	42.1	42.1	52.5	52.5	52.5	52.5	52.5	62.9	62.9	62.9	62.9
空载转速 No-load speed r/min	1887	1351	500	368	259	137	99	70	61	50	39	32	28	23
额定转速 Rated speed r/min	1402	1004	371	274	193	102	73	52	45	37	29	24	21	17
额定转矩 Rated torque N.m	0.40	0.56	1.4	1.9	2.6	4.5	6.2	8.8	10	10	10	10	10	10
最大瞬间允许负载 Max. permissible load in a short time N.m	3	3	12	12	12	25	25	25	25	30	30	30	30	30



永磁直流行星齿轮电机 (内齿圈材质: 金属和粉末金属)

PM DC Planetary Gear Motor (Ring Gear Material: Metal and Powder Metal)

**42JXE100K/42ZY68P** Φ42 行星减速器, 允许转矩范围: 1N.m~10N.m  
42mm Planetary Gearbox  
Permissible Load Range: 1N.m~10N.m

可在两种材料的内齿圈中进行选择: 粉末金属 (型号 42JXF100K), 金属 (型号 42JXE100K)  
Ring gear can be selected within the two materials: Powder metal (Type:42JXF100K), Metal (Type:42JXE100K)

● 外形和安装尺寸 Dimensions

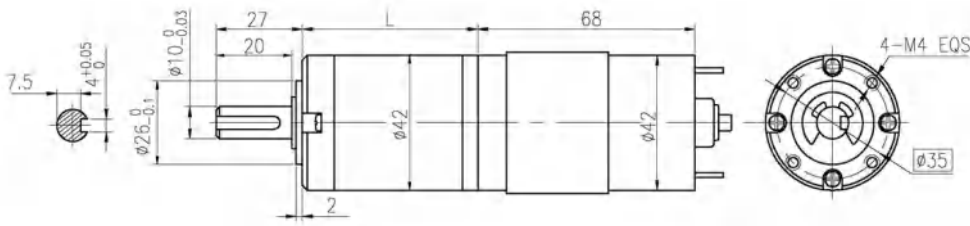

● 电动机主要技术参数 Motor Technical Data

电机型号 TYPE	额定电压 Rated voltage VDC	空载转速 No-load speed r/min	空载电流 No-load current A	额定转速 Rated speed r/min	额定转矩 Rated torque mN.m	输出功率 Output power W	额定电流 Rated current A	堵转力矩 Stall torque mN.m	堵转电流 Stall current A
42ZY68P-2420	24	2000	0.15	1700	50	8.7	0.6	220	2.0
42ZY68P-2430	24	3000	0.17	2200	40	9.0	1.0	150	2.3

● 齿轮减速电机主要技术参数 Gear Motor Technical Data

配置 42ZY68P-2420 直流电机 (42ZY68P-2420 DC Motor)

减速比 Reduction ratio	3.71	5.18	14	19	27	51	71	100	139	181	219	254	306	354
减速级数 Number of gear trains	1	1	2	2	2	3	3	3	3	4	4	4	4	4
减速器长度(L) Length(L) mm	31.5	31.5	42.1	42.1	42.1	52.5	52.5	52.5	52.5	62.9	62.9	62.9	62.9	62.9
空载转速 No-load speed r/min	539	386	143	105	74	39	28	20	14	11	7.9	6.5	5.6	4.7
额定转速 Rated speed r/min	458	328	121	89	63	33	24	17	12	9.4	6.7	5.6	4.8	4.0
额定转矩 Rated torque N.m	0.17	0.23	0.57	0.77	1.1	1.9	2.6	3.7	5.1	6.1	8.3	1.0	10	10
最大瞬间允许负载 Max. permissible load in a short time N.m	3	3	12	12	12	25	25	25	25	30	30	30	30	30

配置 42ZY68P-2430 直流电机 (42ZY68P-2430 DC Motor)

减速比 Reduction ratio	3.7	5.2	14	19	27	51	71	100	139	181	219	254	306	354	427
减速级数 Number of gear trains	1	1	2	2	2	3	3	3	3	4	4	4	4	4	4
减速器长度(L) Length(L) mm	31.5	31.5	42.1	42.1	42.1	52.5	52.5	52.5	52.5	62.9	62.9	62.9	62.9	62.9	62.9
空载转速 No-load speed r/min	809	579	214	158	111	59	42	30	22	16	14	12	10	8.5	7.0
额定转速 Rated speed r/min	593	425	157	116	81	43	31	22	16	12	10	8.7	7.2	6.2	5.2
额定转矩 Rated torque N.m	0.13	0.19	0.45	0.62	0.87	1.5	2.1	2.9	4.1	4.9	5.7	6.6	8.0	9.2	10
最大瞬间允许负载 Max. permissible load in a short time N.m	3	3	12	12	12	25	25	25	25	30	30	30	30	30	30

● 电动机特性图 Motor Characteristic Figure

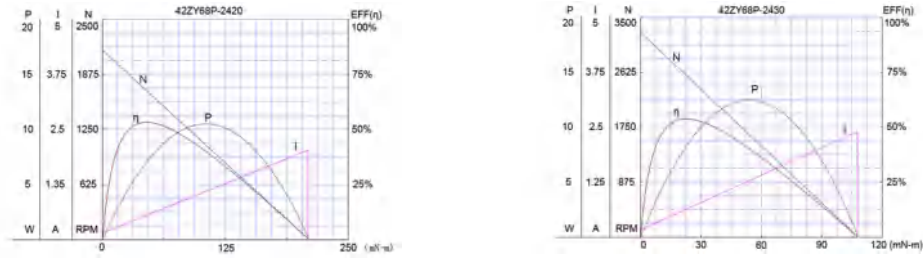



PM DC Planetary Gear Motor (Ring Gear Material: Metal and Powder Metal)

**42JXE100K/42ZY75**

Φ42 行星减速器, 允许转矩范围: 1N.m~10N.m  
42mm Planetary Gearbox  
Permissible Load Range: 1N.m~10N.m

Ring gear can be selected within the two materials: Powder metal (Type:42JXF100K), Metal (Type:42JXE100K)

● 外形和安装尺寸 Dimensions

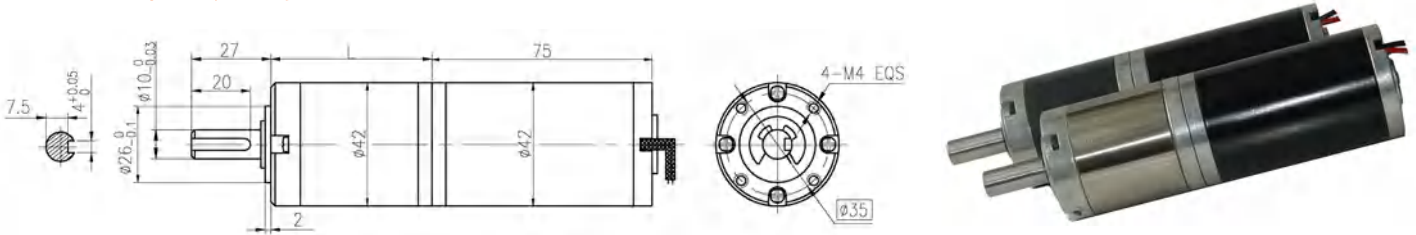

● 电动机主要技术参数 Motor Technical Data

电机型号 TYPE	额定电压 Rated voltage VDC	空载转速 No-load speed r/min	空载电流 No-load current A	额定转速 Rated speed r/min	额定转矩 Rated torque mN.m	输出功率 Output power W	额定电流 Rated current A	堵转力矩 Stall torque mN.m	堵转电流 Stall current A
42ZY75-2440	24	4000	0.20	3500	55	20	1.2	360	6.3

● 齿轮减速电机主要技术参数 Gear Motor Technical Data

配置 42ZY75-2440 直流电机 (42ZY75-2440DC Motor)

减速比 Reduction ratio	3.71	5.18	14	19	27	51	71	100	139	181	219	254	306	354
减速级数 Number of gear trains	1	1	2	2	2	3	3	3	3	4	4	4	4	4
减速器长度(L) Length(L) mm	31.5	31.5	42.1	42.1	42.1	52.5	52.5	52.5	52.5	62.9	62.9	62.9	62.9	62.9
空载转速 No-load speed r/min	1078	772	286	211	148	78	56	40	29	22	18	16	13	11
额定转速 Rated speed r/min	943	676	250	184	130	69	49	35	25	19	16	14	11	9.9
额定转矩 Rated torque N.m	0.18	0.26	0.62	0.85	1.2	2.1	2.9	4.0	5.6	6.5	7.8	9.1	10	10
最大瞬间允许负载 Max. permissible load in a short time N.m	3	3	12	12	12	25	25	25	25	30	30	30	30	30



永磁直流行星齿轮电机 (内齿圈材质: 金属和粉末金属)

PM DC Planetary Gear Motor (Ring Gear Material: Metal and Powder Metal)

42JXE100K/42ZY75

Φ42 行星减速器, 允许转矩范围: 1N.m~10N.m  
42mm Planetary Gearbox  
Permissible Load Range: 1N.m~10N.m

可在两种材料的内齿圈中进行选择: 粉末金属 (型号 42JXF100K), 金属 (型号 42JXE100K)  
Ring gear can be selected within the two materials: Powder metal (Type:42JXF100K), Metal (Type:42JXE100K)

● 外形和安装尺寸 Dimensions

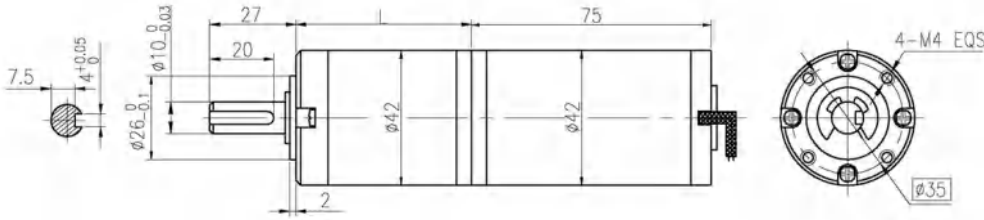

● 电动机主要技术参数 Motor Technical Data

电机型号 TYPE	额定电压 Rated voltage VDC	空载转速 No-load speed r/min	空载电流 No-load current A	额定转速 Rated speed r/min	额定转矩 Rated torque mN.m	输出功率 Output power W	额定电流 Rated current A	堵转转矩 Stall torque mN.m	堵转电流 Stall current A
42ZY75-2430	24	3000	0.15	2500	44	11.5	0.75	259	3.55
42ZY75-2440	24	4000	0.20	3500	55	20	1.2	360	6.3

● 齿轮减速电机主要技术参数 Gear Motor Technical Data

配置 42ZY75-2430 直流电机 (42ZY75-2430DC Motor)

减速比 Reduction ratio	3.71	5.18	14	19	27	51	71	100	139	181	219	254	306	354	427
减速级数 Number of gear trains	1	1	2	2	2	3	3	3	3	4	4	4	4	4	4
减速器长度(L) Length(L) mm	31.5	31.5	42.1	42.1	42.1	52.5	52.5	52.5	52.5	62.9	62.9	62.9	62.9	62.9	62.9
空载转速 No-load speed r/min	809	579	214	158	111	59	42	30	22	17	14	12	9.8	8.5	7.0
额定转速 Rated speed r/min	674	483	179	132	93	49	35	25	18	14	11	9.9	8.2	7.1	5.9
额定转矩 Rated torque N.m	0.15	0.21	0.50	0.68	0.96	1.6	2.3	3.2	4.5	5.2	6.3	7.3	8.8	10	10
最大瞬间允许负载 Max. permissible load in a short time N.m	3	3	12	12	12	25	25	25	25	30	30	30	30	30	30

配置 42ZY75-2440 直流电机 (42ZY75-2440DC Motor)

减速比 Reduction ratio	3.71	5.18	14	19	27	51	71	100	139	181	219	254	306	354
减速级数 Number of gear trains	1	1	2	2	2	3	3	3	3	4	4	4	4	4
减速器长度(L) Length(L) mm	31.5	31.5	42.1	42.1	42.1	52.5	52.5	52.5	52.5	62.9	62.9	62.9	62.9	62.9
空载转速 No-load speed r/min	1078	772	286	211	148	78	56	40	29	22	18	16	13	11
额定转速 Rated speed r/min	943	676	250	184	130	69	49	35	25	19	16	14	11	9.9
额定转矩 Rated torque N.m	0.18	0.26	0.62	0.85	1.2	2.1	2.9	4.0	5.6	6.5	7.8	9.1	10	10
最大瞬间允许负载 Max. permissible load in a short time N.m	3	3	12	12	12	25	25	25	25	30	30	30	30	30

● 电动机特性图 Motor Characteristic Figure

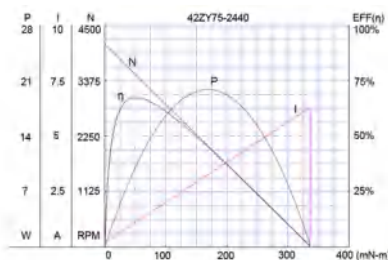
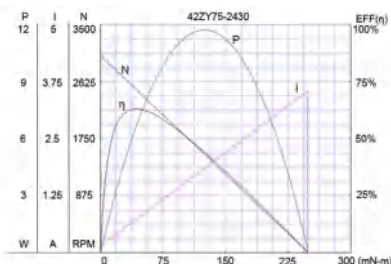





PM DC Planetary Gear Motor (Ring Gear Material: Metal and Powder Metal)

## 42JXE100K/42ZY85

Φ42 行星减速器, 允许转矩范围: 1N.m~10N.m  
42mm Planetary Gearbox  
Permissible Load Range: 1N.m~10N.m

Ring gear can be selected within the two materials: Powder metal (Type:42JXF100K), Metal (Type:42JXE100K)

### ● 外形和安装尺寸 Dimensions

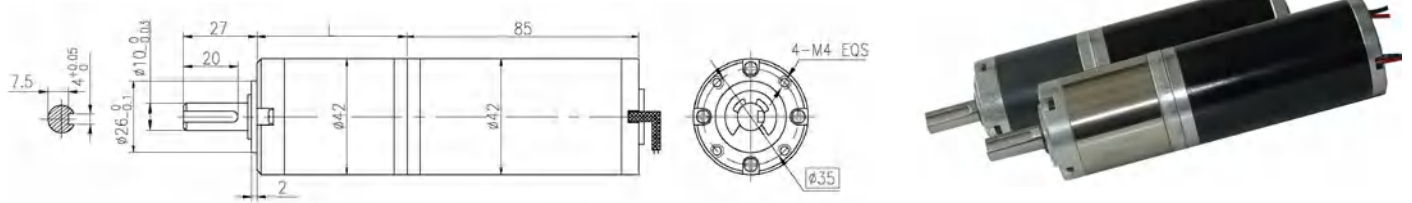

### ● 电动机主要技术参数 Motor Technical Data

电机型号 TYPE	额定电压 Rated voltage VDC	空载转速 No-load speed r/min	空载电流 No-load current A	额定转速 Rated speed r/min	额定转矩 Rated torque mN.m	输出功率 Output power W	额定电流 Rated current A	堵转力矩 Stall torque mN.m	堵转电流 Stall current A
42ZY85-2440	24	4000	0.45	3000	93	29	2.0	310	6.2

### ● 齿轮减速电机主要技术参数 Gear Motor Technical Data

配置 42ZY85-2440 直流电机 (42ZY75-2440DC Motor)

减速比 Reduction ratio	3.71	5.18	14	19	27	51	71	100	139	181	219	254
减速级数 Number of gear trains	1	1	2	2	2	3	3	3	3	4	4	4
减速器长度(L) Length(L) mm	31.5	31.5	42.1	42.1	42.1	52.5	52.5	52.5	52.5	62.9	62.9	62.9
空载转速 No-load speed r/min	1078	772	286	211	148	78	56	40	29	22	18	16
额定转速 Rated speed r/min	829	579	214	158	111	59	42	30	22	17	14	12
额定转矩 Rated torque N.m	0.31	0.43	1.1	1.4	2.0	3.5	4.8	6.8	9.4	10	10	10
最大瞬间允许负载 Max. permissible load in a short time N.m	3	3	12	12	12	25	25	25	25	30	30	30



PM DC Planetary Gear Motor (Ring Gear Material: Metal)

## 52JX300K/52ZY80

Φ52 行星减速器, 允许转矩范围: 2N.m~20N.m  
52mm Planetary Gearbox  
Permissible Load Range: 2N.m~20N.m

### ● 外形和安装尺寸 Dimensions

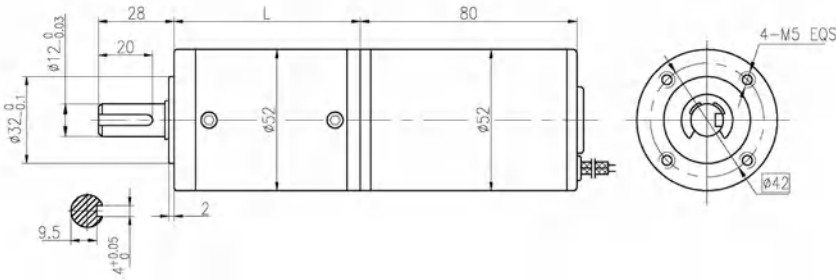

### ● 电动机主要技术参数 Motor Technical Data

电机型号 TYPE	额定电压 Rated voltage VDC	空载转速 No-load speed r/min	空载电流 No-load current A	额定转速 Rated speed r/min	额定转矩 Rated torque N.m	输出功率 Output power W	额定电流 Rated current A	堵转力矩 Stall torque N.m	堵转电流 Stall current A
52ZY80-2430	24	3000	0.35	2300	0.075	18	1.5	0.320	6.0
52ZY80-2440	24	4000	0.42	3200	0.080	27	2.0	0.446	7.5

### ● 齿轮减速电机主要技术参数 Gear Motor Technical Data

#### 配置 52ZY80-2430 直流电机 (52ZY80-2430 DC Motor)

减速比 Reduction ratio	3.60	4.25	13	15	18	47	55	65	77	168	198	234	276	326
减速级数 Number of gear trains	1	1	2	2	2	3	3	3	3	4	4	4	4	4
减速器长度(L) Length(L) mm	45.7	45.7	57.2	57.2	57.2	68.5	68.5	68.5	68.5	79.8	79.8	79.8	79.8	79.8
空载转速 No-load speed /min	833	706	231	200	167	64	55	46	39	18	15	13	11	9.2
额定转速 Rated speed r/min	639	541	177	153	128	49	42	35	30	14	12	9.8	8.3	7.1
额定转矩 Rated torque N.m	0.24	0.29	0.79	0.91	1.1	2.6	3.0	3.6	4.2	8.2	10	11	13	16
最大瞬间允许负载 Max. permissible load in a short time N.m	6	6	25	25	25	50	50	50	50	60	60	60	60	60

#### 配置 52ZY80-2440 直流电机 (52ZY80-2440 DC Motor)

减速比 Reduction ratio	3.60	4.25	13	15	18	47	55	65	77	168	198	234	276	326
减速级数 Number of gear trains	1	1	2	2	2	3	3	3	3	4	4	4	4	4
减速器长度(L) Length(L) mm	45.7	45.7	57.2	57.2	57.2	68.5	68.5	68.5	68.5	79.8	79.8	79.8	79.8	79.8
空载转速 No-load speed /min	1111	941	308	267	222	85	73	62	52	24	20	17	15	12
额定转速 Rated speed r/min	889	753	246	213	178	68	58	49	42	19	16	14	12	9.8
额定转矩 Rated torque N.m	0.26	0.31	0.84	1.0	1.2	2.7	3.2	3.8	4.5	8.7	10	12	14	17
最大瞬间允许负载 Max. permissible load in a short time N.m	6	6	25	25	25	50	50	50	50	60	60	60	60	60

永磁直流行星齿轮电机 (内齿圈材质: 金属)

PM DC Planetary Gear Motor (Ring Gear Material: Metal)

**52JX300K/52ZY80**      *Φ52 行星减速器, 允许转矩范围: 2N.m~20N.m*  
*52mm Planetary Gearbox*  
*Permissible Load Range: 2N.m~20N.m*

● 外形和安装尺寸 Dimensions

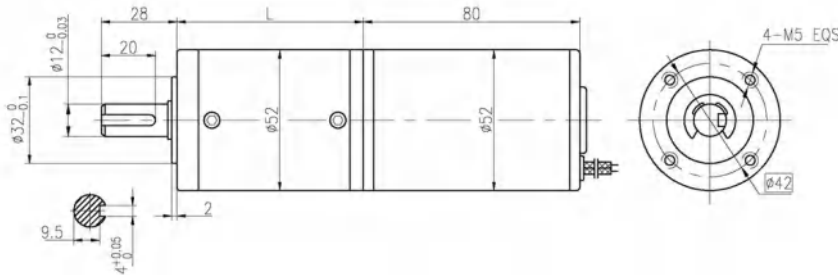

● 电动机主要技术参数 Motor Technical Data

电机型号 TYPE	额定电压 Rated voltage VDC	空载转速 No-load speed r/min	空载电流 No-load current A	额定转速 Rated speed r/min	额定转矩 Rated torque N.m	输出功率 Output power W	额定电流 Rated current A	堵转力矩 Stall torque N.m	堵转电流 Stall current A
52ZY80-2430	24	3000	0.35	2300	0.075	18	1.5	0.320	6.0
52ZY80-2440	24	4000	0.42	3200	0.080	27	2.0	0.446	7.5

● 齿轮减速电机主要技术参数 Gear Motor Technical Data

配置 52ZY80-2430 直流电机 (52ZY80-2430 DC Motor)

减速比 Reduction ratio	3.60	4.25	13	15	18	47	55	65	77	168	198	234	276	326
减速级数 Number of gear trains	1	1	2	2	2	3	3	3	3	4	4	4	4	4
减速器长度(L) Length(L) mm	45.7	45.7	57.2	57.2	57.2	68.5	68.5	68.5	68.5	79.8	79.8	79.8	79.8	79.8
空载转速 No-load speed /min	833	706	231	200	167	64	55	46	39	18	15	13	11	9.2
额定转速 Rated speed r/min	639	541	177	153	128	49	42	35	30	14	12	9.8	8.3	7.1
额定转矩 Rated torque N.m	0.24	0.29	0.79	0.91	1.1	2.6	3.0	3.6	4.2	8.2	10	11	13	16
最大瞬间允许负载 Max. permissible load in a short time N.m	6	6	25	25	25	50	50	50	50	60	60	60	60	60

配置 52ZY80-2440 直流电机 (52ZY80-2440 DC Motor)

减速比 Reduction ratio	3.60	4.25	13	15	18	47	55	65	77	168	198	234	276	326
减速级数 Number of gear trains	1	1	2	2	2	3	3	3	3	4	4	4	4	4
减速器长度(L) Length(L) mm	45.7	45.7	57.2	57.2	57.2	68.5	68.5	68.5	68.5	79.8	79.8	79.8	79.8	79.8
空载转速 No-load speed /min	1111	941	308	267	222	85	73	62	52	24	20	17	15	12
额定转速 Rated speed r/min	889	753	246	213	178	68	58	49	42	19	16	14	12	9.8
额定转矩 Rated torque N.m	0.26	0.31	0.84	1.0	1.2	2.7	3.2	3.8	4.5	8.7	10	12	14	17
最大瞬间允许负载 Max. permissible load in a short time N.m	6	6	25	25	25	50	50	50	50	60	60	60	60	60

● 电动机特性图 Motor Characteristic Figure

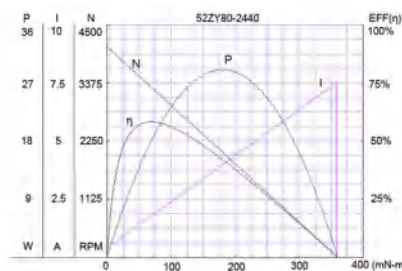
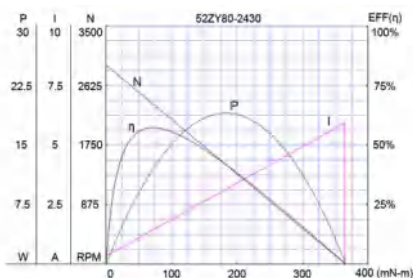

永磁直行星齿轮电机 (内齿圈材质: 金属)

PM DC Planetary Gear Motor (Ring Gear Material: Metal)

**52JX300K/52ZY95** Φ52 行星减速器, 允许转矩范围: 2N.m~30N.m  
52mm Planetary Gearbox  
Permissible Load Range: 2N.m~30N.m

● 外形和安装尺寸 Dimensions

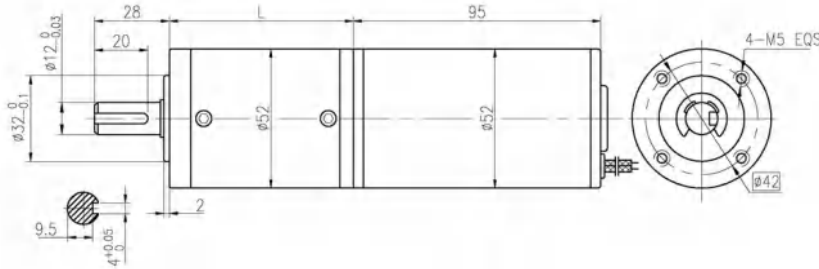

● 电动机主要技术参数 Motor Technical Data

电机型号 TYPE	额定电压 Rated voltage VDC	空载转速 No-load speed r/min	空载电流 No-load current A	额定转速 Rated speed r/min	额定转矩 Rated torque N.m	输出功率 Output power W	额定电流 Rated current A	堵转力矩 Stall torque N.m	堵转电流 Stall current A
52ZY95-2430	24	3000	0.45	2300	0.12	29	1.9	0.54	9.3
52ZY95-2440	24	4000	0.48	3400	0.11	39	2.7	0.73	12.3

● 齿轮减速电机主要技术参数 Gear Motor Technical Data

配置 52ZY95-2430 直流电机 (52ZY95-2430 DC Motor)

减速比 Reduction ratio	3.60	4.25	13	15	18	23	47	55	65	77	96	121	153	187	220	260	307	409
减速级数 Number of gear trains	1	1	2	2	2	2	3	3	3	3	3	3	4	4	4	4	4	4
减速器长度(L) Length(L) mm	45.7	45.7	57.2	57.2	57.2	57.2	68.5	68.5	68.5	68.5	68.5	68.5	79.8	79.8	79.8	79.8	79.8	79.8
空载转速 No-load speed r/min	833	706	231	200	167	130	64	55	46	39	31	25	20	16	14	12	9.8	7.3
额定转速 Rated speed r/min	639	541	177	153	128	100	49	42	35	30	24	19	15	12	11	8.8	7.5	5.6
额定转矩 Rated torque N.m	0.39	0.46	1.4	1.6	1.7	2.2	4.6	5.3	5.7	6.7	8.4	11	13	16	17	20	24	30
最大瞬间允许负载 Max. permissible load in a short time N.m	6	6	36	36	36	36	72	72	72	72	72	72	90	90	90	90	90	90

配置 52ZY95-2440 直流电机 (52ZY95-2440 DC Motor)

减速比 Reduction ratio	3.60	4.25	13	15	18	23	47	55	65	77	96	121	153	187	220	260	307	409
减速级数 Number of gear trains	1	1	2	2	2	2	3	3	3	3	3	3	4	4	4	4	4	4
减速器长度(L) Length(L) mm	45.7	45.7	57.2	57.2	57.2	57.2	68.5	68.5	68.5	68.5	68.5	68.5	79.8	79.8	79.8	79.8	79.8	79.8
空载转速 No-load speed r/min	1111	941	308	267	222	174	85	73	62	52	42	33	26	21	18	15	13	9.8
额定转速 Rated speed r/min	944	800	262	227	189	148	72	62	52	44	35	28	22	18	16	13	11	8.3
额定转矩 Rated torque N.m	0.36	0.42	1.3	1.5	1.6	2.0	4.2	4.9	5.2	6.2	7.7	9.7	12	15	16	19	22	29
最大瞬间允许负载 Max. permissible load in a short time N.m	6	6	36	36	36	36	72	72	72	72	72	72	90	90	90	90	90	90

● 电动机特性图 Motor Characteristic Figure

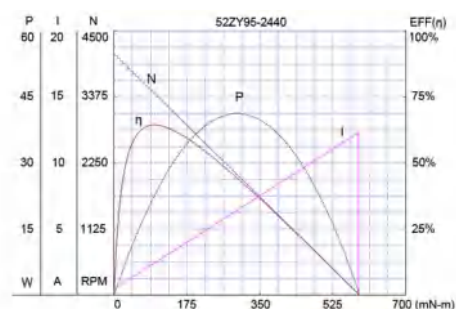
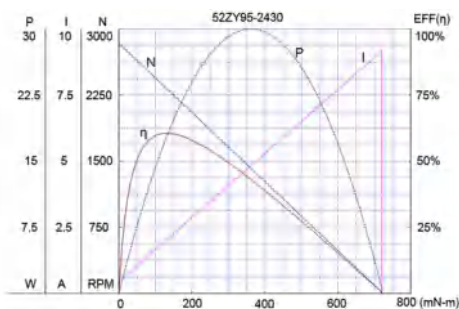

永磁直流行星齿轮电机 (内齿圈材质: 金属)

PM DC Planetary Gear Motor (Ring Gear Material: Metal)

**56JXE300K/52ZY95**       $\Phi 56$  行星减速器, 允许转矩范围: 2N.m~30N.m  
 56mm Planetary Gearbox  
 Permissible Load Range: 2N.m~30N.m

● 外形和安装尺寸 Dimensions

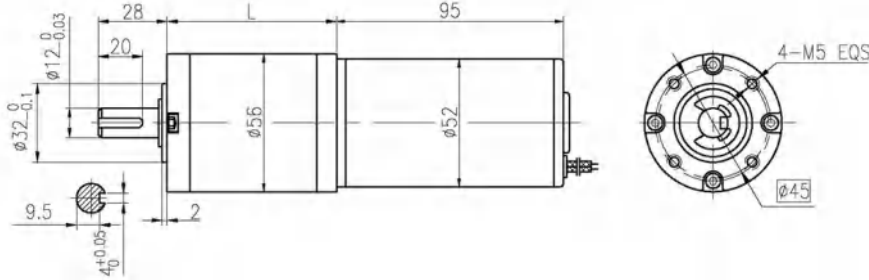

● 电动机主要技术参数 Motor Technical Data

电机型号 TYPE	额定电压 Rated voltage VDC	空载转速 No-load speed r/min	空载电流 No-load current A	额定转速 Rated speed r/min	额定转矩 Rated torque N.m	输出功率 Output power W	额定电流 Rated current A	堵转力矩 Stall torque N.m	堵转电流 Stall current A
52ZY95-2430	24	3000	0.45	2300	0.12	29	1.9	0.54	9.3
52ZY95-2440	24	4000	0.48	3400	0.11	39	2.7	0.73	12.3

● 齿轮减速电机主要技术参数 Gear Motor Technical Data

配置 52ZY95-2430 直流电机 (52ZY95-2430 DC Motor)

减速比	Reduction ratio	3.60	4.25	13	15	18	23	47	55	65	77	96	121	153	187	220	260	307	409
减速级数	Number of gear trains	1	1	2	2	2	2	3	3	3	3	3	3	4	4	4	4	4	4
减速器长度(L)	Length(L) mm	37.8	37.8	49.5	49.5	49.5	49.5	60.8	60.8	60.8	60.8	60.8	60.8	71.9	71.9	71.9	71.9	71.9	71.9
空载转速	No-load speed r/min	833	706	231	200	167	130	64	55	46	39	31	25	20	16	14	12	9.8	7.3
额定转速	Rated speed r/min	639	541	177	153	128	100	49	42	35	30	24	19	15	12	11	8.8	7.5	5.6
额定转矩	Rated torque N.m	0.39	0.46	1.4	1.6	1.7	2.2	4.6	5.3	5.7	6.7	8.4	11	13	16	17	20	24	30
最大瞬间允许负载 Max. permissible load in a short time	N.m	6	6	36	36	36	36	72	72	72	72	72	72	90	90	90	90	90	90

配置 52ZY95-2440 直流电机 (52ZY95-2440 DC Motor)

减速比	Reduction ratio	3.60	4.25	13	15	18	23	47	55	65	77	96	121	153	187	220	260	307	409
减速级数	Number of gear trains	1	1	2	2	2	2	3	3	3	3	3	3	4	4	4	4	4	4
减速器长度(L)	Length(L) mm	37.8	37.8	49.5	49.5	49.5	49.5	60.8	60.8	60.8	60.8	60.8	60.8	71.9	71.9	71.9	71.9	71.9	71.9
空载转速	No-load speed r/min	1111	914	308	267	222	174	85	73	62	52	42	33	26	21	18	15	13	9.8
额定转速	Rated speed r/min	944	800	262	227	189	148	72	62	52	44	35	28	22	18	16	13	11	8.3
额定转矩	Rated torque N.m	0.36	0.42	1.3	1.5	1.6	2.0	4.2	4.9	5.2	6.2	7.7	9.7	12	15	16	19	22	29
最大瞬间允许负载 Max. permissible load in a short time	N.m	6	6	36	36	36	36	72	72	72	72	72	72	90	90	90	90	90	90

● 电动机特性图 Motor Characteristic Figure

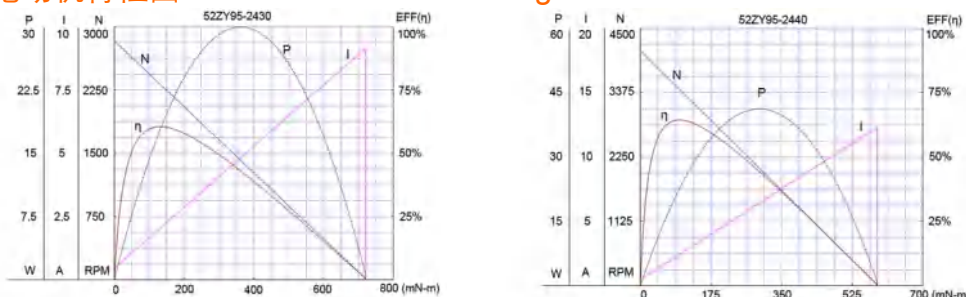



永磁直流行星齿轮电机 (内齿圈材质: 金属)

PM DC Planetary Gear Motor (Ring Gear Material: Metal)

## 60JXE300K/60ZY105

Φ60 行星减速器, 允许转矩范围: 2N.m~30N.m  
60mm Planetary Gearbox

Permissible Load Range: 2N.m~30N.m

### 外形和安装尺寸 Dimensions

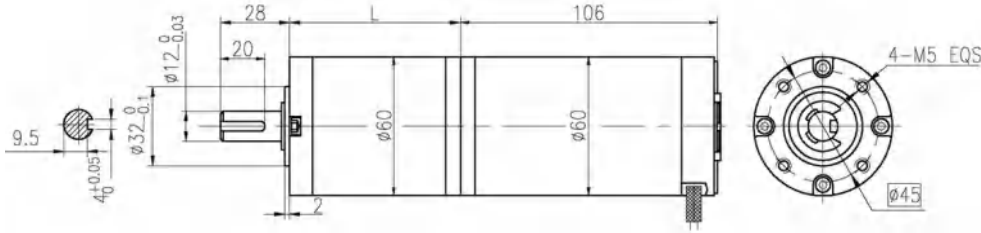

### 电动机主要技术参数 Motor Technical Data

电机型号 TYPE	额定电压 Rated voltage VDC	空载转速 No-load speed r/min	空载电流 No-load current A	额定转速 Rated speed r/min	额定转矩 Rated torque mN.m	输出功率 Output power W	额定电流 Rated current A	堵转转矩 Stall torque N.m	堵转电流 Stall current A
60ZY105-2420	24	2000	0.32	1550	125	20	1.6	0.55	6.0
60ZY105-2430	24	3000	0.40	2500	120	30	2.2	0.72	10.8

### 齿轮减速电机主要技术参数 Gear Motor Technical Data

配置 60ZY105-2420 直流电机 (60ZY105-2420 DC Motor)

减速比 Reduction ratio	3.6	4.25	13	15	18	23	47	55	65	77	96	121	153	187	220	260	307	409
减速级数 Number of gear trains	1	1	2	2	2	2	3	3	3	3	3	3	4	4	4	4	4	4
减速器长度(L) Length(L) mm	37.8	37.8	49.5	49.5	49.5	49.5	60.8	60.8	60.8	60.8	60.8	60.8	71.9	71.9	71.9	71.9	71.9	71.9
空载转速 No-load speed r/min	556	471	154	133	111	87	43	36	31	26	21	17	13	11	9.1	7.7	6.5	4.9
额定转速 Rated speed r/min	431	365	119	103	86	67	33	28	24	20	16	13	10	8.3	7.0	6.0	5.0	3.8
额定转矩 Rated torque N.m	0.41	0.48	1.5	1.7	1.8	2.3	4.8	5.6	5.9	7.0	8.8	11	14	17	18	21	25	30
最大瞬间允许负载 Max. permissible load in a short time N.m	6	6	36	36	36	36	72	72	72	72	72	72	90	90	90	90	90	90

配置 60ZY105-2430 直流电机 (60ZY105-2430 DC Motor)

减速比 Reduction ratio	3.6	4.25	13	15	18	23	47	55	65	77	96	121	153	187	220	260	307	409
减速级数 Number of gear trains	1	1	2	2	2	2	3	3	3	3	3	3	4	4	4	4	4	4
减速器长度(L) Length(L) mm	37.8	37.8	49.5	49.5	49.5	49.5	60.8	60.8	60.8	60.8	60.8	60.8	71.9	71.9	71.9	71.9	71.9	71.9
空载转速 No-load speed r/min	833	706	231	200	167	130	64	55	46	39	31	25	20	16	14	12	9.8	7.3
额定转速 Rated speed r/min	694	588	192	167	139	109	53	45	38	32	26	21	16	13	11	9.6	8.1	6.1
额定转矩 Rated torque N.m	0.39	0.46	1.3	1.5	1.7	2.2	4.1	4.8	5.7	6.7	8.4	11	12	15	17	20	24	30
最大瞬间允许负载 Max. permissible load in a short time N.m	6	6	36	36	36	36	72	72	72	72	72	72	90	90	90	90	90	90

### 电动机特性图 Motor Characteristic Figure

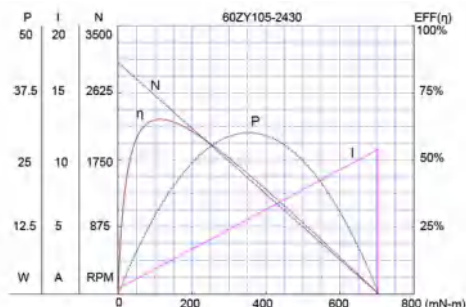
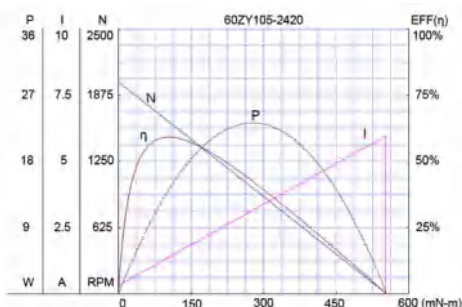



PM DC Planetary Gear Motor (Ring Gear Material: Metal)

**60JXE300K/64ZY110**

Φ60 行星减速器, 允许转矩范围: 2N.m~30N.m  
60mm Planetary Gearbox  
Permissible Load Range: 2N.m~30N.m

● 外形和安装尺寸 Dimensions

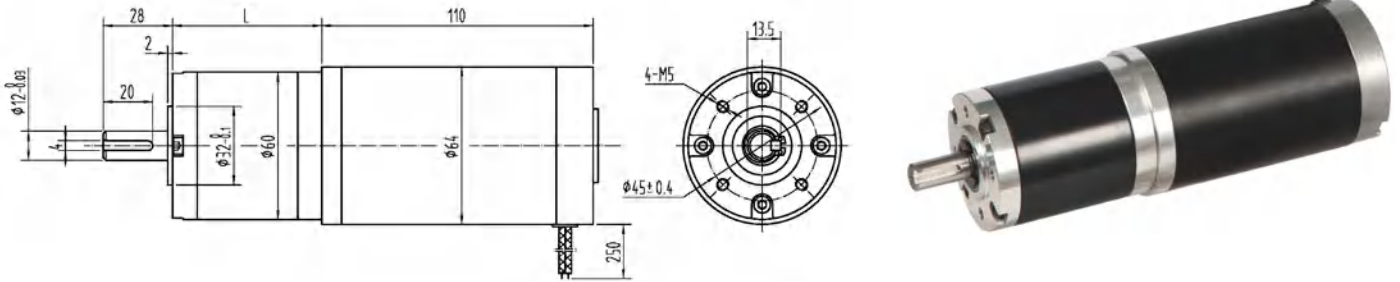

● 电动机主要技术参数 Motor Technical Data

电机型号 TYPE	额定电压 Rated voltage VDC	空载转速 No-load speed r/min	空载电流 No-load current A	额定转速 Rated speed r/min	额定转矩 Rated torque N.m	输出功率 Output power W	额定电流 Rated current A	堵转力矩 Stall torque N.m	堵转电流 Stall current A
64ZY110-2436	24	3600	0.70	2700	0.36	102	6.0	1.4	21

● 齿轮减速电机主要技术参数 Gear Motor Technical Data

配置 64ZY110-2436 直流电机 (64ZY110-2436 DC Motor)

减 速 比 Reduction ratio	3.6	4.25	13	15	18	23	47	55	65	77	96	121	153	187
减速级数 Number of gear trains	1	1	2	2	2	2	3	3	3	3	3	3	4	4
减速器长度(L) Length(L) mm	37.8	37.8	49.5	49.5	49.5	49.5	60.8	60.8	60.8	60.8	60.8	60.8	71.9	71.9
空载转速 No-load speed r/min	1000	847	277	240	200	157	77	65	55	47	38	30	24	19
额定转速 Rated speed r/min	750	635	208	180	150	117	57	49	42	35	28	22	18	14
额定转矩 Rated torque N.m	1.2	1.4	3.8	4.4	5.2	6.7	12	14	17	20	25	30	30	30
最大瞬间允许负载 Max. permissible load in a short time N.m	9	9	36	36	36	36	72	72	72	72	72	72	90	90

永磁直行星齿轮电机 (内齿圈材质: 金属)  
PM DC Planetary Gear Motor (Ring Gear Material: Metal)

60JXE300K/64ZY11  
0

Φ60 行星减速器, 允许转矩范围: 2N.m~30N.m  
60mm Planetary Gearbox  
Permissible Load Range: 2N.m~30N.m

● 外形和安装尺寸 Dimensions

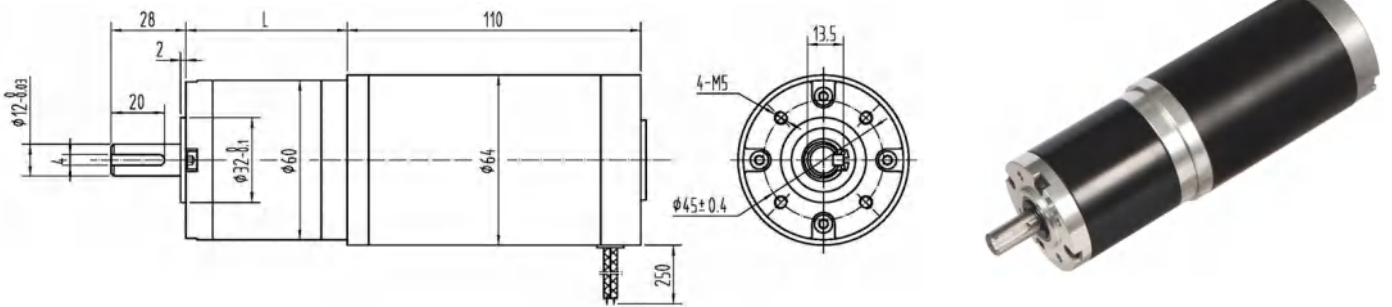

● 电动机主要技术参数 Motor Technical Data

电机型号 TYPE	额定电压 Rated voltage VDC	空载转速 No-load speed r/min	空载电流 No-load current A	额定转速 Rated speed r/min	额定转矩 Rated torque N.m	输出功率 Output power W	额定电流 Rated current A	堵转力矩 Stall torque N.m	堵转电流 Stall current A
64ZY110-2430	24	3000	0.45	2300	0.24	58	3.3	1.1	15

● 齿轮减速电机主要技术参数 Gear Motor Technical Data

配置 64ZY110-2430 直流电机 (64ZY110-2430 DC Motor)

减速比 Reduction ratio	3.6	4.25	13	15	18	23	47	55	65	77	96	121	153	187	220	260
减速级数 Number of gear trains	1	1	2	2	2	2	3	3	3	3	3	3	4	4	4	4
减速器长度(L) Length(L) mm	37.8	37.8	49.5	49.5	49.5	49.5	60.8	60.8	60.8	60.8	60.8	60.8	71.9	71.9	71.9	71.9
空载转速 No-load speed r/min	833	706	231	200	167	130	64	55	46	39	31	25	20	16	14	12
额定转速 Rated speed r/min	639	541	177	153	128	100	49	42	35	30	24	19	15	12	11	8.8
额定转矩 Rated torque N.m	0.78	0.92	2.5	2.9	3.5	4.5	8.2	9.6	11	14	17	21	24	29	30	30
最大瞬间允许负载 Max. permissible load in a short time N.m	9	9	36	36	36	36	72	72	72	72	72	72	90	90	90	90

● 电动机特性图 Motor Characteristic Figure

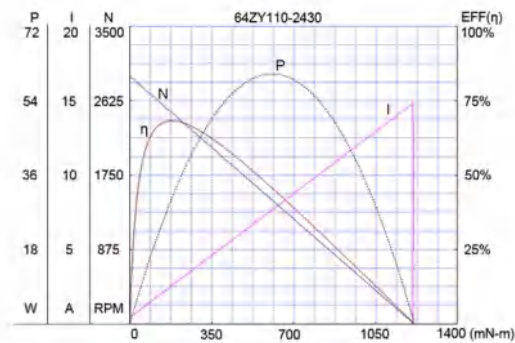

永磁直行星齿轮电机 (内齿圈材质: 金属)  
PM DC Planetary Gear Motor (Ring Gear Material: Metal)

**60JXE300K/78ZY112**       $\Phi 60$  行星减速器, 允许转矩范围: 2N.m~30N.m  
60mm Planetary Gearbox  
Permissible Load Range: 2N.m~30N.m

● 外形和安装尺寸 Dimensions

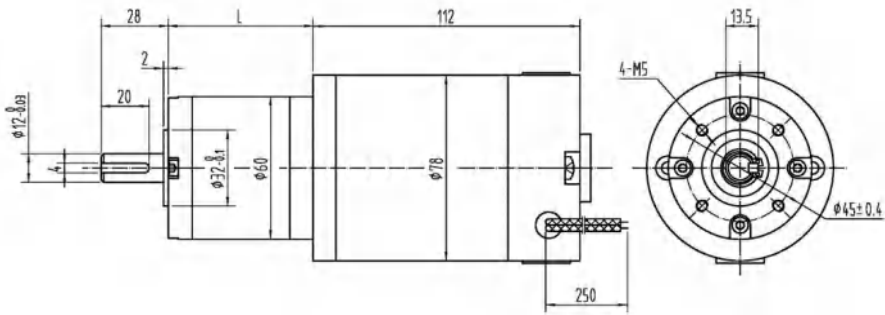

● 电动机主要技术参数 Motor Technical Data

电机型号 TYPE	额定电压 Rated voltage VDC	空载转速 No-load speed r/min	空载电流 No-load current A	额定转速 Rated speed r/min	额定转矩 Rated torque N.m	输出功率 Output power W	额定电流 Rated current A	堵转力矩 Stall torque N.m	堵转电流 Stall current A
78ZY112-2429	24	2900	0.55	2150	0.42	94	6.7	1.7	22

● 齿轮减速电机主要技术参数 Gear Motor Technical Data

配置 78ZY112-2429 直流电机 (78ZY112-2429 DC Motor)

减速比 Reduction ratio	3.6	4.25	13	15	18	23	47	55	65	77	96	121	153
减速级数 Number of gear trains	1	1	2	2	2	2	3	3	3	3	3	3	4
减速器长度(L) Length(L) mm	37.8	37.8	49.5	49.5	49.5	49.5	60.8	60.8	60.8	60.8	60.8	60.8	71.9
空载转速 No-load speed r/min	806	682	223	193	161	126	62	53	45	38	30	24	19
额定转速 Rated speed r/min	597	506	165	143	119	93	46	39	35	28	22	18	14
额定转矩 Rated torque N.m	1.4	1.6	4.4	5.1	6.1	7.8	14	17	20	24	29	30	30
最大瞬间允许负载 Max. permissible load in a short time N.m	9	9	36	36	36	36	72	72	72	72	72	72	90

● 电动机特性图 Motor Characteristic Figure

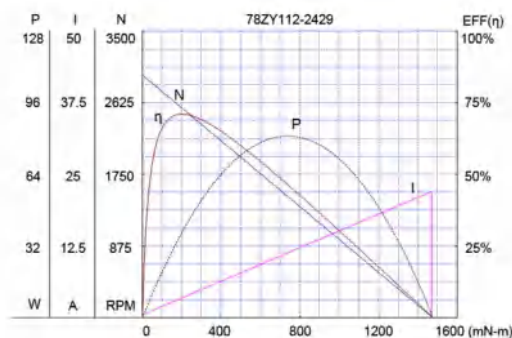



PM DC Planetary Gear Motor (Ring Gear Material: Metal)

## 60JX450K/63ZY125

Φ60 行星减速器, 允许转矩范围: 4N.m~45N.m  
60mm Planetary Gearbox  
Permissible Load Range: 4N.m~45N.m

### ● 外形和安装尺寸 Dimensions

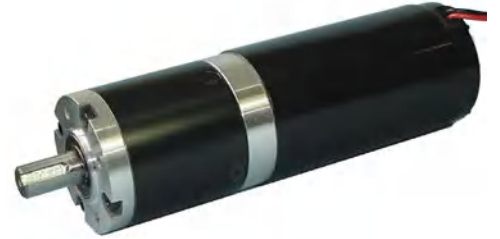
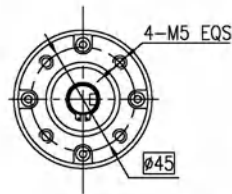
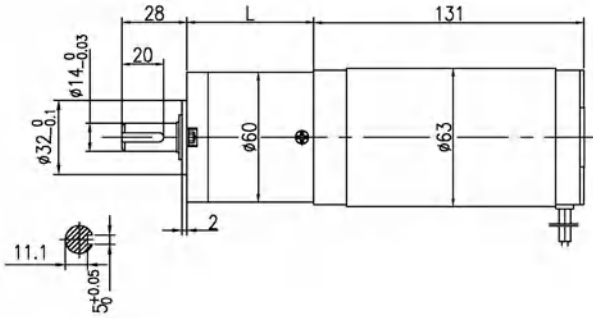

### ● 电动机主要技术参数 Motor Technical Data

电机型号 TYPE	额定电压 Rated voltage VDC	空载转速 No-load speed r/min	空载电流 No-load current A	额定转速 Rated speed r/min	额定转矩 Rated torque N.m	输出功率 Output power W	额定电流 Rated current A	堵转力矩 Stall torque N.m	堵转电流 Stall current A
63ZY125-2450	24	5000	1.2	4000	0.38	159	9.5	1.5	32

### ● 齿轮减速电机主要技术参数 Gear Motor Technical Data

配置 63ZY125-2450 直流电机 (63ZY125-2450 DC Motor)

减速比 Reduction ratio	3.6	4.25	13	15	18	23	28	43	52	61	72	96	121	154	187	220
减速级数 Number of gear trains	1	1	2	2	2	2	2	3	3	3	3	3	3	4	4	4
减速器长度(L) Length(L) mm	40.3	40.3	53.8	53.8	53.8	53.8	53.8	67.2	67.2	67.2	67.2	67.2	67.2	80.6	80.6	80.6
空载转速 No-load speed r/min	1389	1176	385	333	278	217	179	116	96	82	69	52	41	32	27	23
额定转速 Rated speed r/min	1111	941	308	267	222	174	143	93	77	66	56	42	33	26	21	18
额定转矩 Rated torque N.m	1.2	1.5	4.0	4.6	5.5	7.1	8.6	12	14	17	20	27	34	38	45	45
最大瞬间允许负载 Max. permissible load in a short time N.m	12	12	50	50	50	50	50	100	100	100	100	100	100	110	110	110





永磁直流行星齿轮(编码器)电机 (内齿圈材质: 金属)

PM DC PLANETARY GEAR MOTOR (Ring Gear Material: Metal)

**32JXE30K/28ZY47P**

Φ32 行星减速器, 允许转矩范围: 0.3N.m~3.0N.m  
32mm OD Planetary Gearbox,  
Permissible Load Range: 0.3N.m~3.0N.m



● 电动机主要技术参数 Motor Technical Data

电机型号 TYPE	额定电压 Rated voltage VDC	空载转速 No-load speed r/min	空载电流 No-load current mA	额定转速 Rated speed r/min	额定转矩 Rated torque mN.m	输出功率 Output power W	额定电流 Rated current mA	堵转力矩 Stall torque mN.m	堵转电流 Stall current A
28ZY47P-2460	24	6000	100	4500	17	8.0	470	65	1.8

电机型号中增加代号 P, 表示配置了屏蔽罩, 直径为 Φ28.9。 P - Shielding case, OD 28.9mm.

● 齿轮减速电机主要技术参数 Gear Motor Technical Data

配置 28ZY47P-2460 直流电机 (28ZY47P-2460 DC Motor)

减速比 Reduction ratio	3.7	5.2	14	19	27	51	71	100	139	181	218	253	305	354
减速级数 Number of gear trains	1	1	2	2	2	3	3	3	3	4	4	4	4	4
减速器长度(L) Length(L) mm	25.7	25.7	32.8	32.8	32.8	39.7	39.7	39.7	39.7	46.6	46.6	46.6	46.6	46.6
空载转速 No-load speed /min	1617	1158	429	316	222	118	85	60	43	33	28	24	20	17
额定转速 Rated speed r/min	1213	869	321	237	167	88	63	45	32	25	21	18	15	13
额定转矩 Rated torque N.m	0.06	0.08	0.19	0.26	0.37	0.63	0.88	1.2	1.7	2.0	2.4	2.8	3	3
最大瞬间允许负载 Max. permissible load in a short time N.m	1.0	1.0	3.5	3.5	3.5	7.5	7.5	7.5	7.5	9	9	9	9	9

● 外形和安装尺寸 Dimensions

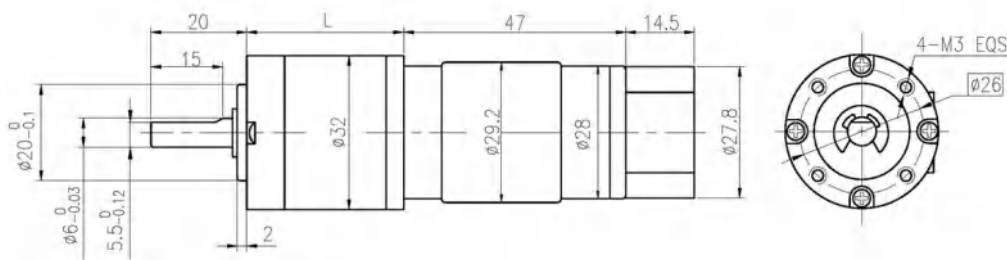

● 配置磁编码器 Magnetic Encoder

Model: CBM28-3 2channels, CW/CCW, 3PPR

Flat cable length 250mm



1. MOTOR-
2. MOTOR+
3. HALL SENSOR Vcc
4. HALL SENSOR GND
5. HALL SENSOR A Vout
6. HALL SENSOR B Vout



永磁直流行星齿轮(编码器)电机 (内齿圈材质: 金属)  
PM DC PLANETARY GEAR MOTOR (Ring Gear Material: Metal)

**32JXE30K/31ZY51G**

Φ32 行星减速器, 允许转矩范围: 0.3N.m~3.0N.m  
32mm OD Planetary Gearbox,  
Permissible Load Range: 0.3N.m~3.0N.m



● 电动机主要技术参数 Motor Technical Data

电机型号 TYPE	额定电压 Rated voltage VDC	空载转速 No-load speed r/min	空载电流 No-load current mA	额定转速 Rated speed r/min	额定转矩 Rated torque m. Nm	输出功率 Output power W	额定电流 Rated current mA	堵转力矩 Stall torque m. Nm	堵转电流 Stall current A
31ZY51G-2450	24	5000	75	3830	25	9.8	570	106.8	2.3

● 齿轮减速电机主要技术参数 Gear Motor Technical Data

配置 31ZY51G-2450 直流电机 (31ZY51G-2450 DC Motor)

减速比 Reduction ratio	3.7	5.2	14	19	27	51	71	100	139	181	219	254
减速级数 Number of gear trains	1	1	2	2	2	3	3	3	3	4	4	4
减速器长度(L) Length(L) mm	25.7	25.7	32.8	32.8	32.8	39.7	39.7	39.7	39.7	46.6	46.6	46.6
空载转速 No-load speed r/min	1351	962	357	263	185	98	70	50	36	28	23	20
额定转速 Rated speed r/min	1035	737	274	202	142	75	54	38	28	21	17	15
额定转矩 Rated torque N.m	0.083	0.117	0.284	0.385	0.547	0.929	1.294	1.823	2.533	2.969	3.592	4.166
最大瞬间允许负载 Max. permissible load in a short time N.m	1.0	1.0	3.5	3.5	3.5	7.5	7.5	7.5	7.5	9	9	9

● 外形和安装尺寸 Dimensions

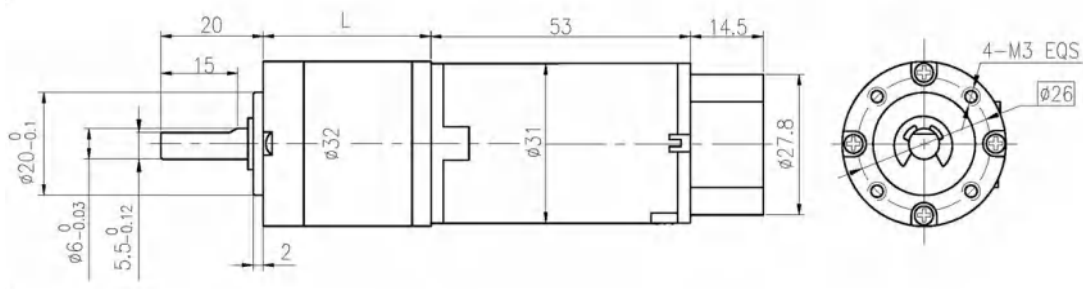

● 配置磁编码器 Magnetic Encoder

Model: CBM28-3 2channels, CW/CCW, 3PPR

Flat cable length 250mm



1. MOTOR-
2. MOTOR+
3. HALL SENSOR Vcc
4. HALL SENSOR GND
5. HALL SENSOR A Vout
6. HALL SENSOR B Vout



永磁直流行星齿轮(编码器)电机 (内齿圈材质: 金属和粉末金属)

PM DC PLANETARY GEAR MOTOR (Ring Gear Material: Metal and Powder Metal)

**36JXE30K/36ZY50**

Φ36 行星减速器, 允许转矩范围: 0.3N.m~3.0N.m  
36mm OD Planetary Gearbox,  
Permissible Load Range: 0.3N.m~3.0N.m

可在两种材料的内齿圈中进行选择: 粉末金属 (型号 36JXF30K), 金属 (型号 36JXE30K)  
Ring gear can be selected within the two materials: Powder metal (Type:36JXF30K), Metal (Type:36JXE30K)



● 电动机主要技术参数 Motor Technical Data

电机型号 TYPE	额定电压 Rated voltage VDC	空载转速 No-load speed r/min	空载电流 No-load current mA	额定转速 Rated speed r/min	额定转矩 Rated torque mN.m	输出功率 Output power W	额定电流 Rated current A	堵转力矩 Stall torque mN.m	堵转电流 Stall current A
36ZY50-2442	24	4200	120	3450	12	4.2	0.43	52	1.6

● 齿轮减速电机主要技术参数 Gear Motor Technical Data

配置 36ZY50-2442 直流电机 (36ZY50-2442 DC Motor)

减速比 Reduction ratio	3.7	5.2	14	19	27	51	71	100	139	181	218	253	305	354	426	495
减速级数 Number of gear trains	1	1	2	2	2	3	3	3	3	4	4	4	4	4	4	4
减速器长度(L) Length(L) mm	26.5	26.5	33.6	33.6	33.6	40.5	40.5	40.5	40.5	47.4	47.4	47.4	47.4	47.4	47.4	47.4
空载转速 No-load speed r/min	1132	811	300	221	156	82	59	42	30	23	19	17	14	12	10	8.5
额定转速 Rated speed r/min	930	666	246	182	128	68	49	35	25	19	16	14	11	9.7	8.1	7.0
额定转矩 Rated torque N.m	0.040	0.056	0.14	0.18	0.26	0.45	0.62	0.88	1.2	1.4	1.7	2.0	2.4	2.8	3	3
最大瞬间允许负载 Max. permissible load in a short time N.m	1.0	1.0	3.5	3.5	3.5	7.5	7.5	7.5	7.5	9	9	9	9	9	9	9

● 外形和安装尺寸 Dimensions

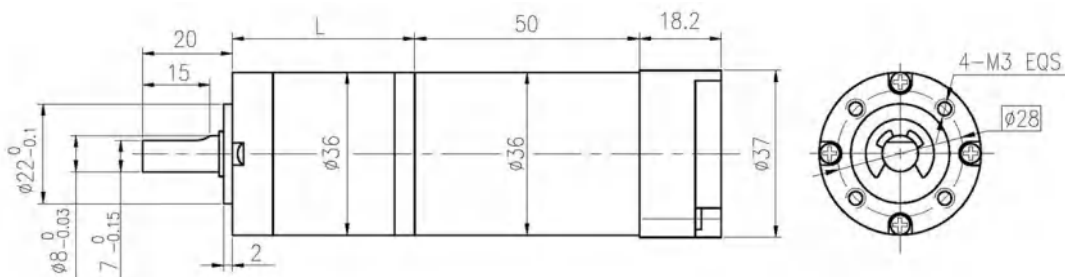

● 配置磁编码器 Magnetic Encoder

Model: CBM36-4 2channels, CW/CCW, 4PPR

Flat cable length 350mm

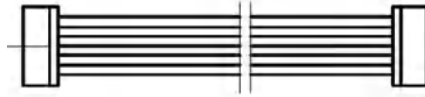
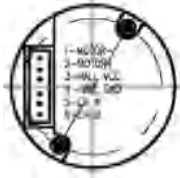

1. MOTOR-
2. MOTOR+
3. HALL SENSOR Vcc
4. HALL SENSOR GND
5. HALL SENSOR A Vout
6. HALL SENSOR B Vout



永磁直流行星齿轮(编码器)电机 (内齿圈材质: 金属和粉末金属)

PM DC PLANETARY GEAR MOTOR (Ring Gear Material: Metal and Powder Metal)

**36JXE30K/36ZY57**  $\Phi 36$  行星减速器, 允许转矩范围: 0.3N.m~3.0N.m  
 36mm OD Planetary Gearbox,  
 Permissible Load Range: 0.3N.m~3.0N.m

可在两种材料的内齿圈中进行选择: 粉末金属 (型号 36JXF30K), 金属 (型号 36JXE30K)  
 Ring gear can be selected within the two materials: Powder metal (Type:36JXF30K), Metal (Type:36JXE30K)



● 电动机主要技术参数 Motor Technical Data

电机型号 TYPE	额定电压 Rated voltage VDC	空载转速 No-load speed r/min	空载电流 No-load current mA	额定转速 Rated speed r/min	额定转矩 Rated torque mN.m	输出功率 Output power W	额定电流 Rated current A	堵转力矩 Stall torque mN.m	堵转电流 Stall current A
36ZY57-2442	24	4200	120	3600	19	7	0.52	97	2.8

● 齿轮减速电机主要技术参数 Gear Motor Technical Data

配置 36ZY57-2442 直流电机 (36ZY57-2442 DC Motor)

减速比 Reduction ratio	3.7	5.2	14	19	27	51	71	100	139	181	218	253	305	354
减速级数 Number of gear trains	1	1	2	2	2	3	3	3	3	4	4	4	4	4
减速器长度(L) Length(L) mm	26.5	26.5	33.6	33.6	33.6	40.5	40.5	40.5	40.5	47.4	47.4	47.4	47.4	47.4
空载转速 No-load speed r/min	1132	811	300	221	156	82	59	42	30	23	19	17	14	12
额定转速 Rated speed r/min	970	695	257	189	133	71	51	36	26	20	17	14	12	8.5
额定转矩 Rated torque N.m	0.063	0.089	0.22	0.29	0.42	0.71	0.98	1.4	1.9	2.2	2.7	3	3	3
最大瞬间允许负载 Max. permissible load in a short time N.m	1.0	1.0	3.5	3.5	3.5	7.5	7.5	7.5	7.5	9	9	9	9	9

● 外形和安装尺寸 Dimensions

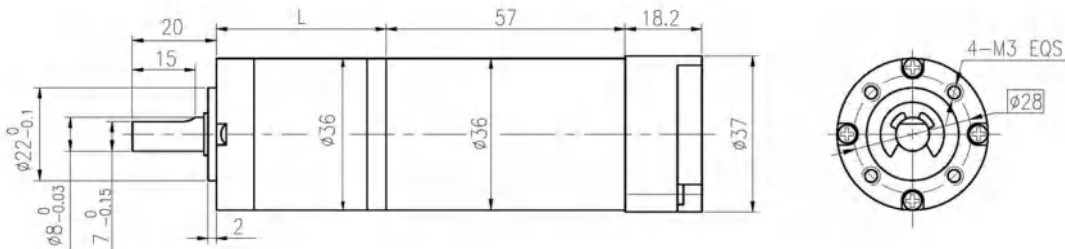

● 配置磁编码器 Magnetic Encoder

Model: CBM36-4 2channels, CW/CCW, 4PPR

Flat cable length 350mm

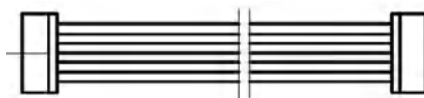
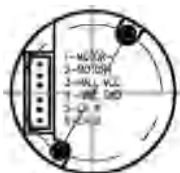

1. MOTOR-
2. MOTOR+
3. HALL SENSOR Vcc
4. HALL SENSOR GND
5. HALL SENSOR A Vout
6. HALL SENSOR B Vout





永磁直流行星齿轮(编码器)电机 (内齿圈材质: 金属和粉末金属)

PM DC PLANETARY GEAR MOTOR (Ring Gear Material: Metal and Powder Metal)

42JXE100K/42ZY68P

Φ42 行星减速器, 允许转矩范围: 1N.m~10N.m  
42mm Planetary Gearbox  
Permissible Load Range: 1N.m~10N.m

可在两种材料的内齿圈中进行选择: 粉末金属 (型号 42JXF100K), 金属 (型号 42JXE100K)  
Ring gear can be selected within the two materials: Powder metal (Type:42JXF100K), Metal (Type:42JXE100K)



● 电动机主要技术参数 Motor Technical Data

电机型号 TYPE	额定电压 Rated voltage VDC	空载转速 No-load speed r/min	空载电流 No-load current A	额定转速 Rated speed r/min	额定转矩 Rated torque mN.m	输出功率 Output power W	额定电流 Rated current A	堵转力矩 Stall torque mN.m	堵转电流 Stall current A
42ZY75-2440	24	4000	0.20	3500	55	20	1.2	360	6.3

● 齿轮减速电机主要技术参数 Gear Motor Technical Data

配置 42ZY75-2440 直流电机 (42ZY75-2440DC Motor)

减速比 Reduction ratio	3.71	5.18	14	19	27	51	71	100	139	181	218	253	305	354
减速级数 Number of gear trains	1	1	2	2	2	3	3	3	3	4	4	4	4	4
减速器长度(L) Length(L) mm	31.5	31.5	42.1	42.1	42.1	52.5	52.5	52.5	52.5	62.9	62.9	62.9	62.9	62.9
空载转速 No-load speed r/min	1078	772	286	211	148	78	56	40	29	22	18	16	13	11
额定转速 Rated speed r/min	943	676	250	184	130	69	49	35	25	19	16	14	11	9.9
额定转矩 Rated torque N.m	0.18	0.26	0.62	0.85	1.2	2.0	2.9	4.0	5.6	6.5	7.8	9.0	10	10
最大瞬间允许负载 Max. permissible load in a short time N.m	3	3	12	12	12	25	25	25	25	30	30	30	30	30

● 外形和安装尺寸 Dimensions

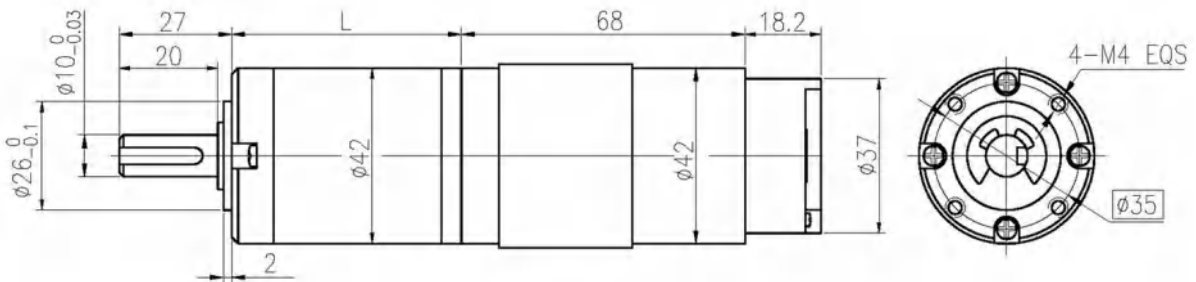

● 配置磁编码器 Magnetic Encoder

Model: CBM36-4 2channels, CW/CCW, 4PPR

Flat cable length 350mm

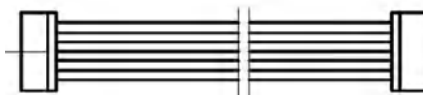
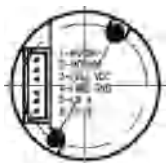

1. MOTOR-
2. MOTOR+
3. HALL SENSOR Vcc
4. HALL SENSOR GND
5. HALL SENSOR A Vout
6. HALL SENSOR B Vout



永磁直行星齿轮(编码器)电机 (内齿圈材质: 金属和粉末金属)

PM DC PLANETARY GEAR MOTOR (Ring Gear Material: Metal and Powder Metal)

**42JXE100K/42ZY75**

Φ42 行星减速器, 允许转矩范围: 1N.m~10N.m  
42mm Planetary Gearbox  
Permissible Load Range: 1N.m~10N.m

可在两种材料的内齿圈中进行选择: 粉末金属 (型号 42JXF100K), 金属 (型号 42JXE100K)  
Ring gear can be selected within the two materials: Powder metal (Type:42JXF100K), Metal (Type:42JXE100K)

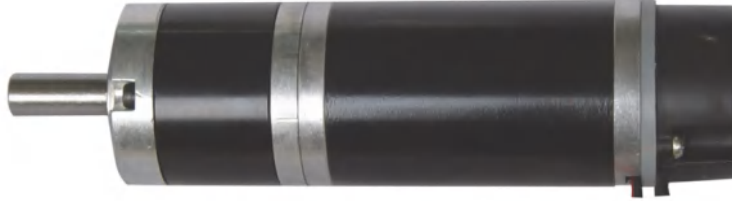

● 电动机主要技术参数 Motor Technical Data

电机型号 TYPE	额定电压 Rated voltage VDC	空载转速 No-load speed r/min	空载电流 No-load current A	额定转速 Rated speed r/min	额定转矩 Rated torque mN.m	输出功率 Output power W	额定电流 Rated current A	堵转力矩 Stall torque mN.m	堵转电流 Stall current A
42ZY75-2440	24	4000	0.20	3500	55	20	1.2	360	6.3

● 齿轮减速电机主要技术参数 Gear Motor Technical Data

配置 42ZY75-2440 直流电机 (42ZY75-2440DC Motor)

减速比 Reduction ratio	3.71	5.18	14	19	27	51	71	100	139	181	218	253	305	354
减速级数 Number of gear trains	1	1	2	2	2	3	3	3	3	4	4	4	4	4
减速器长度(L) Length(L) mm	31.5	31.5	42.1	42.1	42.1	52.5	52.5	52.5	52.5	62.9	62.9	62.9	62.9	62.9
空载转速 No-load speed r/min	1078	772	286	211	148	78	56	40	29	22	18	16	13	11
额定转速 Rated speed r/min	943	676	250	184	130	69	49	35	25	19	16	14	11	9.9
额定转矩 Rated torque N.m	0.18	0.26	0.62	0.85	1.2	2.0	2.9	4.0	5.6	6.5	7.8	9.0	10	10
最大瞬间允许负载 Max. permissible load in a short time N.m	3	3	12	12	12	25	25	25	25	30	30	30	30	30

● 外形和安装尺寸 Dimensions

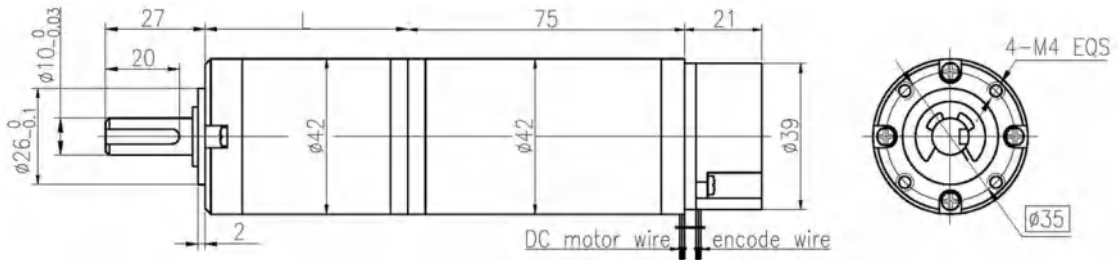

● 配置磁编码器 Magnetic Encoder

Model: CBM40-8 2channels, CW/CCW, 8PPR Flat cable length 350mm

Red: hall +5V, Black: hall GND, Green: hall U1, Blue: hall U2

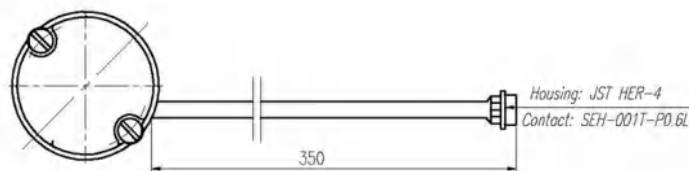

# 永磁直流齿轮减速电机 PM DC Spur Gear Motor

37JB6K/35ZY30

Φ37 标准型减速器, 允许转矩范围: 0.6N.m

37mm OD Standard Gearbox,

Permissible Load Range: 0.6N.m

## ● 外形和安装尺寸 Dimensions

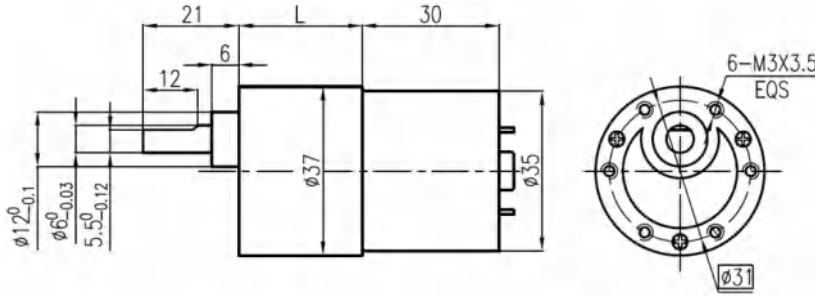

## ● 电动机主要技术参数 Motor Technical Data

电机型号 TYPE	额定电压 Rated voltage VDC	空载转速 No-load speed r/min	空载电流 No-load current mA	额定转速 Rated speed r/min	额定转矩 Rated torque mN.m	输出功率 Output power W	额定电流 Rated current mA	堵转转矩 Stall torque mN.m	堵转电流 Stall current A
35ZY30-1230	12	3000	60	2400	5	1.2	280	20	0.56
35ZY30-1250	12	5000	80	4300	4	1.8	330	24	1.20

## ● 齿轮减速电机主要技术参数 Gear Motor Technical Data

配置 35ZY30-1230 直流电机 (35ZY30-1230 DC Motor)

减 速 比	Reduction ratio	10	18	30	50	75	100	150	200	250	300	400	500	750	1000
减速级数	Number of gear trains	2	3	3	4	4	4	5	5	5	5	6	6	6	6
减速器长度(L)	Length(L) mm	19	21.5	21.5	24	24	24	26.5	26.5	26.5	26.5	29	29	29	29
空载转速	No-load speed r/min	300	167	100	60	40	30	20	15	12	10	7.5	6	4	3
额定转速	Rated speed r/min	240	133	80	48	32	24	16	12	10	9	7	5	3.2	2.4
额定转矩	Rated torque N.m	0.04	0.07	1.11	0.16	0.24	0.33	0.44	0.59	0.6	0.6	0.6	0.6	0.6	0.6
最大瞬间允许负载 Max. permissible load in a short time	N.m	0.3	0.6	0.6	1.2	1.2	1.2	1.8	1.8	1.8	1.8	1.8	1.8	1.8	1.8
转 向	Direction of rotation	CCW	CW	CW	CCW	CCW	CCW	CW	CW	CW	CW	CCW	CCW	CCW	CCW

配置 35ZY30-1250 直流电机 (35ZY30-1250 DC Motor)

减 速 比	Reduction ratio	10	18	30	50	75	100	150	200	250	300	400	500	750	1000
减速级数	Number of gear trains	2	3	3	4	4	4	5	5	5	5	6	6	6	6
减速器长度(L)	Length(L) mm	19	21.5	21.5	24	24	24	26.5	26.5	26.5	26.5	29	29	29	29
空载转速	No-load speed r/min	500	278	167	100	67	50	33	25	20	16	12	10	6.6	5.0
额定转速	Rated speed r/min	430	239	143	86	57	43	29	22	17	14	11.3	9.2	6.3	4.8
额定转矩	Rated torque N.m	0.04	0.05	0.10	0.16	0.22	0.29	0.44	0.58	0.6	0.6	0.6	0.6	0.6	0.6
最大瞬间允许负载 Max. permissible load in a short time	N.m	0.3	0.6	0.6	1.2	1.2	1.2	1.8	1.8	1.8	1.8	1.8	1.8	1.8	1.8
转 向	Direction of rotation	CCW	CW	CW	CCW	CCW	CCW	CW	CW	CW	CW	CCW	CCW	CCW	CCW

## ● 电动机特性图 Motor Characteristic Figure

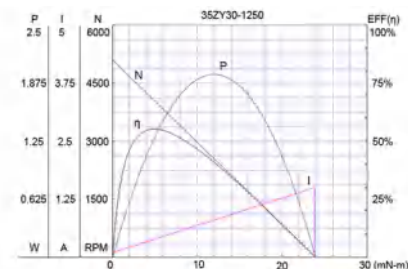
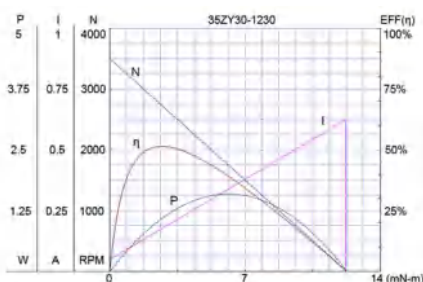

# 永磁直流齿轮减速电机 PM DC Spur Gear Motor

37JB6K/35ZY40

Φ37 标准型减速器, 允许转矩范围: 0.6N.m

37mm OD Standard Gearbox,

Permissible Load Range: 0.6N.m

## ● 外形和安装尺寸 Dimensions

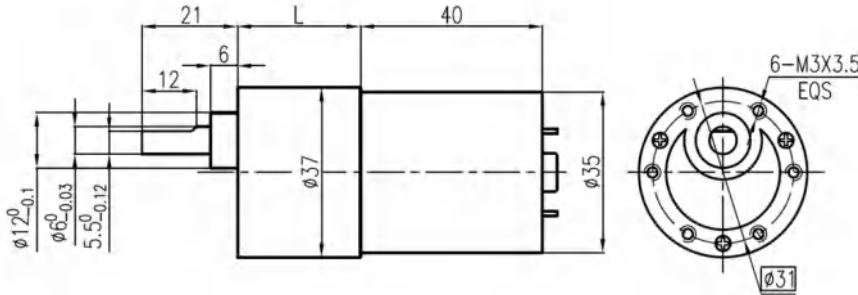

## ● 电动机主要技术参数 Motor Technical Data

电机型号 TYPE	额定电压 Rated voltage VDC	空载转速 No-load speed r/min	空载电流 No-load current mA	额定转速 Rated speed r/min	额定转矩 Rated torque mN.m	输出功率 Output power W	额定电流 Rated current mA	堵转转矩 Stall torque mN.m	堵转电流 Stall current A
35ZY40-1230	12	3000	80	2300	7	2.1	400	30	0.8
35ZY40-1250	12	5000	100	4100	8	3.5	570	46	2.2

## ● 齿轮减速电机主要技术参数 Gear Motor Technical Data

配置 35ZY40-1230 直流电机 (35ZY40-1230 DC Motor)

减速比 Reduction ratio	6	10	18	30	50	75	100	150	200	250	300
减速级数 Number of gear trains	2	2	3	3	4	4	4	5	5	5	5
减速器长度(L) Length(L) mm	19	19	21.5	21.5	24	24	24	26.5	26.5	26.5	26.5
空载转速 No-load speed r/min	500	300	167	100	60	40	30	20	15	12	10
额定转速 Rated speed r/min	383	230	128	77	46	31	23	16	12	10	8.5
额定转矩 Rated torque N.m	0.03	0.05	0.09	0.15	0.23	0.35	0.46	0.6	0.6	0.6	0.6
最大瞬间允许负载 Max. permissible load in a short time N.m	0.3	0.3	0.6	0.6	1.2	1.2	1.2	1.8	1.8	1.8	1.8
转 向 Direction of rotation	CCW	CCW	CW	CW	CCW	CCW	CCW	CW	CW	CW	CW

配置 35ZY40-1250 直流电机 (35ZY40-1250 DC Motor)

减速比 Reduction ratio	6	10	18	30	50	75	100	150	200	250	300
减速级数 Number of gear trains	2	2	3	3	4	4	4	5	5	5	5
减速器长度(L) Length(L) mm	19	19	21.5	21.5	24	24	24	26.5	26.5	26.5	26.5
空载转速 No-load speed r/min	833	500	278	167	100	67	50	33	25	20	17
额定转速 Rated speed r/min	683	410	228	137	82	55	41	28	23	18	16
额定转矩 Rated torque N.m	0.04	0.06	0.11	0.18	0.26	0.39	0.52	0.6	0.6	0.6	0.6
最大瞬间允许负载 Max. permissible load in a short time N.m	0.3	0.3	0.6	0.6	1.2	1.2	1.2	1.8	1.8	1.8	1.8
转 向 Direction of rotation	CCW	CCW	CW	CW	CCW	CCW	CCW	CW	CW	CW	CW

## ● 电动机特性图 Motor Characteristic Figure

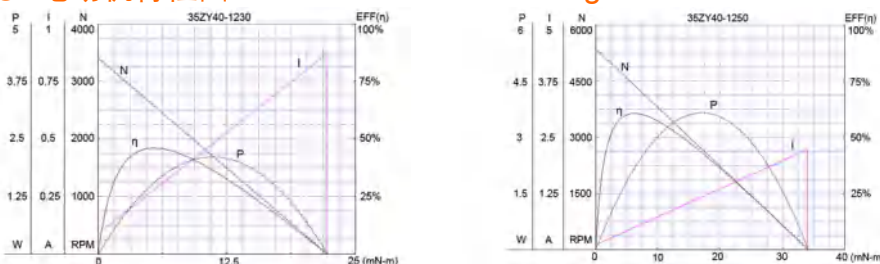

# 永磁直流齿轮减速电机 PM DC Spur Gear Motor

37JB6K/33ZY24

Φ37 标准型减速器, 允许转矩范围: 0.6N.m

37mm OD Standard Gearbox,

Permissible Load Range: 0.6N.m

## ● 外形和安装尺寸 Dimensions

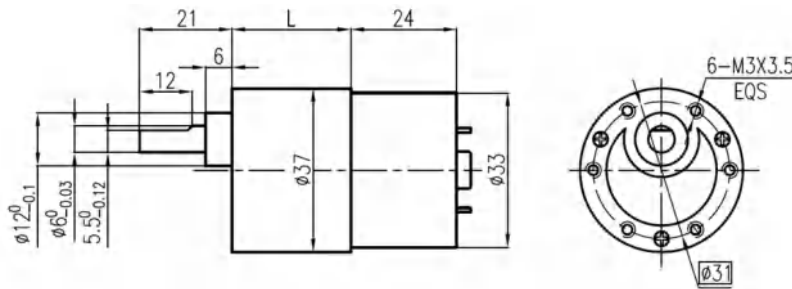

## ● 电动机主要技术参数 Motor Technical Data

电机型号 TYPE	额定电压 Rated voltage VDC	空载转速 No-load speed r/min	空载电流 No-load current mA	额定转速 Rated speed r/min	额定转矩 Rated torque mN.m	输出功率 Output power W	额定电流 Rated current mA	堵转转矩 Stall torque mN.m	堵转电流 Stall current A
33ZY24-1230	12	3000	40	2300	2.5	0.59	100	10	0.26
33ZY24-2430	24	3000	20	2300	2.5	0.59	80	10	0.14

## ● 齿轮减速电机主要技术参数 Gear motor Technical Data

配置 33ZY24-1230 直流电机 (33ZY24-1230 DC Motor)

减速比 Reduction ratio	18	30	50	75	100	150	200	250	300	400	500	750	1000	1500	3000
减速级数 Number of gear trains	3	3	4	4	4	5	5	5	5	6	6	6	6	7	7
减速器长度(L) Length(L) mm	21.5	21.5	24	24	24	26.5	26.5	26.5	26.5	29	29	29	29	31.5	31.5
空载转速 No-load speed r/min	161	97	58	39	29	19	15	12	10	7.3	5.8	3.9	2.9	1.9	1.0
额定转速 Rated speed r/min	122	73	44	29	22	15	11	8.8	7	5.5	4.5	3.1	2.4	1.7	0.8
额定转矩 Rated torque N.m	0.03	0.05	0.08	0.12	0.16	0.22	0.30	0.37	0.44	0.53	0.6	0.6	0.6	0.6	0.6
最大瞬间允许负载 Max. permissible load in a short time N.m	0.6	0.6	1.2	1.2	1.2	1.8	1.8	1.8	1.8	1.8	1.8	1.8	1.8	1.8	1.8
转向 Direction of rotation	CW	CW	CCW	CCW	CCW	CW	CW	CW	CW	CCW	CCW	CCW	CCW	CCW	CW

配置 33ZY24-2430 直流电机 (33ZY24-2430 DC Motor)

减速比 Reduction ratio	18	30	50	75	100	150	200	250	300	400	500	750	1000	1500	3000
减速级数 Number of gear trains	3	3	4	4	4	5	5	5	5	6	6	6	6	7	7
减速器长度(L) Length(L) mm	21.5	21.5	24	24	24	26.5	26.5	26.5	26.5	29	29	29	29	31.5	31.5
空载转速 No-load speed r/min	167	100	60	40	30	20	15	12	10	7.5	6	4	3	2	1
额定转速 Rated speed r/min	128	77	46	31	23	15	12	9.2	7.7	5.9	4.8	3.3	2.5	1.7	0.9
额定转矩 Rated torque N.m	0.04	0.06	0.10	0.14	0.18	0.27	0.37	0.41	0.49	0.6	0.6	0.6	0.6	0.6	0.6
最大瞬间允许负载 Max. permissible load in a short time N.m	0.6	0.6	1.2	1.2	1.2	1.8	1.8	1.8	1.8	1.8	1.8	1.8	1.8	1.8	1.8
转向 Direction of rotation	CW	CW	CCW	CCW	CCW	CW	CW	CW	CW	CCW	CCW	CCW	CCW	CCW	CW

## ● 电动机特性图 Motor Characteristic Figure

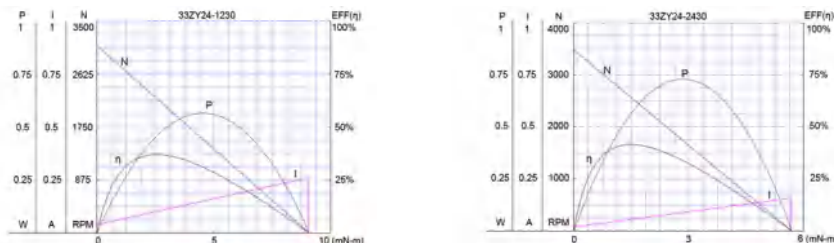



# 永磁直流齿轮减速电机 PM DC Spur Gear Motor

**37JBE10K/36ZY50** Φ37 加强型减速器, 允许转矩范围: 1.0N.m  
37mm OD Standard Gearbox,  
Permissible Load Range: 1.0N.m

## ● 外形和安装尺寸 Dimensions

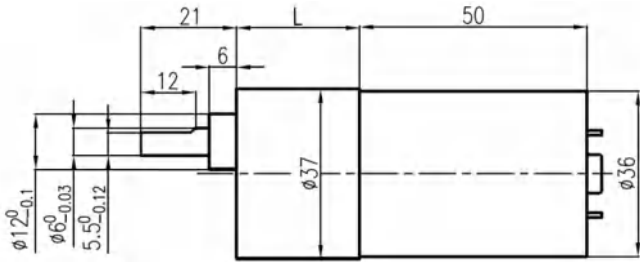

## ● 电动机主要技术参数 Motor Technical Data

电机型号 TYPE	额定电压 Rated voltage VDC	空载转速 No-load speed r/min	空载电流 No-load current mA	额定转速 Rated speed r/min	额定转矩 Rated torque mN.m	输出功率 Output power W	额定电流 Rated current A	堵转转矩 Stall torque mN.m	堵转电流 Stall current A
36ZY50-2436	24	3600	100	3000	11	3.4	0.40	58	1.7
36ZY50-2442	24	4200	120	3450	12	4.2	0.43	52	1.6

## ● 齿轮减速电机主要技术参数 Gear Motor Technical Data

配置 36ZY50-2436 直流电机 (36ZY50-2436 DC Motor)

减速比	Reduction ratio	6	10	18	30	50	75	100	150	200	250
减速级数	Number of gear trains	2	2	3	3	4	4	4	5	5	5
减速器长度(L)	Length(L)	mm	21.5	21.5	26.5	26.5	29	29	31.5	31.5	31.5
空载转速	No-load speed	r/min	600	360	200	120	72	48	36	24	18
额定转速	Rated speed	r/min	500	300	167	100	60	40	30	20	15
额定转矩	Rated torque	N.m	0.06	0.09	0.14	0.24	0.40	0.50	0.67	1	1
最大瞬间允许负载 Max. permissible load in a short time	N.m	0.5	0.5	1	1	2	2	2	3	3	3
转 向	Direction of rotation	CCW	CCW	CW	CW	CCW	CCW	CCW	CW	CW	CW

配置 36ZY50-2442 直流电机 (36ZY50-2442 DC Motor)

减速比	Reduction ratio	6	10	18	30	50	75	100	150	200	250
减速级数	Number of gear trains	2	2	3	3	4	4	4	5	5	5
减速器长度(L)	Length(L)	mm	21.5	21.5	26.5	26.5	29	29	31.5	31.5	31.5
空载转速	No-load speed	r/min	700	420	233	140	84	56	42	28	21
额定转速	Rated speed	r/min	583	350	194	117	70	47	35	23	18
额定转矩	Rated torque	N.m	0.06	0.10	0.16	0.26	0.42	0.55	0.73	1	1
最大瞬间允许负载 Max. permissible load in a short time	N.m	0.5	0.5	1	1	2	2	2	3	3	3
转 向	Direction of rotation	CCW	CCW	CW	CW	CCW	CCW	CCW	CW	CW	CW

## ● 电动机特性图 Motor Characteristic Figure

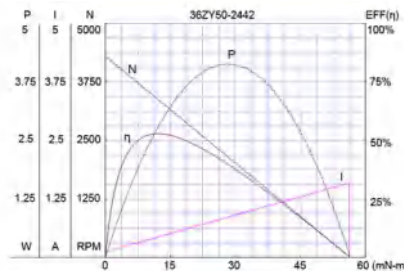
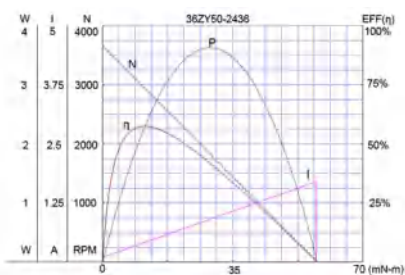

# 永磁直流齿轮减速电机 PM DC Spur Gear Motor

37JBE10K/36ZY57

Φ37 加强型减速器, 允许转矩范围: 1.0N.m  
 37mm OD Standard Gearbox,  
 Permissible Load Range: 1.0N.m

## ● 外形和安装尺寸 Dimensions

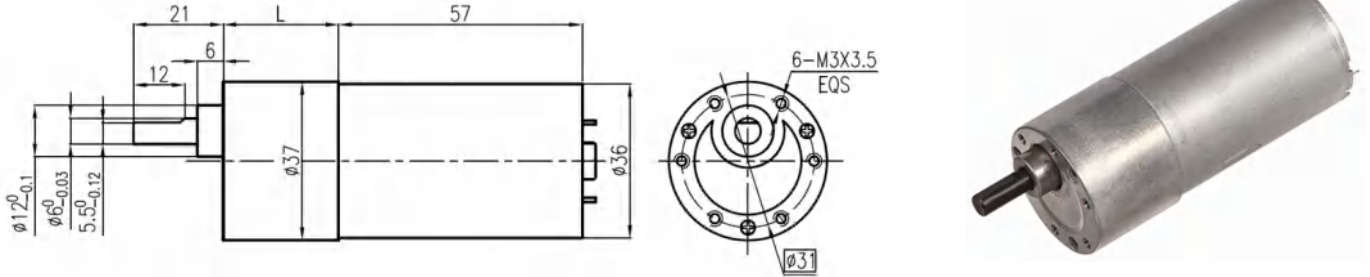

## ● 电动机主要技术参数 Motor Technical Data

电机型号 TYPE	额定电压 Rated voltage VDC	空载转速 No-load speed r/min	空载电流 No-load current mA	额定转速 Rated speed r/min	额定转矩 Rated torque mN.m	输出功率 Output power W	额定电流 Rated current A	堵转转矩 Stall torque mN.m	堵转电流 Stall current A
36ZY57-2436	24	3600	120	3000	17	5	0.50	89	2.0
36ZY57-2442	24	4200	120	3600	19	7	0.52	97	2.7

## ● 齿轮减速电机主要技术参数 Gear Motor Technical Data

配置 36ZY57-2436 直流电机 (36ZY57-2436 DC Motor)

减速比	Reduction ratio	6	10	18	30	50	75	100	150
减速级数	Number of gear trains	2	2	3	3	4	4	4	5
减速器长度(L)	Length(L) mm	21.5	21.5	26.5	26.5	29	29	29	31.5
空载转速	No-load speed r/min	600	360	200	120	72	48	36	24
额定转速	Rated speed r/min	500	300	167	100	60	40	30	20
额定转矩	Rated torque N.m	0.09	0.14	0.22	0.37	0.61	0.78	1	1
最大瞬间允许负载 Max. permissible load in a short time	N.m	0.5	0.5	1	1	2	2	2	3
转 向	Direction of rotation	CCW	CCW	CW	CW	CCW	CCW	CCW	CW

配置 36ZY57-2442 直流电机 (36ZY57-2442 DC Motor)

减速比	Reduction ratio	6	10	18	30	50	75	100	150
减速级数	Number of gear trains	2	2	3	3	4	4	4	5
减速器长度(L)	Length(L) mm	21.5	21.5	26.5	26.5	29	29	29	31.5
空载转速	No-load speed r/min	700	420	233	140	84	56	42	28
额定转速	Rated speed r/min	600	360	200	120	72	48	36	24
额定转矩	Rated torque N.m	0.10	0.16	0.25	0.41	0.68	0.87	1	1
最大瞬间允许负载 Max. permissible load in a short time	N.m	0.5	0.5	1	1	2	2	2	3
转 向	Direction of rotation	CCW	CCW	CW	CW	CCW	CCW	CCW	CW

## ● 电动机特性图 Motor Characteristic Figure

